

OREGON INVENTORY OF HISTORIC PROPERTIES
HISTORIC RESOURCE INVENTORY FORM

HISTORIC NAME: A.E. Davis Residence

DATE OF CONSTRUCTION: c. 1885

COMMON NAME: _____

ORIGINAL USE: Residence

ADDRESS: 702 Fourth Avenue

PRESENT USE: Residence

OWNER: John & Emma Renner, 702 Fourth Avenue

ARCH./BLDR.: Unknown

STYLE: Vernacular

T/R/S: 3-1E-1AA TAX LOT: 2600

BLDG. STRUC. DIST. SITE OBJ. (CIRCLE)

ADDITION: Plat of Canemah

THEME: Architecture, 19th Century

LOT: 1 BLOCK: 13 QUAD: Oregon City

PLAN TYPE/SHAPE: Rectangular with rear extension

NO. OF STORIES: 2

FOUNDATION MATERIAL: Wood

BASEMENT (Y/N): No

ROOF FORM & MATERIALS: Gable roof. Composition.

WALL CONSTRUCTION: Wood

STRUCTURAL FRAME: Stud

PRIMARY WINDOW TYPE: Some four-over-four windows. Some one-over-one windows.

SURFACING MATERIALS: Asbestos shingles.

DECORATIVE FEATURES: Pent-roof has square posts with decorative capitals and engaged

OTHER: pilasters at the house. One-story extension at rear.

CONDITION: EXCELLENT _____ GOOD _____ FAIR X DETERIORATED _____ MOVED _____ (date)

EXTERIOR ALTERATIONS/ADDITIONS (dated): Many four-over-four windows replaced with 1/1 panes, n.d. Asbestos shingles cover original siding, n.d. One-story extension at rear.

NOTEWORTHY LANDSCAPE FEATURES: None.

ASSOCIATED STRUCTURES: Shed.

KNOWN ARCHAEOLOGICAL FEATURES: None.

GEOGRAPHIC SETTING: Occupies a corner lot, which is a half-block in size, bounded by Fourth Avenue and unbuilt Fifth Avenue, unbuilt Apperson Street, and an unimproved alley. Also on this block is a vacant-quarter-block lot, and one residence.

STATEMENT OF SIGNIFICANCE: (Historical and/or architectural importance, dates, events, persons, contexts): A.E. Davis was an agent for the Oregon City Mills in the late 1880's. Despite alterations, this house retains its basic 1880's appearance, including the original porch and porch posts. It is significant for its age and its association with A.E. Davis, who, because of his position in the Mills, was an important person in Canemah. In the NR District, it is classified as a Primary structure.

SOURCES: Oregon Gazetteer, 1888. Sanborn Insurance Map, 1900, 1911, 1925. Clackamas County Tax Rolls, 1901. Pioneer National Title Company Records, Oregon City.

NEGATIVE NO: IV-A-15, 16

SLIDE NO: _____

RECORDED BY: Patricia Erigero

DATE: 1983

SHPO INVENTORY NO.: _____

OREGON INVENTORY OF HISTORIC PROPERTIES
HISTORIC RESOURCE INVENTORY FORM - TWO

NAME: A.E. Davis Residence

T/R/S: 3-1E-1AA TAX LOT 2600

ADDRESS: 702 Fourth Avenue

QUADRANGLE: Oregon City



NEGATIVE NO. IV-A-15, 16

SLIDE NO. _____

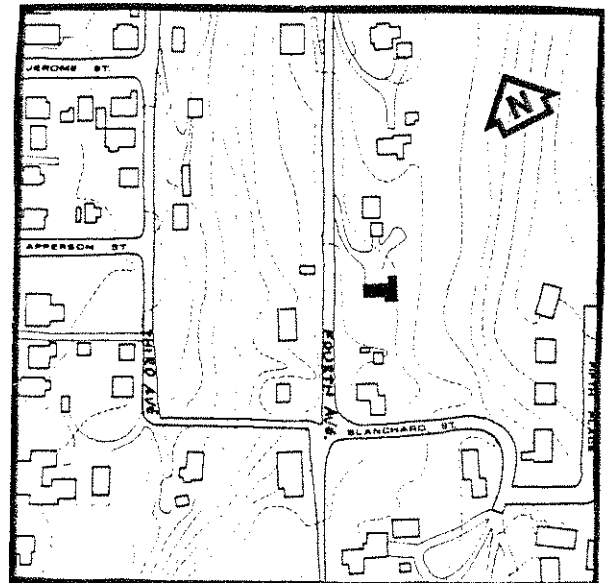
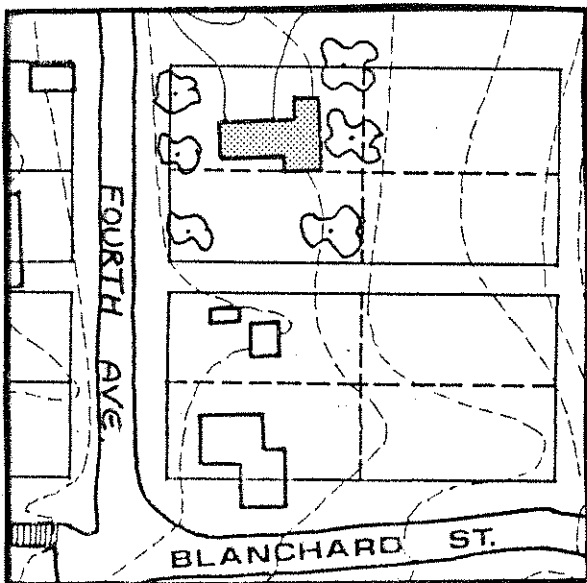

GRAPHIC AND PHOTO SOURCES: Base Map of Canemah. Oregon City Planning Department
Photograph, 1988.

SHPO INVENTORY NO.: _____

Oregon Historic Site Form

Davis, A E, House
702 4th Ave
Oregon City, Clackamas County

LOCATION AND PROPERTY NAME

address: 702 4th Ave ☐ apprx. addr

Oregon City ☐ vcnt Clackamas County

Optional Information

assoc addresses:
(former addresses, intersections, etc.)

location descr:
(remote sites)

historic name: Davis, A E, House

current/
other names:

block nbr: lot nbr: tax lot nbr:
township: 3S range: 1E section: 1 1/4:
zip:

PROPERTY CHARACTERISTICS

resource type: Building height (# stories): 1.5

elig. evaluation: eligible/contributing

primary constr date: 1885 (c.) ☒ secondary date: (c.) ☐
(optional--use for major addns)

primary orig use: Single Dwelling

secondary orig use:

primary style: MID-19TH & LATE VIC.: Other

secondary style:

primary siding: Horizontal Board

secondary siding:

plan type: Side Passage/Entry

total # eligible resources: 1 total # ineligible resources: 1

NR status: Listed in Historic District

NR date listed: (indiv listed only; see
Grouping for hist dist)

orig use comments:

prim style comments:

sec style comments:

siding comments:

architect:

builder:

comments/notes: 1 NC secondary building; Historic addition

GROUPINGS / ASSOCIATIONS

survey project name or other

Canemah Historic District

Listed Historic District

grouping name Canemah Historic District RLS Survey Update 2007

Survey & Inventory Project

farmstead/cluster name:

external site #:
(ID# used in city/agency database)

SHPO INFO FOR THIS PROPERTY

NR date listed: NHD

ILS survey date: 3/20/2008

RLS survey date: 6/1/2007

Gen File date:

106 Project(s)

Northeast facade, looking northwest

Oregon Historic Site Form

Davis, A E, House
702 4th Ave
Oregon City, Clackamas County

ARCHITECTURAL / PROPERTY DESCRIPTION

(Include expanded description of the building/property, setting, significant landscape features, outbuildings, and alterations)

The house is composed of a 1 1/2 story front gabled rectangular portion facing north to 4th Avenue located at the west side of unimproved Apperson Street on a level bench area of land slightly above the street. There is a one story 'L' shaped service addition at the rear that is indicated on the 1911 Sanborn map. The roof of the addition has been extended down on the west side.

Exterior Finish Materials: Roof: medium sloped roof (approx 8:12) with composition shingles and center brick chimney; channel siding with corner boards and plain trim; wide rake board, water table; vertical T&G skirt boards to grade cover footings (possibly brick or concrete piers) addition similar; Full width front porch with hip supported on four posts (posts are replacements)

Windows: wood double hung; many 4/4, some 1/1; single units; other smaller units and porch infill; Doors: Wood and wood-glass panel stile and rail. All with flat trim.

Alterations: minor alterations including some at windows, front porch posts, steps and railings, rear porch; new decks at rear.

Landscape: Open grass-pasture setting with limited shrubs and trees on this relatively level site; white picket fence at property lines; small fruit trees at rear and native pine at front.

HISTORY

(Chronological, descriptive history of the property from its construction through at least the historic period [preferably to the present])

In 1889 Arthur E. Davis was listed as agent for the Portland Flouring Mills and lived in his home high on the hill in Canemah. While Davis lived in Canemah, he was the mill's agent in Oregon City. By 1899 he was treasurer of the company and lived in Portland on N.E. Ainsworth Street. The Portland Flouring Mills was owned and operated by T.B. Wilcox and Charles E. Ladd and had grown to a position of economic prominence in the Pacific Northwest grain business, shipping a great deal of flour to Asia. Also working for the company was another Canemah resident, Joseph Ganong, who began as a bookkeeper and was named President of the company when Wilcox died unexpectedly during WWI.

RESEARCH INFORMATION

(Check all of the basic sources consulted and cite specific important sources)

- | | | | |
|--|--|---|---|
| <input type="checkbox"/> Title Records | <input type="checkbox"/> Census Records | <input type="checkbox"/> Property Tax Records | <input type="checkbox"/> Local Histories |
| <input checked="" type="checkbox"/> Sanborn Maps | <input type="checkbox"/> Biographical Sources | <input type="checkbox"/> SHPO Files | <input type="checkbox"/> Interviews |
| <input checked="" type="checkbox"/> Obituaries | <input checked="" type="checkbox"/> Newspapers | <input type="checkbox"/> State Archives | <input type="checkbox"/> Historic Photographs |
| <input checked="" type="checkbox"/> City Directories | <input type="checkbox"/> Building Permits | <input type="checkbox"/> State Library | |

Local Library: _____ University Library: _____

Historical Society: Museum of the Oregon Territory; OHS Other Repository: _____

Bibliography: Portland City Directory, 1889; 1899-1900; Journal 3/24/1936 p26; Sanborn maps, 1911, 1925.