



City of Oregon City

625 Center Street
Oregon City, OR 97045
503-657-0891

Staff Report

File Number: PC 18-127

Agenda Date: 9/25/2018

Status: Draft

To: Historic Review Board

Agenda #:

From: Kelly Reid

File Type: Planning Item

SUBJECT:

Design Advice: Solar panels on a historic site in McLoughlin Conservation District - 301 Madison St.

RECOMMENDED ACTION (Motion): Staff recommends the Board provides non-binding advice on the placement of the panels.

BACKGROUND: The applicant proposed solar panels on the street-facing roof and is seeking non-binding design advice. The house is located at 301 Madison Street - Rudolph & Augusta Seiler House.

Design Guidelines call for equipment and technology to be minimized in appearance and located at less visible areas. The roof sections where the applicant would like to install solar panels are visible from the street as shown in the applicant's drawings and photos. The applicant wishes to determine if the Board would find these locations acceptable before moving forward with an application for Historic Review.

The Historic Review Board created the design advice process as a way to interact with applicants at the beginning of the design process. These interactions are at publicly noticed meetings and are entered into the record if the applicant submits for historic land use approval.

BUDGET IMPACT:

Amount:

FY(s):

Funding Source:

From: [Kelly Reid](#)
To: [Kelly Reid](#)
Subject: FW: Beasley Family - 301 Madison St.
Date: Monday, September 17, 2018 3:06:40 PM
Attachments: [image002.png](#)
[DESIGN PRELIM - BEASLEY RESIDENCE.pdf](#)

From: Matt Ellis [mailto:matt.ellis@auricsolar.com]
Sent: Monday, September 17, 2018 2:07 PM
To: Kelly Reid <kreid@orcify.org>
Cc: Rob Smith <rob.smith@auricsolar.com>
Subject: Beasley Family - 301 Madison St.

Dear Kelly and the Oregon City Historic Planning Board,

I stopped by last week and spoke with Kelly about the best way to proceed with a solar installation on an historic home in Oregon City. She recommended that I submit an email today, 9/17 for your meeting 9/25 to get directions and advice on locations, etc for the solar project. That way, we can review and edit the plans and submit them for the October meeting. Thank you all in advance for your assistance with this project!

Attached you will find the following:

1. Recent color photos of the home to show the current roof color & current paint color
2. A photo with one of our panels resting on the roof to show the aesthetic quality
3. A design prelim showing the best places for panels. We can definitely fit more panels on the home, but we felt this showed the nicest, cleanest look and provides the best production for the customer

The Beasley family is currently looking to add 11 panels. The design prelim shows 13. Our hope is that the Historic review board can tell us where they would like us to put those 11 panels, even if they aren't in the locations pictured. We want to be respectful of all aspects in this installation.

Thank you!

Matt Ellis
Auric Solar
503-793-4391



"We are like tenant farmers chopping down the fence around our house for fuel when we should be using Nature's inexhaustible sources of energy--sun, wind and tide. I'd put my money on the sun and solar energy. What a source of power! I hope we don't have to wait until oil and

coal run out before we tackle that.” — Thomas Alva Edison, 1931

NOTES:

1. FIELD ADJUST ARRAYS ON SLOPE FOR BEST PLACEMENT.
2. ALLOW 1' FROM RIDGE AS PER OREGON FIRE CODE.

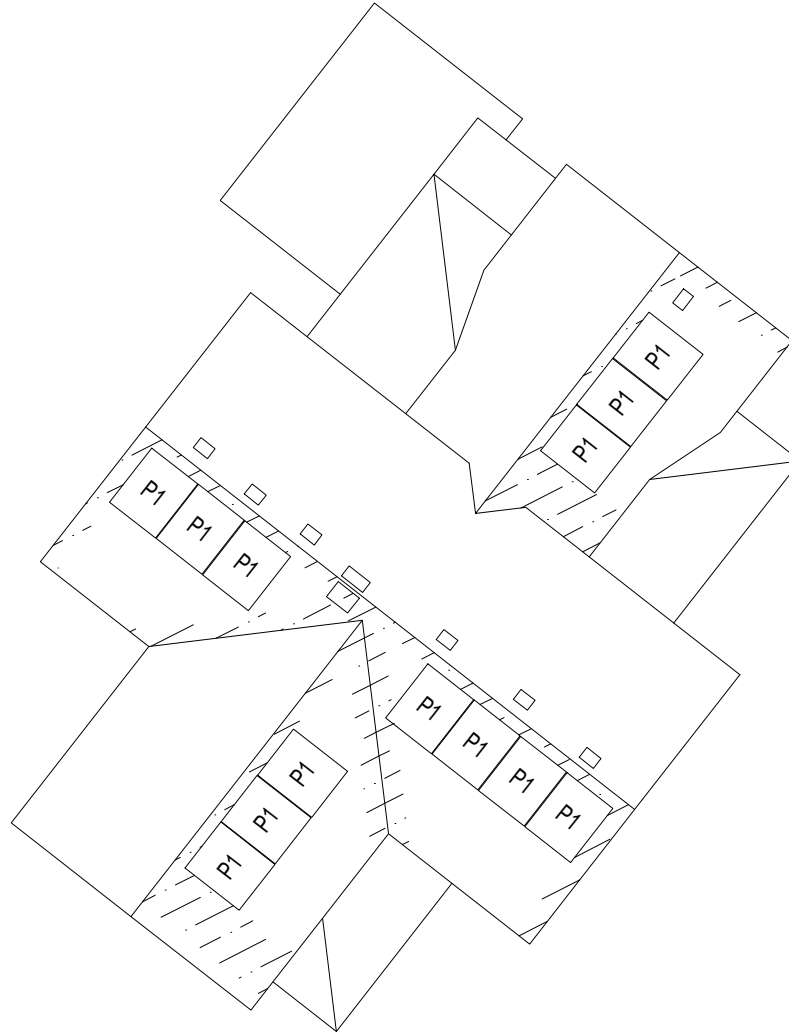
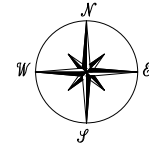

SILFAB SLA-M 310W MODULES
ENPHASE IQ7-60-2-US
MICROINVERTERS

11 @ 310W = 3.41KW

SCALE: NO SCALE



Auric
SOLAR

BEASLEY RESIDENCE

301 MADISON STREET, OREGON CITY, OR 97045

PRELIMINARY LAYOUT

Proprietary design of AURIC SOLAR. Any unauthorized use or replication of any or all of the design will be subject to prosecution.

DATE:	9/17/2018
JOB NO:	176564
REVISION NO:	001
DESIGN BY:	BT

1 OF 1





