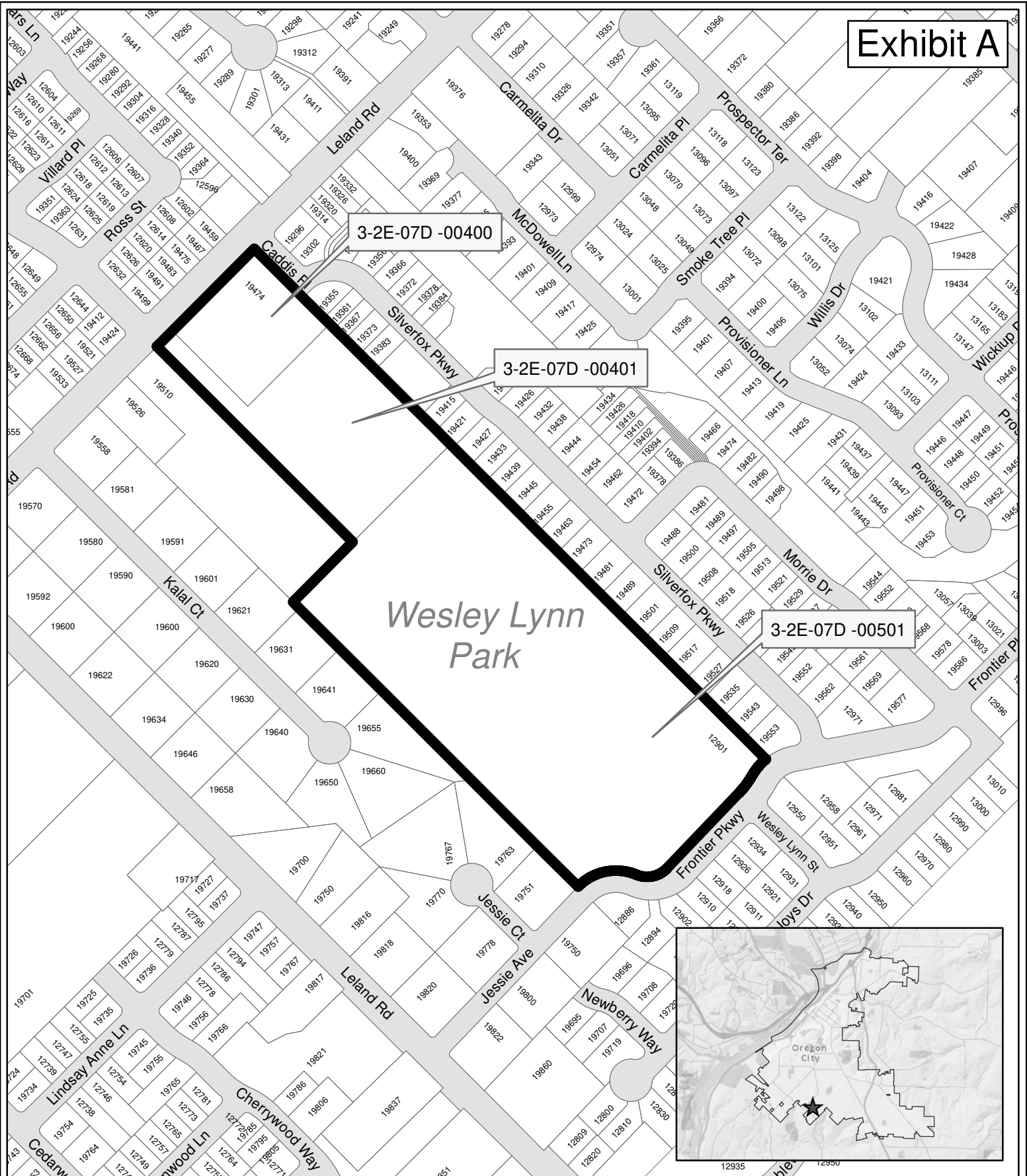

Exhibit A



The City of Oregon City makes no representations, express or implied, as to the accuracy, completeness and timeliness of the information displayed. This map is not suitable for legal, engineering, or surveying purposes. Notification of any errors is appreciated.



Wesley Lynn Park Ordinance 18-1016

0 250 500
Feet

1 inch = 300 feet

City of Oregon City
P.O. Box 3040
625 Center St
Oregon City, OR 97045
503-657-0891 phone
503-657-6629 fax
www.orcity.org



Plot date: August 23, 2018
Plot name: Wesley Lynn Park - Ordinance - 8_5x11P - 20180823.pdf
Map name: Wesley Lynn Park - Ordinance - 8_5x11P.mxd