

CITY OF OREGON CITY  
LOCAL  
WETLAND INVENTORY

APPROVED WETLANDS INVENTORY  
Oregon Division of State Lands  
Meets Local Wetland Inventory standards  
Date 7/19 Approved by ST. Croix

LEGEND

- Urban Growth Boundary
- Wetland
- Wetland label
- Riparian label
- Sample site
- DBL wetland
- DBL label
- Mitigation wetland
- Site access not granted
- Stream

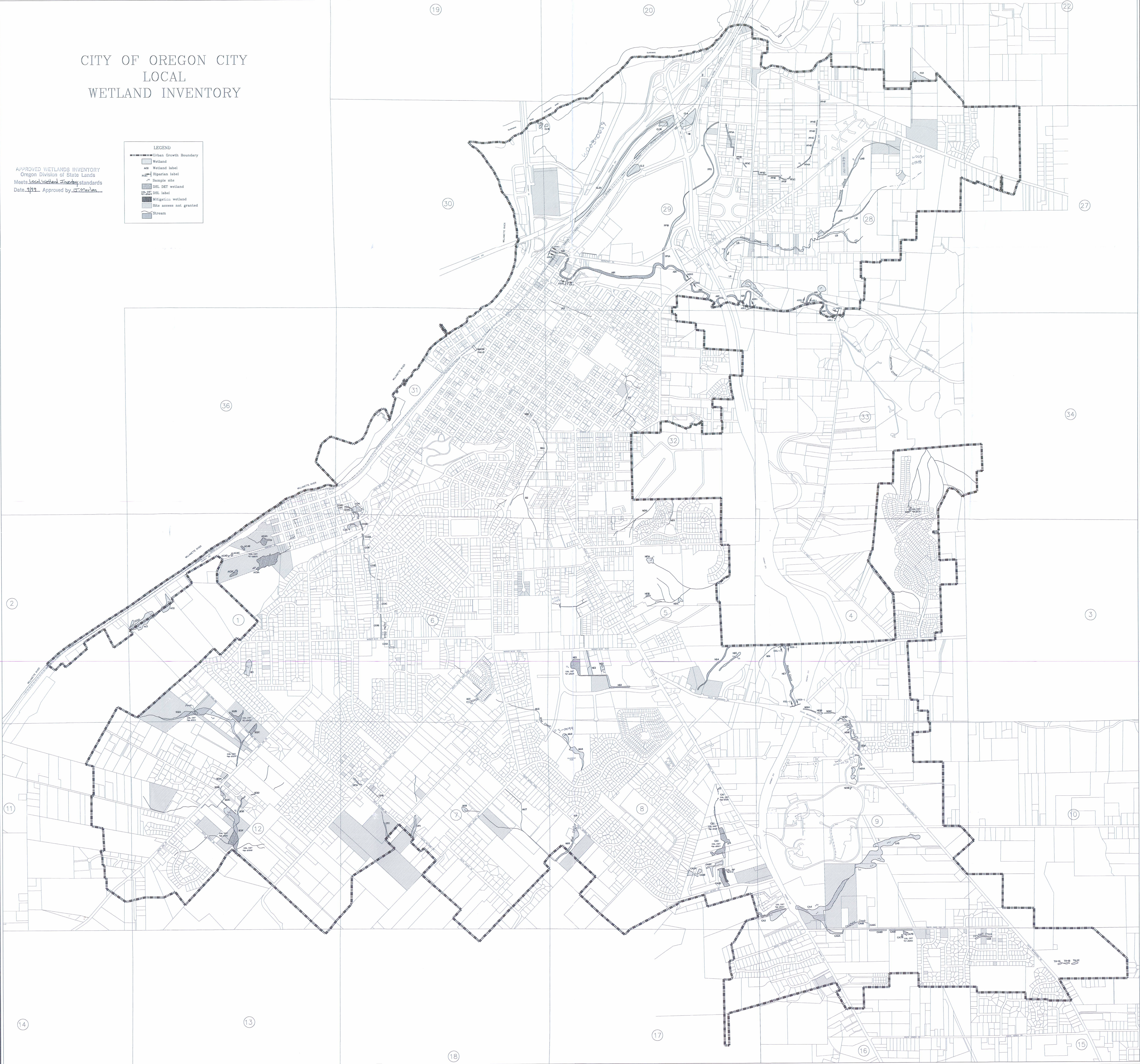



# CITY OF OREGON CITY LOCAL WETLAND INVENTORY

APPROVED WETLANDS INVENTORY  
Oregon Division of State Lands

Meets LWZ standards

Date 9/99 Approved by J. Moran

## ATTACHMENT SECTION MAPS

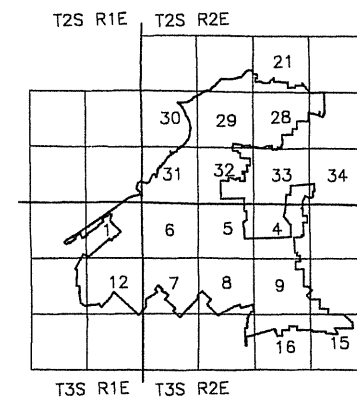

JUNE  
1999

*City of Oregon City*  
320 Warner Milne Road  
Oregon City, Oregon 97045

PROJECT #7971165

 SHAPIRO  
INCORPORATED

APPROVED WETLANDS INVENTORY  
Oregon Division of State Lands  
Meets L337 standards  
Date 7/97 Approved by J. Medan

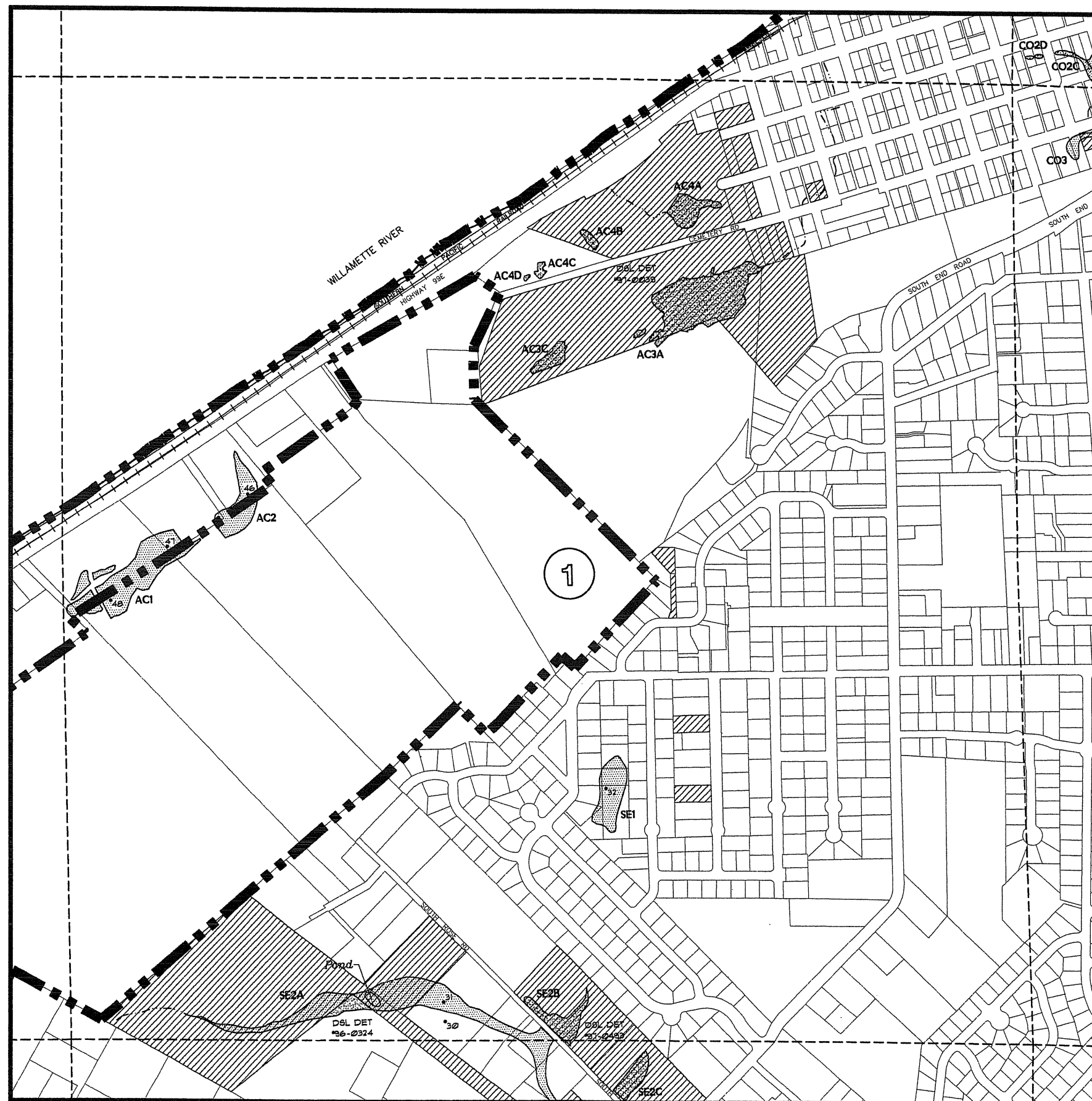

T 3S R 1E Section 01

# CITY OF OREGON CITY LOCAL WETLAND INVENTORY

## LEGEND

- Urban Growth Boundary
- Wetland
- AC2 Wetland label
- FCR1 Riparian label
- Sample site
- DSL DET wetland
- DSL DET wetland label
- Mitigation wetland
- Site access not granted
- Stream

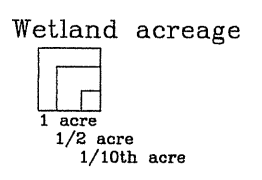
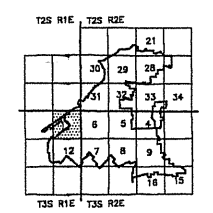

JUNE  
1999

### WETLAND INFORMATION IS SUBJECT TO CHANGE

This map is for planning purposes only. Mapped wetland and riparian boundaries were not flagged or surveyed (unless noted as a delineation study). Boundaries for on-site verified wetlands are accurate to within 25'. There may be exceptions or unmapped wetlands subject to regulation. In all cases, actual field conditions determine wetland boundaries. If site alteration work is proposed, you are advised to contact the Oregon Division of State Lands or the U.S. Army Corps of Engineers with regulatory questions. This study was funded by an Oregon Department of Land Conservation and Development periodic review planning grant.

*City of Oregon City*

320 Warner Milne Road  
Oregon City, Oregon 97045



APPROVED WETLANDS INVENTORY  
Oregon Division of State Lands  
Meets LW standards  
Date 9/99 Approved by J. Moran

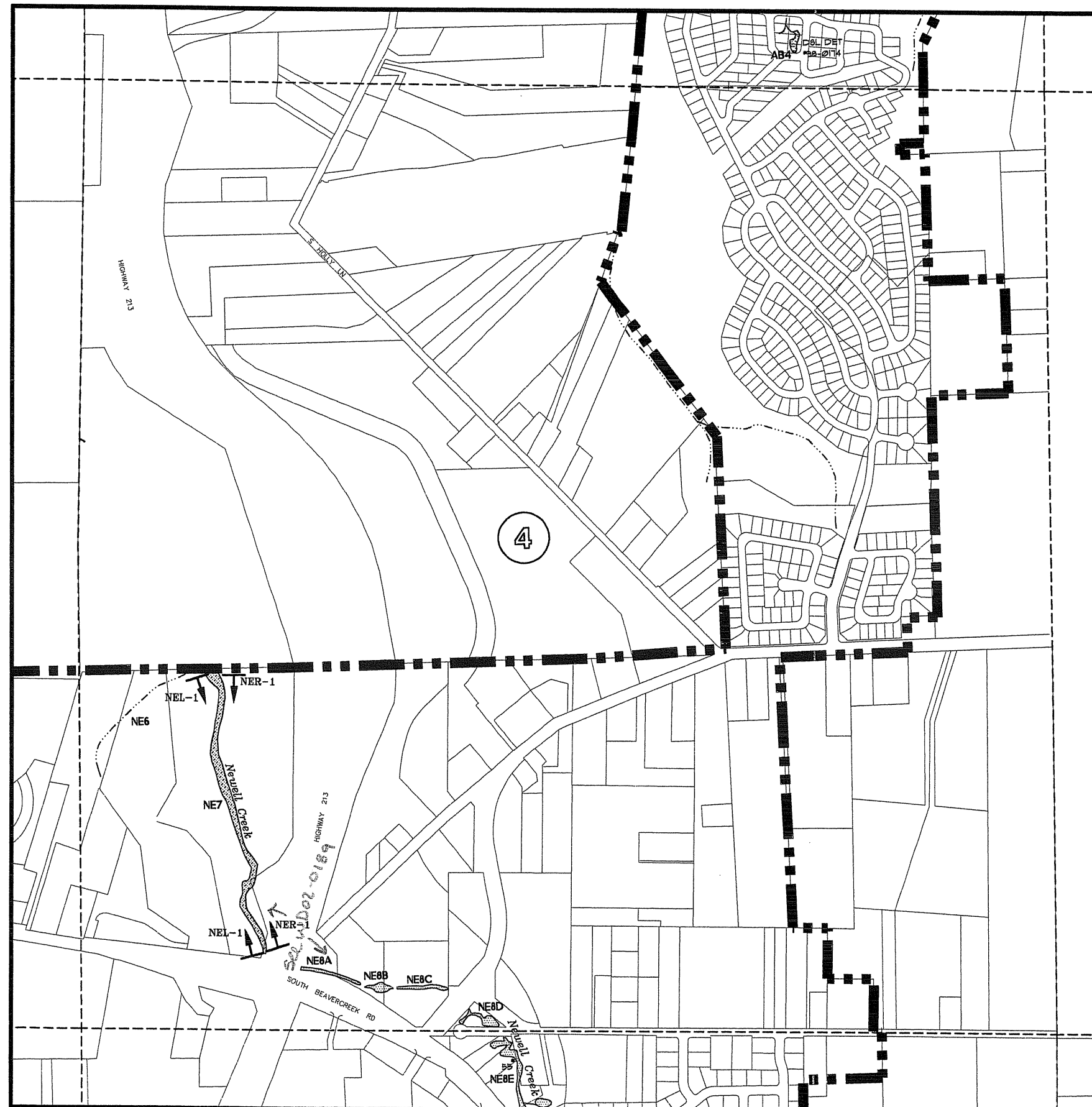

T 3S R 2E Section 04

## CITY OF OREGON CITY LOCAL WETLAND INVENTORY

### LEGEND

- Urban Growth Boundary
- Wetland
- AC2 Wetland label
- FCR1 Riparian label
- .46 Sample site
- DSL DET wetland
- DSL DET 37-0569 DSL label
- Mitigation wetland
- Site access not granted
- Stream

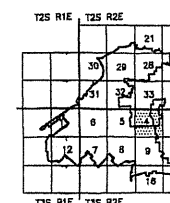

Wetland acreage

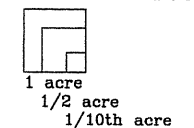

0 400 800  
FEET

JUNE  
1999

### WETLAND INFORMATION IS SUBJECT TO CHANGE

This map is for planning purposes only. Mapped wetland and riparian boundaries were not flagged or surveyed (unless noted as a delineation study). Boundaries for on-site verified wetlands are accurate to within 25'. There may be exceptions or unmapped wetlands subject to regulation. In all cases, actual field conditions determine wetland boundaries. If site alteration work is proposed, you are advised to contact the Oregon Division of State Lands or the U.S. Army Corps of Engineers with regulatory questions. This study was funded by an Oregon Department of Land Conservation and Development periodic review planning grant.

*City of Oregon City*

320 Warner Milne Road  
Oregon City, Oregon 97045

**SHAPIRO**  
INCORPORATED



APPROVED WETLANDS INVENTORY  
Oregon Division of State Lands  
Meets LWZ standards  
Date 2/99 Approved by J. Morlan

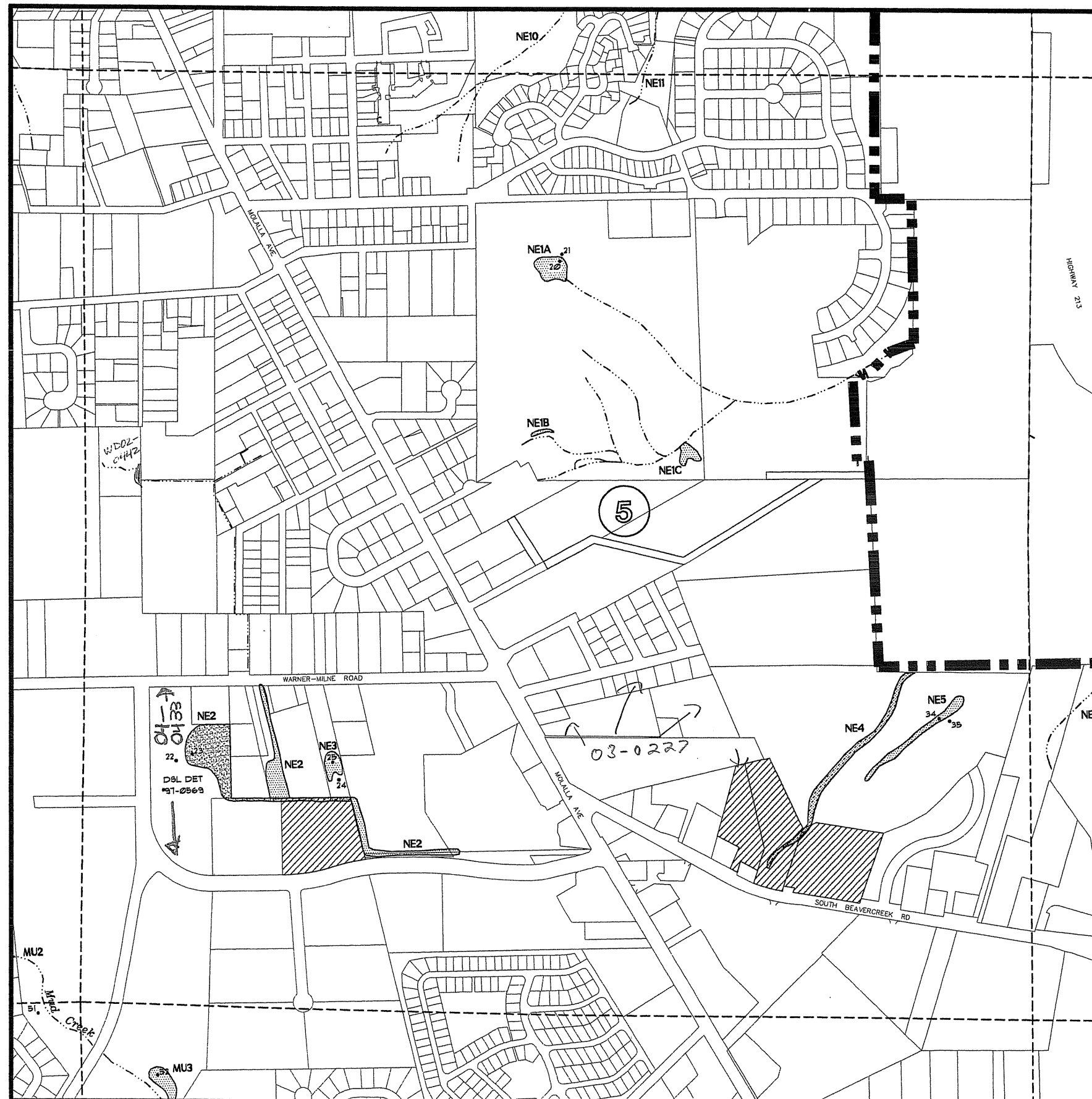

T 3S R 2E Section 05

## CITY OF OREGON CITY LOCAL WETLAND INVENTORY

### LEGEND

- Urban Growth Boundary
- Wetland
- AC2 Wetland label
- Riparian label
- Sample site
- DSL DET wetland
- DSL label
- Mitigation wetland
- Site access not granted
- Stream

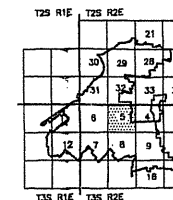

Wetland acreage

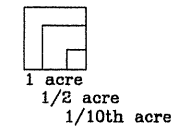

JUNE  
1999

### WETLAND INFORMATION IS SUBJECT TO CHANGE

This map is for planning purposes only. Mapped wetland and riparian boundaries were not flagged or surveyed (unless noted as a delineation study). Boundaries for on-site verified wetlands are accurate to within 25'. There may be exceptions or unmapped wetlands subject to regulation. In all cases, actual field conditions determine wetland boundaries. If site alteration work is proposed, you are advised to contact the Oregon Division of State Lands or the U.S. Army Corps of Engineers with regulatory questions. This study was funded by an Oregon Department of Land Conservation and Development periodic review planning grant.

*City of Oregon City*

320 Warner Milne Road  
Oregon City, Oregon 97045

SHAPIRO  
INCORPORATED



APPROVED WETLANDS INVENTORY  
Oregon Division of State Lands  
Meets LUZ standards  
Date 7/99 Approved by J. Moran

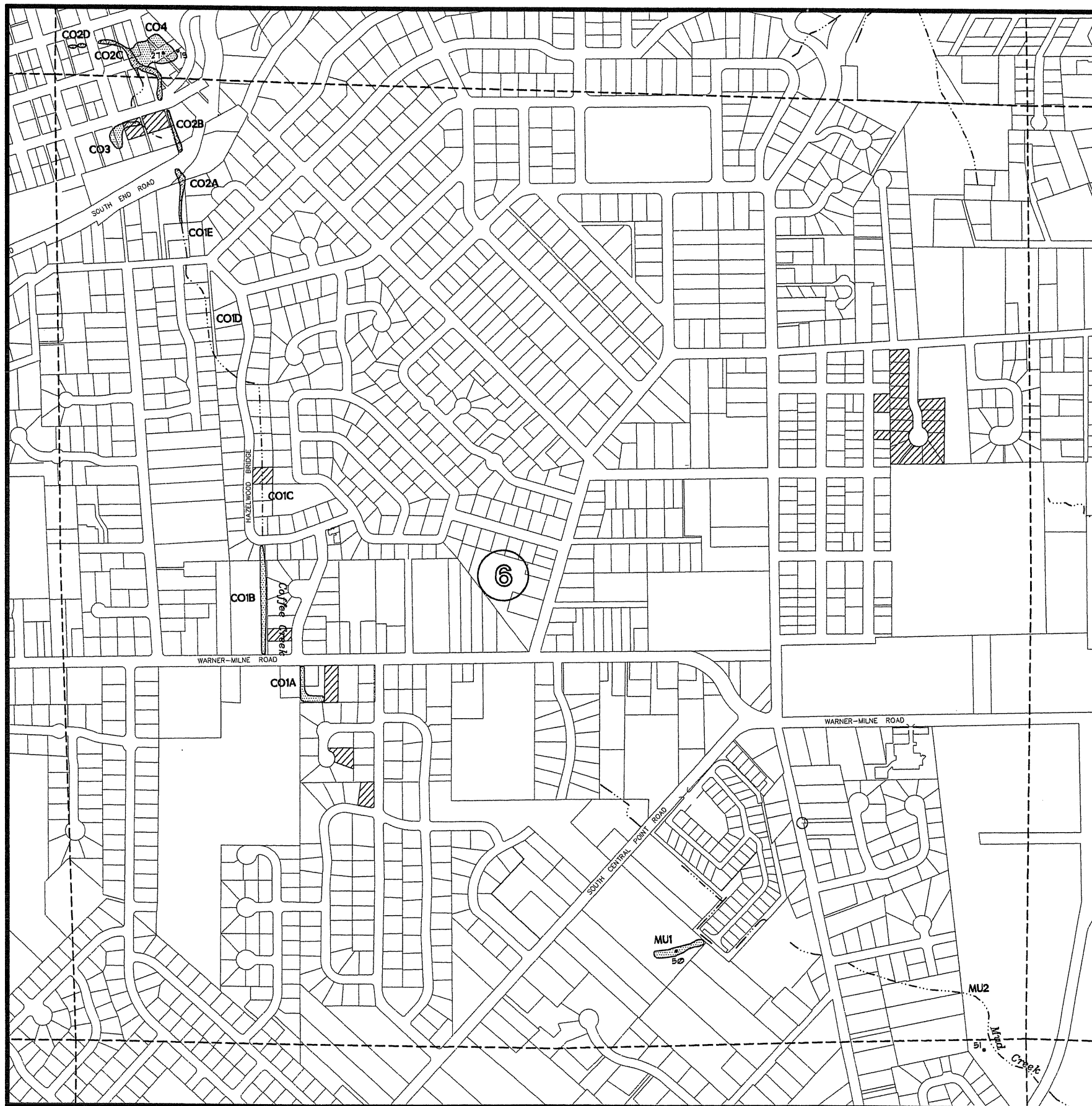

T 3S R 2E Section 06

## CITY OF OREGON CITY LOCAL WETLAND INVENTORY

### LEGEND

- Urban Growth Boundary
- Wetland
- AC2 Wetland label
- FCR1 Riparian label
- .46 Sample site
- DSL DET wetland
- DSL DET 91-2569 DSL label
- Mitigation wetland
- Site access not granted
- Stream

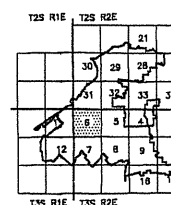

Wetland acreage

1 acre  
1/2 acre  
1/10th acre



0 400 800  
FEET

JUNE  
1999

### WETLAND INFORMATION IS SUBJECT TO CHANGE

This map is for planning purposes only. Mapped wetland and riparian boundaries were not flagged or surveyed (unless noted as a delineation study). Boundaries for on-site verified wetlands are accurate to within 25'. There may be exceptions or unmapped wetlands subject to regulation. In all cases, actual field conditions determine wetland boundaries. If site alteration work is proposed, you are advised to contact the Oregon Division of State Lands or the U.S. Army Corps of Engineers with regulatory questions. This study was funded by an Oregon Department of Land Conservation and Development periodic review planning grant.

*City of Oregon City*

320 Warner Milne Road  
Oregon City, Oregon 97045

SHAPIRO  
INCORPORATED



APPROVED WETLANDS INVENTORY  
Oregon Division of State Lands  
Meets LW 2 standards  
Date 7/97 Approved by J. Morlan

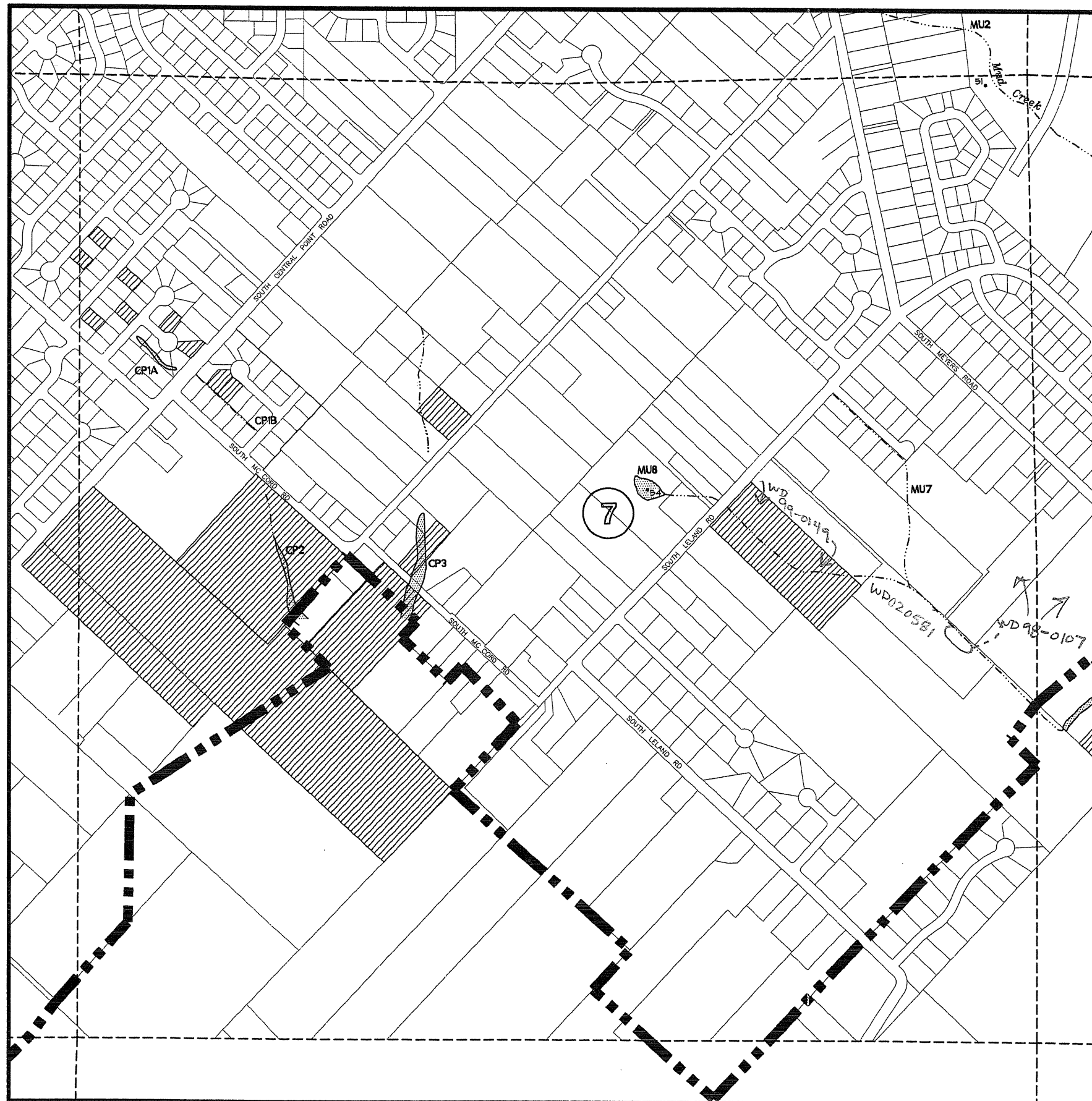

T 3S R 2E Section 07

## CITY OF OREGON CITY LOCAL WETLAND INVENTORY

### LEGEND

- Urban Growth Boundary
- Wetland
- AC2 Wetland label
- Riparian label
- Sample site
- DSL DET wetland
- DSL label
- Mitigation wetland
- Site access not granted
- Stream

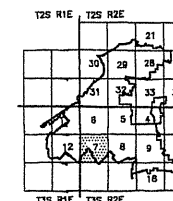

Wetland acreage

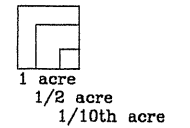

0 400 800  
FEET

JUNE  
1999

### WETLAND INFORMATION IS SUBJECT TO CHANGE

This map is for planning purposes only. Mapped wetland and riparian boundaries were not flagged or surveyed (unless noted as a delineation study). Boundaries for on-site verified wetlands are accurate to within 25'. There may be exceptions or unmapped wetlands subject to regulation. In all cases, actual field conditions determine wetland boundaries. If site alteration work is proposed, you are advised to contact the Oregon Division of State Lands or the U.S. Army Corps of Engineers with regulatory questions. This study was funded by an Oregon Department of Land Conservation and Development periodic review planning grant.

*City of Oregon City*

320 Warner Milne Road  
Oregon City, Oregon 97045





APPROVED WETLANDS INVENTORY  
Oregon Division of State Lands  
Meets LWI standards  
Date 7/99 Approved by J. Moran

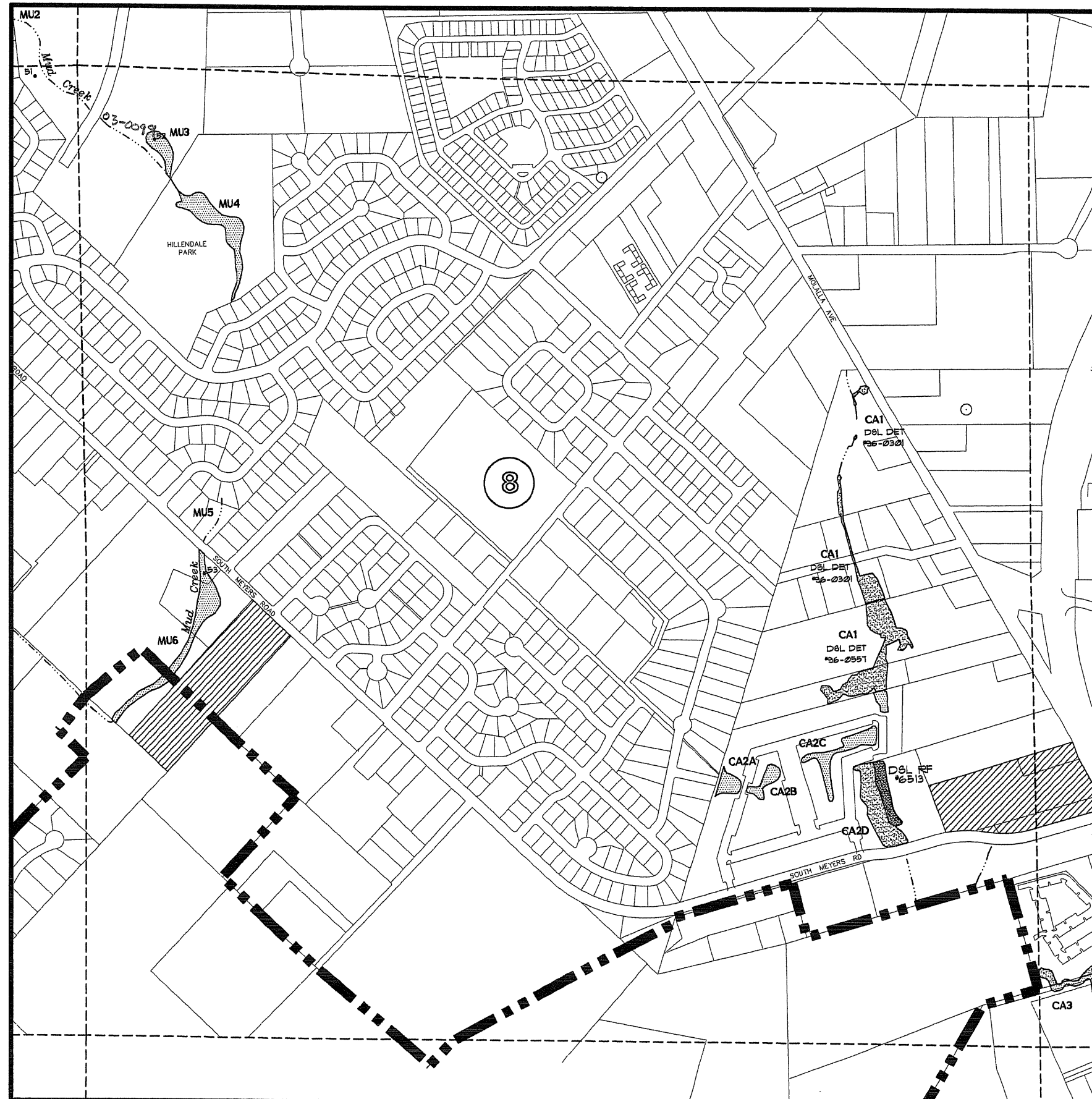

T 3S R 2E Section 08

## CITY OF OREGON CITY LOCAL WETLAND INVENTORY

### LEGEND

- Urban Growth Boundary
- Wetland
- AC2 Wetland label
- FCR1 Riparian label
- Sample site
- DSL DET wetland
- DSL DET #36-0569 DSL label
- Mitigation wetland
- Site access not granted
- Stream

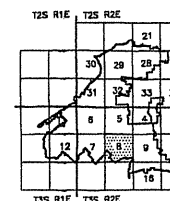

Wetland acreage

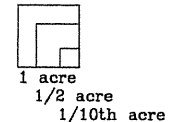

0 400 800  
FEET

JUNE  
1999

### WETLAND INFORMATION IS SUBJECT TO CHANGE

This map is for planning purposes only. Mapped wetland and riparian boundaries were not flagged or surveyed (unless noted as a delineation study). Boundaries for on-site verified wetlands are accurate to within 25'. There may be exceptions or unmapped wetlands subject to regulation. In all cases, actual field conditions determine wetland boundaries. If site alteration work is proposed, you are advised to contact the Oregon Division of State Lands or the U.S. Army Corps of Engineers with regulatory questions. This study was funded by an Oregon Department of Land Conservation and Development periodic review planning grant.

*City of Oregon City*

320 Warner Milne Road  
Oregon City, Oregon 97045

SHAPIRO  
INCORPORATED



APPROVED WETLANDS INVENTORY  
Oregon Division of State Lands  
Meets LWZ standards  
Date 9/99 Approved by J. Morlan



T 3S R 2E Section 09

# CITY OF OREGON CITY LOCAL WETLAND INVENTORY

## LEGEND

- Urban Growth Boundary
- Wetland
- AC2 Wetland label
- Riparian label
- Sample site
- DSL DET wetland
- DSL DET label
- Mitigation wetland
- Site access not granted
- Stream

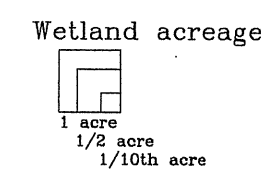
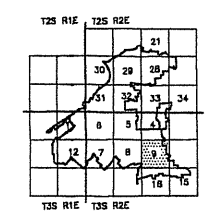

JUNE  
1999

### WETLAND INFORMATION IS SUBJECT TO CHANGE

This map is for planning purposes only. Mapped wetland and riparian boundaries were not flagged or surveyed (unless noted as a delineation study). Boundaries for on-site verified wetlands are accurate to within 25'. There may be exceptions or unmapped wetlands subject to regulation. In all cases, actual field conditions determine wetland boundaries. If site alteration work is proposed, you are advised to contact the Oregon Division of State Lands or the U.S. Army Corps of Engineers with regulatory questions. This study was funded by an Oregon Department of Land Conservation and Development periodic review planning grant.

*City of Oregon City*  
320 Warner Milne Road  
Oregon City, Oregon 97045





APPROVED WETLANDS INVENTORY  
Oregon Division of State Lands  
Meets LW2 standards  
Date 7/99 Approved by J. Morlan

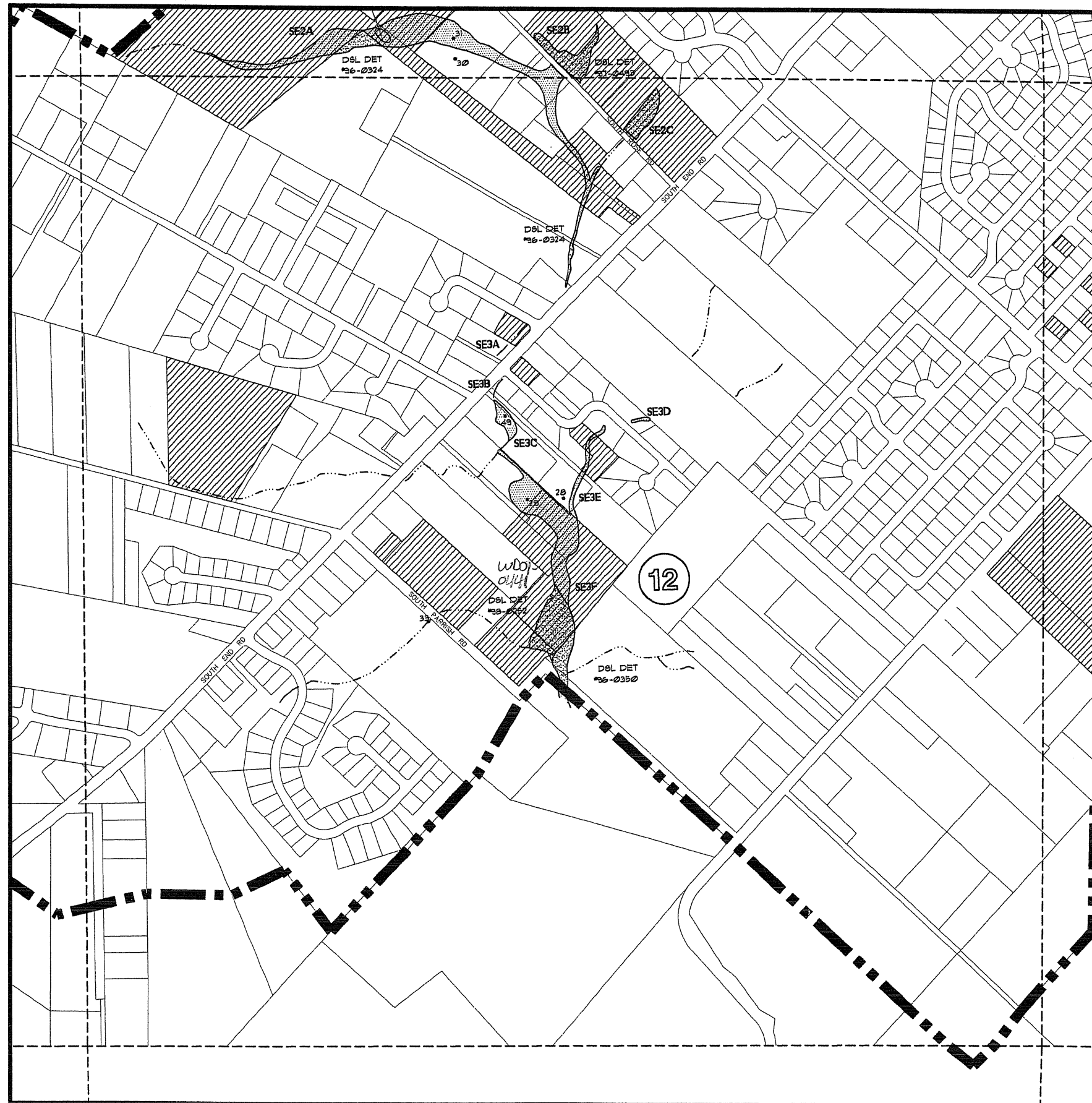

T 3S R 1E Section 12

## CITY OF OREGON CITY LOCAL WETLAND INVENTORY

### LEGEND

- Urban Growth Boundary
- Wetland
- AC2 Wetland label
- FCR1 Riparian label
- Sample site
- DSL DET wetland
- DSL DET DSL label
- Mitigation wetland
- Site access not granted
- Stream

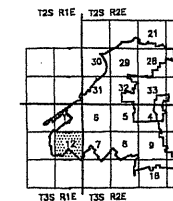

Wetland acreage

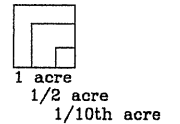

JUNE  
1999

### WETLAND INFORMATION IS SUBJECT TO CHANGE

This map is for planning purposes only. Mapped wetland and riparian boundaries were not flagged or surveyed (unless noted as a delineation study). Boundaries for on-site verified wetlands are accurate to within 25'. There may be exceptions or unmapped wetlands subject to regulation. In all cases, actual field conditions determine wetland boundaries. If site alteration work is proposed, you are advised to contact the Oregon Division of State Lands or the U.S. Army Corps of Engineers with regulatory questions. This study was funded by an Oregon Department of Land Conservation and Development periodic review planning grant.

*City of Oregon City*

320 Warner Milne Road  
Oregon City, Oregon 97045





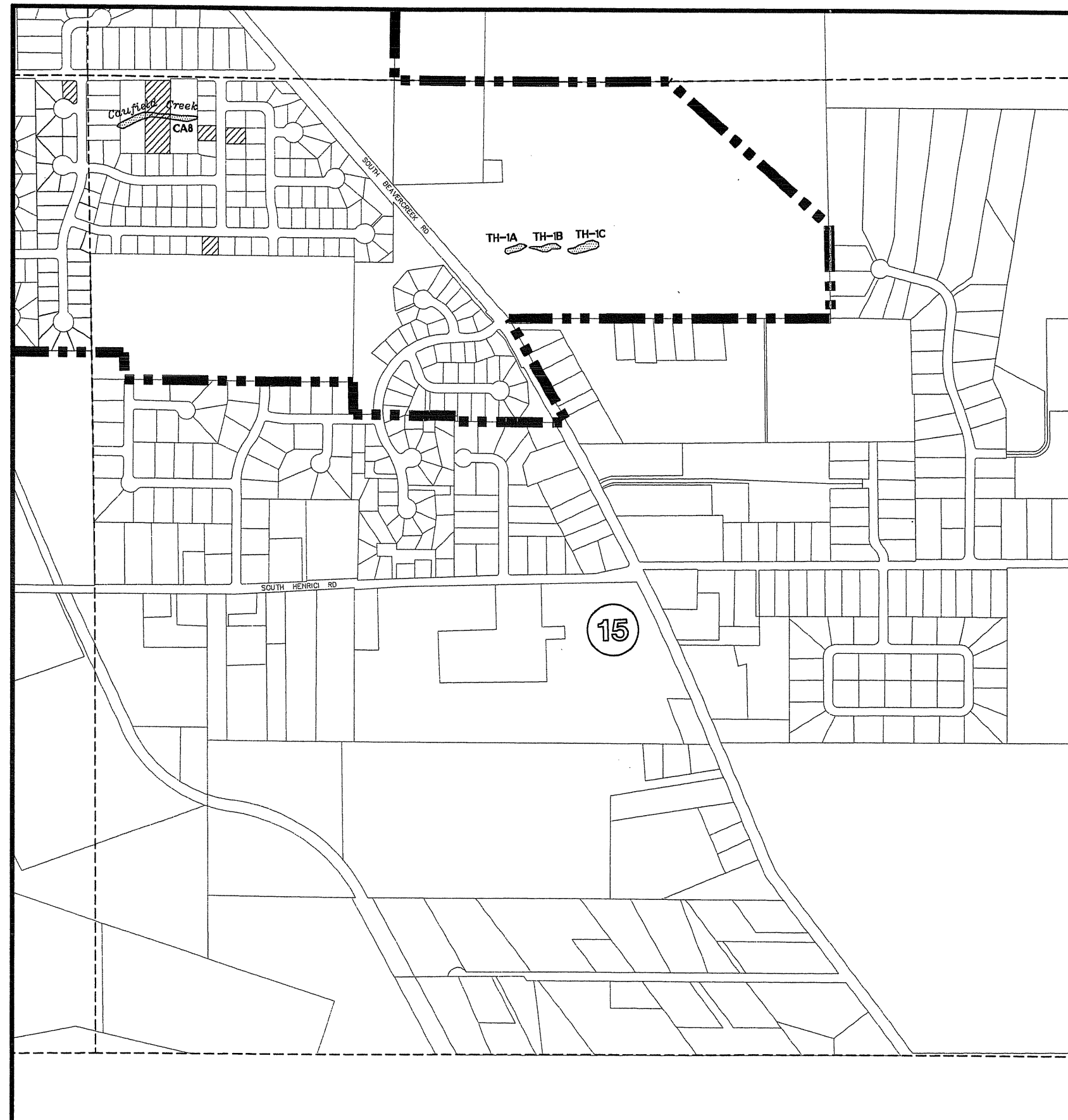

T 3S R 2E Section 15

## CITY OF OREGON CITY LOCAL WETLAND INVENTORY

### LEGEND

- Urban Growth Boundary
- Wetland
- AC2 Wetland label
- FCR1 Riparian label
- Sample site
- DSL DET wetland
- DSL DET label
- Mitigation wetland
- Site access not granted
- Stream

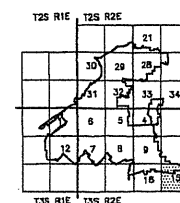

### Wetland acreage

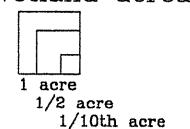

JUNE  
1999

### WETLAND INFORMATION IS SUBJECT TO CHANGE

This map is for planning purposes only. Mapped wetland and riparian boundaries were not flagged or surveyed (unless noted as a delineation study). Boundaries for on-site verified wetlands are accurate to within 25'. There may be exceptions or unmapped wetlands subject to regulation. In all cases, actual field conditions determine wetland boundaries. If site alteration work is proposed, you are advised to contact the Oregon Division of State Lands or the U.S. Army Corps of Engineers with regulatory questions. This study was funded by an Oregon Department of Land Conservation and Development periodic review planning grant.

*City of Oregon City*

320 Warner Milne Road  
Oregon City, Oregon 97045

SHAPIRO  
INCORPORATED



APPROVED WETLANDS INVENTORY  
Oregon Division of State Lands  
Meets LWZ standards  
Date 7/99 Approved by J. Maden

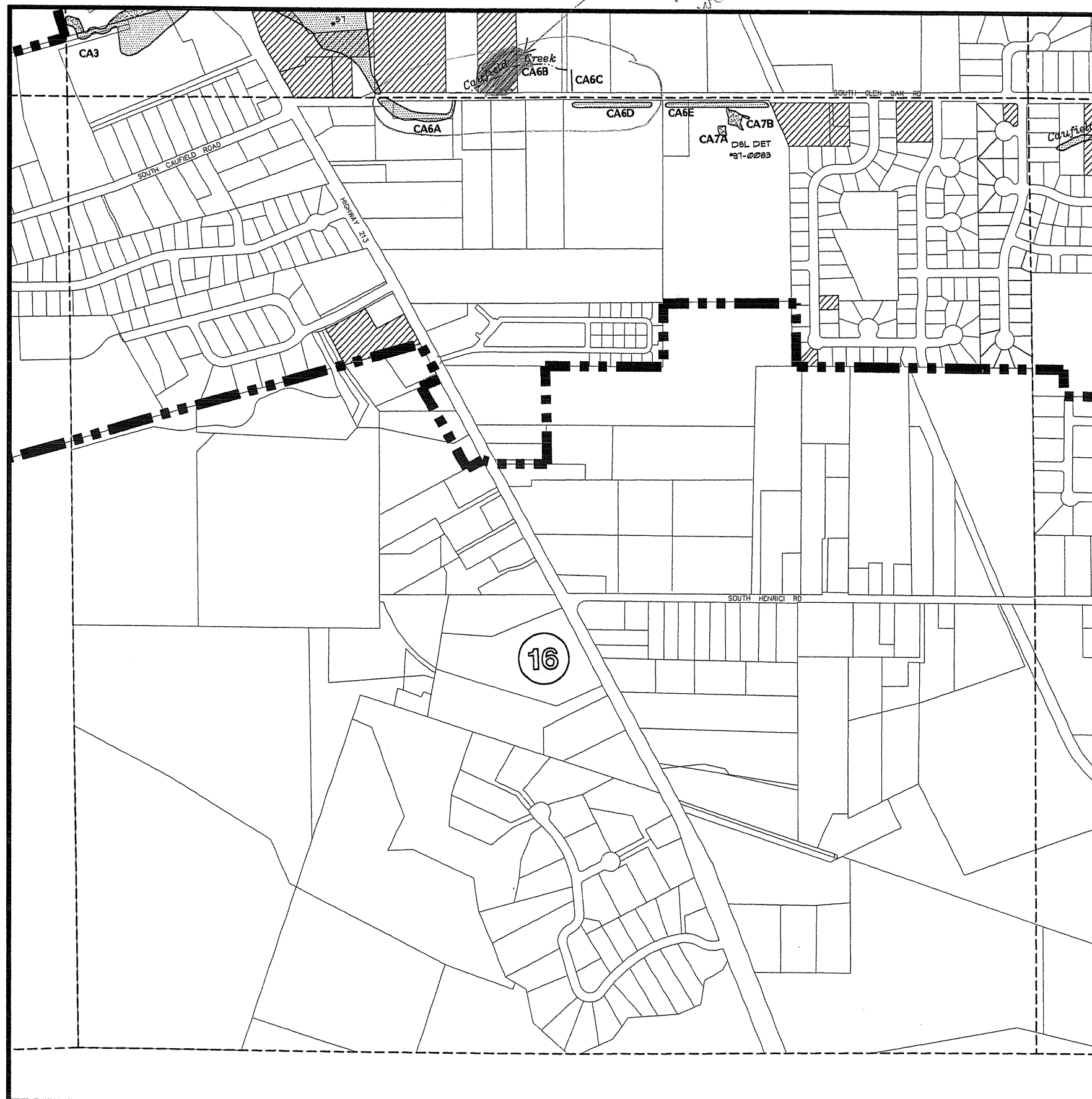

T 3S R 2E Section 16

# CITY OF OREGON CITY LOCAL WETLAND INVENTORY

## LEGEND

- Urban Growth Boundary
- Wetland
- AC2 Wetland label
- FCR1 Riparian label
- .46 Sample site
- DSL DET wetland
- DSL DET DSL label
- Mitigation wetland
- Site access not granted
- Stream

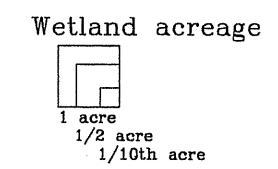
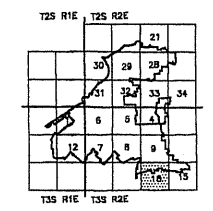

JUNE  
1999

### WETLAND INFORMATION IS SUBJECT TO CHANGE

This map is for planning purposes only. Mapped wetland and riparian boundaries were not flagged or surveyed (unless noted as a delineation study). Boundaries for on-site verified wetlands are accurate to within 25'. There may be exceptions or unmapped wetlands subject to regulation. In all cases, actual field conditions determine wetland boundaries. If site alteration work is proposed, you are advised to contact the Oregon Division of State Lands or the U.S. Army Corps of Engineers with regulatory questions. This study was funded by an Oregon Department of Land Conservation and Development periodic review planning grant.

*City of Oregon City*  
320 Warner Milne Road  
Oregon City, Oregon 97045





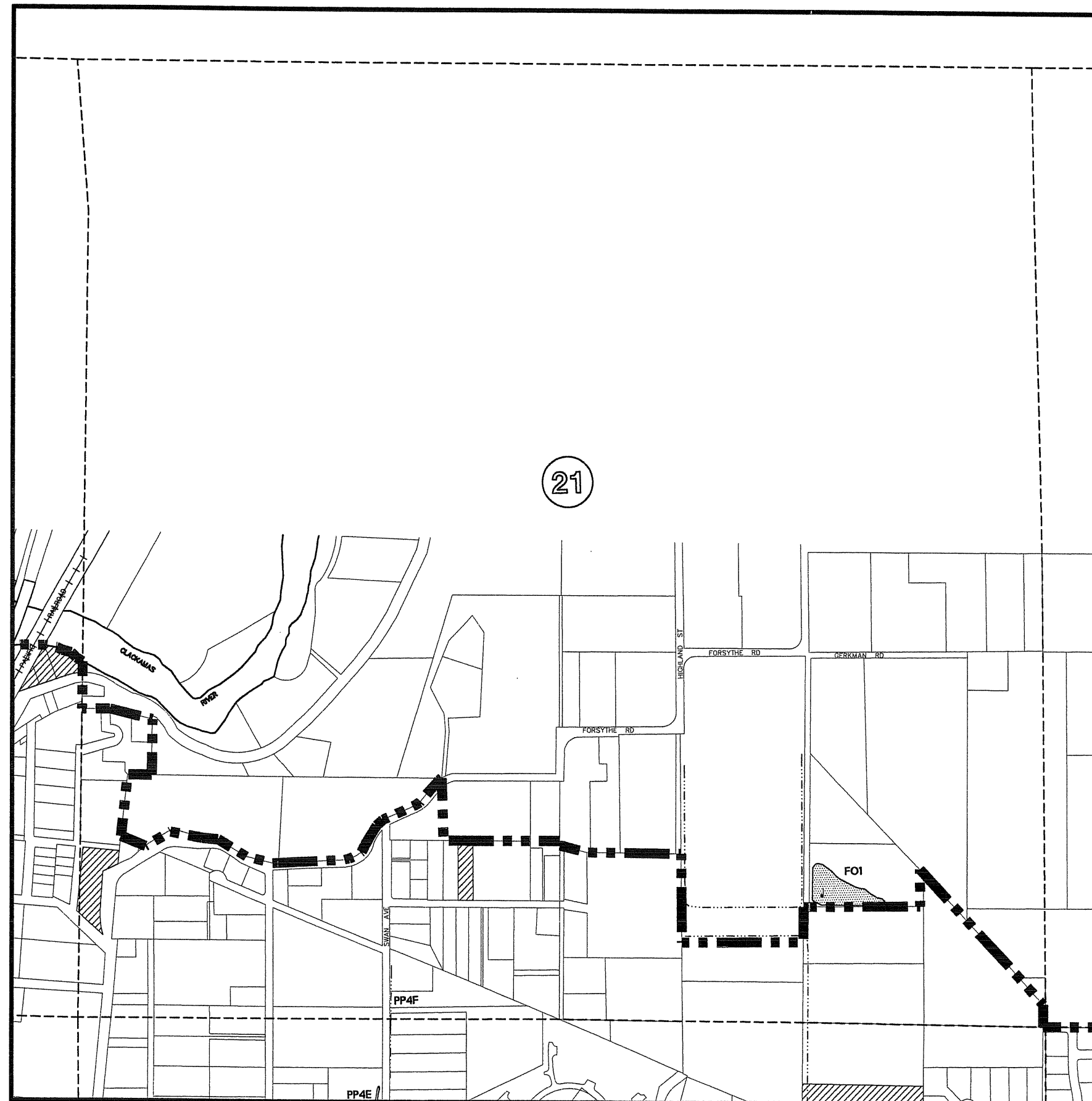

T 2S R 2E Section 21

## CITY OF OREGON CITY LOCAL WETLAND INVENTORY

### LEGEND

- Urban Growth Boundary
- Wetland
- AC2 Wetland label
- Riparian label
- Sample site
- DSL DET wetland
- DSL label
- Mitigation wetland
- Site access not granted
- Stream

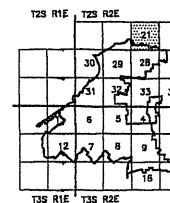

Wetland acreage

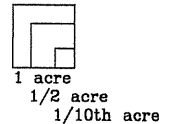

0 400 800  
FEET

JUNE  
1999

### WETLAND INFORMATION IS SUBJECT TO CHANGE

This map is for planning purposes only. Mapped wetland and riparian boundaries were not flagged or surveyed (unless noted as a delineation study). Boundaries for on-site verified wetlands are accurate to within 25'. There may be exceptions or unmapped wetlands subject to regulation. In all cases, actual field conditions determine wetland boundaries. If site alteration work is proposed, you are advised to contact the Oregon Division of State Lands or the U.S. Army Corps of Engineers with regulatory questions. This study was funded by an Oregon Department of Land Conservation and Development periodic review planning grant.

*City of Oregon City*

320 Warner Milne Road  
Oregon City, Oregon 97045

SHAPIRO  
INCORPORATED



APPROVED WETLANDS INVENTORY  
 Oregon Division of State Lands  
 Meets 1303 standards  
 Date 7/97 Approved by J. Morlan

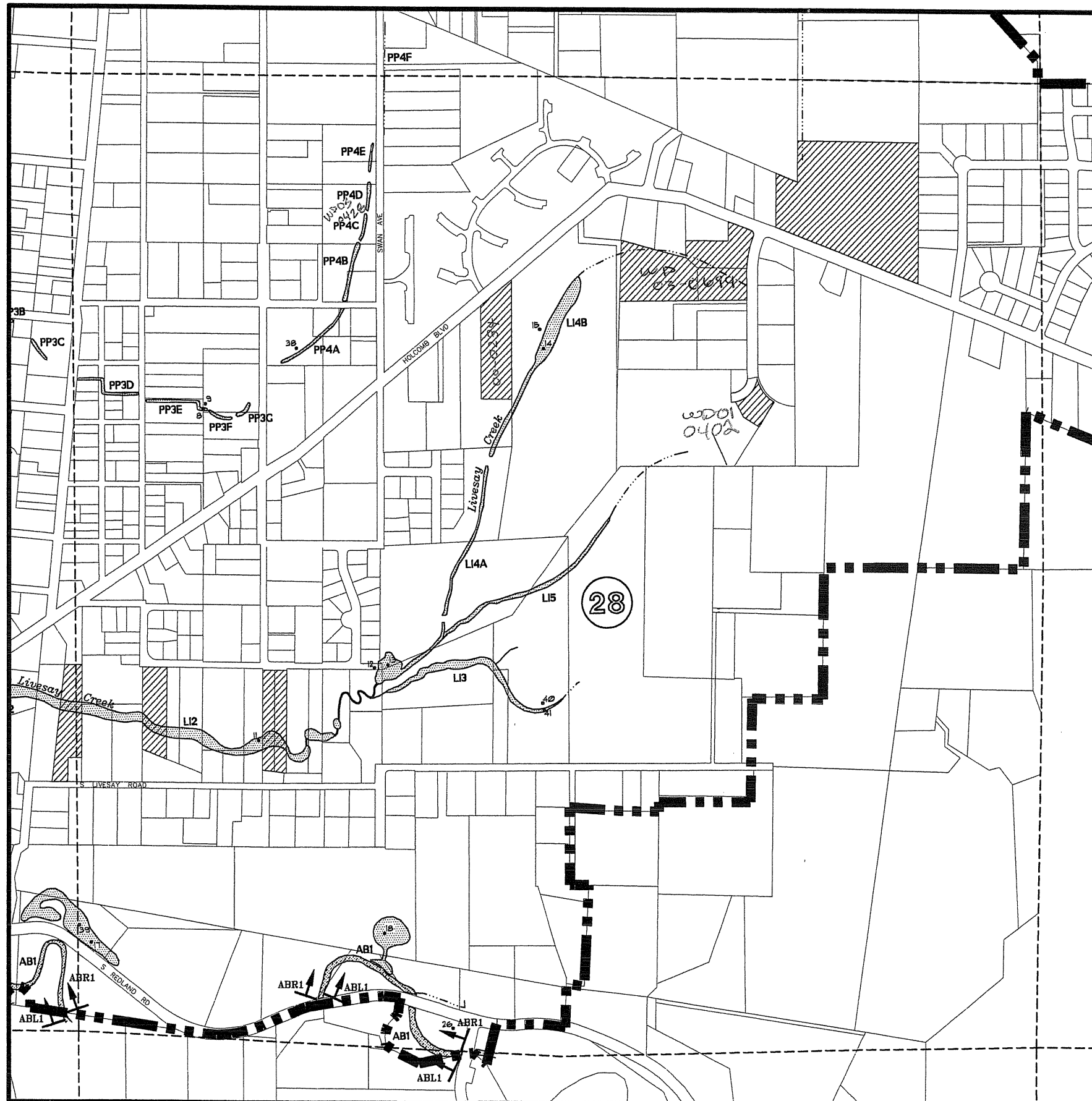

T 2S R 2E Section 28

# CITY OF OREGON CITY LOCAL WETLAND INVENTORY

## LEGEND

- Urban Growth Boundary
- Wetland
- AC2 Wetland label
- FCR1 Riparian label
- .46 Sample site
- DSL DET wetland
- DSL DET 97-0569 DSL label
- Mitigation wetland
- Site access not granted
- Stream

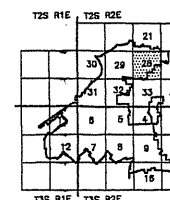

Wetland acreage

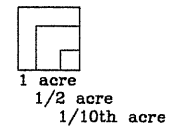

JUNE  
1999

WETLAND INFORMATION IS SUBJECT TO CHANGE

This map is for planning purposes only. Mapped wetland and riparian boundaries were not flagged or surveyed (unless noted as a delineation study). Boundaries for on-site verified wetlands are accurate to within 25'. There may be exceptions or unmapped wetlands subject to regulation. In all cases, actual field conditions determine wetland boundaries. If site alteration work is proposed, you are advised to contact the Oregon Division of State Lands or the U.S. Army Corps of Engineers with regulatory questions. This study was funded by an Oregon Department of Land Conservation and Development periodic review planning grant.

*City of Oregon City*

320 Warner Milne Road  
 Oregon City, Oregon 97045





APPROVED WETLANDS INVENTORY  
Oregon Division of State Lands  
Meets LWZ standards  
Date 7/99 Approved by J. Merlan

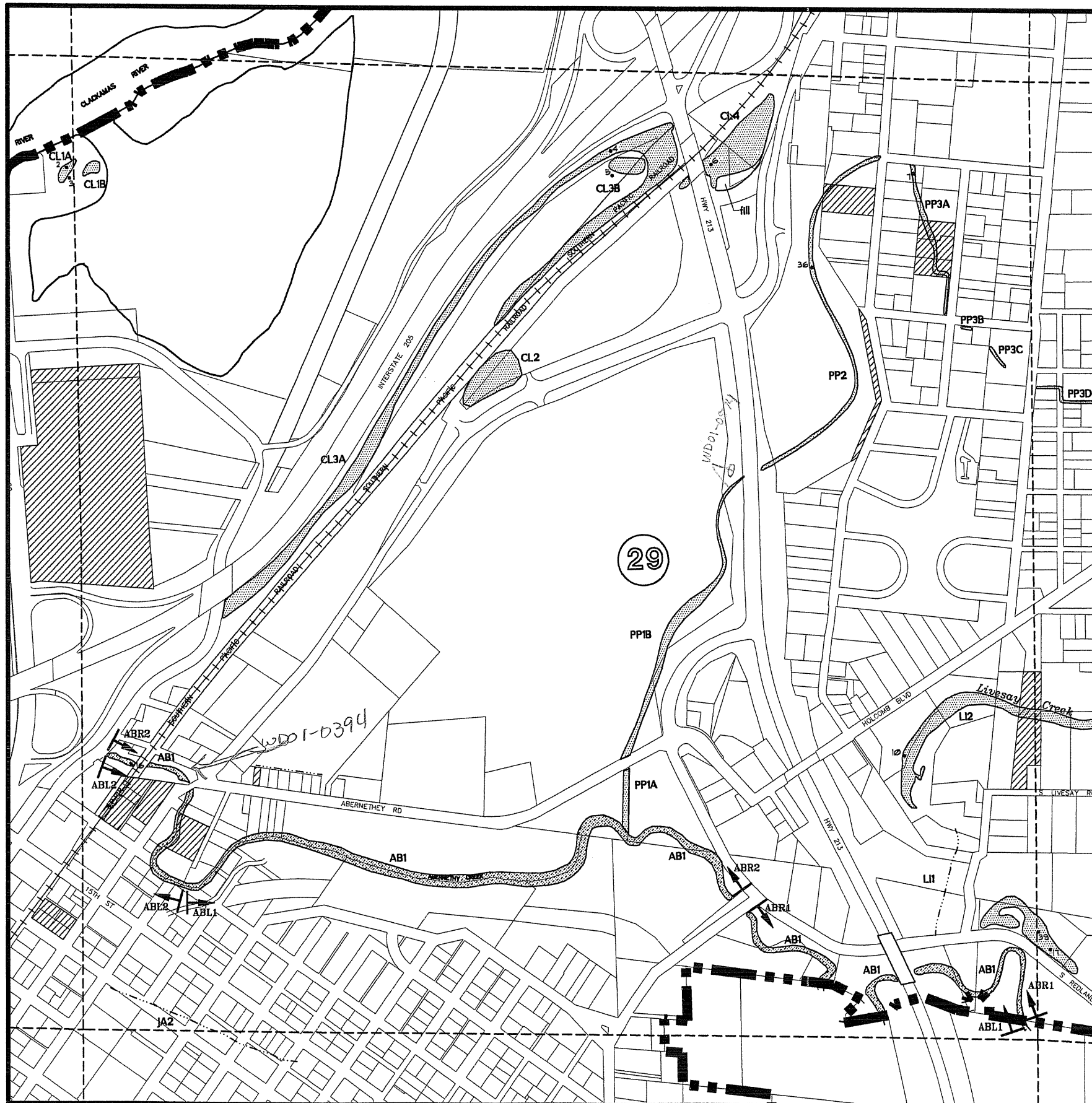

T 2S R 2E Section 29

## CITY OF OREGON CITY LOCAL WETLAND INVENTORY

### LEGEND

- Urban Growth Boundary
- Wetland
- AC2 Wetland label
- FCR1 Riparian label
- 46 Sample site
- DSL DET wetland
- DSL DET #31-0569 DSL label
- Mitigation wetland
- Site access not granted
- Stream

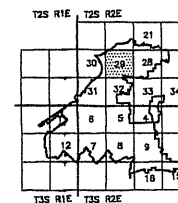

Wetland acreage

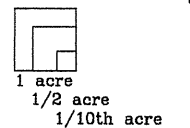

0 400 800  
FEET

JUNE  
1999

WETLAND INFORMATION IS SUBJECT TO CHANGE

This map is for planning purposes only. Mapped wetland and riparian boundaries were not flagged or surveyed (unless noted as a delineation study). Boundaries for on-site verified wetlands are accurate to within 25'. There may be exceptions or unmapped wetlands subject to regulation. In all cases, actual field conditions determine wetland boundaries. If site alteration work is proposed, you are advised to contact the Oregon Division of State Lands or the U.S. Army Corps of Engineers with regulatory questions. This study was funded by an Oregon Department of Land Conservation and Development periodic review planning grant.

*City of Oregon City*

320 Warner Milne Road  
Oregon City, Oregon 97045

SHAPIRO  
INCORPORATED



APPROVED WETLANDS INVENTORY  
Oregon Division of State Lands  
Meets LW 2 standards  
Date 7/99 Approved by J. Merlan



T 2S R 2E Section 30

## CITY OF OREGON CITY LOCAL WETLAND INVENTORY

### LEGEND

- Urban Growth Boundary
- Wetland
- AC2 Wetland label
- FCR1 Riparian label
- Sample site
- DSL DET wetland
- DSL DET label
- Mitigation wetland
- Site access not granted
- Stream

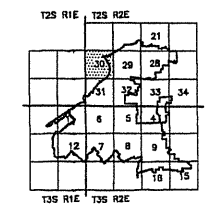

Wetland acreage

1 acre  
1/2 acre  
1/10th acre



JUNE  
1999

### WETLAND INFORMATION IS SUBJECT TO CHANGE

This map is for planning purposes only. Mapped wetland and riparian boundaries were not flagged or surveyed (unless noted as a delineation study). Boundaries for on-site verified wetlands are accurate to within 25'. There may be exceptions or unmapped wetlands subject to regulation. In all cases, actual field conditions determine wetland boundaries. If site alteration work is proposed, you are advised to contact the Oregon Division of State Lands or the U.S. Army Corps of Engineers with regulatory questions. This study was funded by an Oregon Department of Land Conservation and Development periodic review planning grant.

*City of Oregon City*  
320 Warner Milne Road  
Oregon City, Oregon 97045





APPROVED WETLANDS INVENTORY  
Oregon Division of State Lands  
Meets LWI standards  
Date 9/99 Approved by J. Morlan



T 2S R 2E Section 31

# CITY OF OREGON CITY LOCAL WETLAND INVENTORY

## LEGEND

- Urban Growth Boundary
- Wetland
- AC2 Wetland label
- FCR1 Riparian label
- Sample site
- DSL DET wetland
- DSL DET DSL label
- Mitigation wetland
- Site access not granted
- Stream

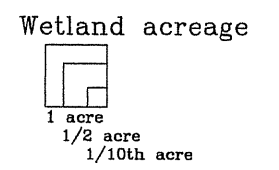
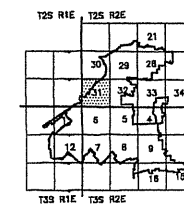

JUNE  
1999

### WETLAND INFORMATION IS SUBJECT TO CHANGE

This map is for planning purposes only. Mapped wetland and riparian boundaries were not flagged or surveyed (unless noted as a delineation study). Boundaries for on-site verified wetlands are accurate to within 25'. There may be exceptions or unmapped wetlands subject to regulation. In all cases, actual field conditions determine wetland boundaries. If site alteration work is proposed, you are advised to contact the Oregon Division of State Lands or the U.S. Army Corps of Engineers with regulatory questions. This study was funded by an Oregon Department of Land Conservation and Development periodic review planning grant.

*City of Oregon City*  
320 Warner Milne Road  
Oregon City, Oregon 97045





APPROVED WETLANDS INVENTORY  
Oregon Division of State Lands  
Meets 1-20-99 standards  
Date 7/99 Approved by J. Morlan

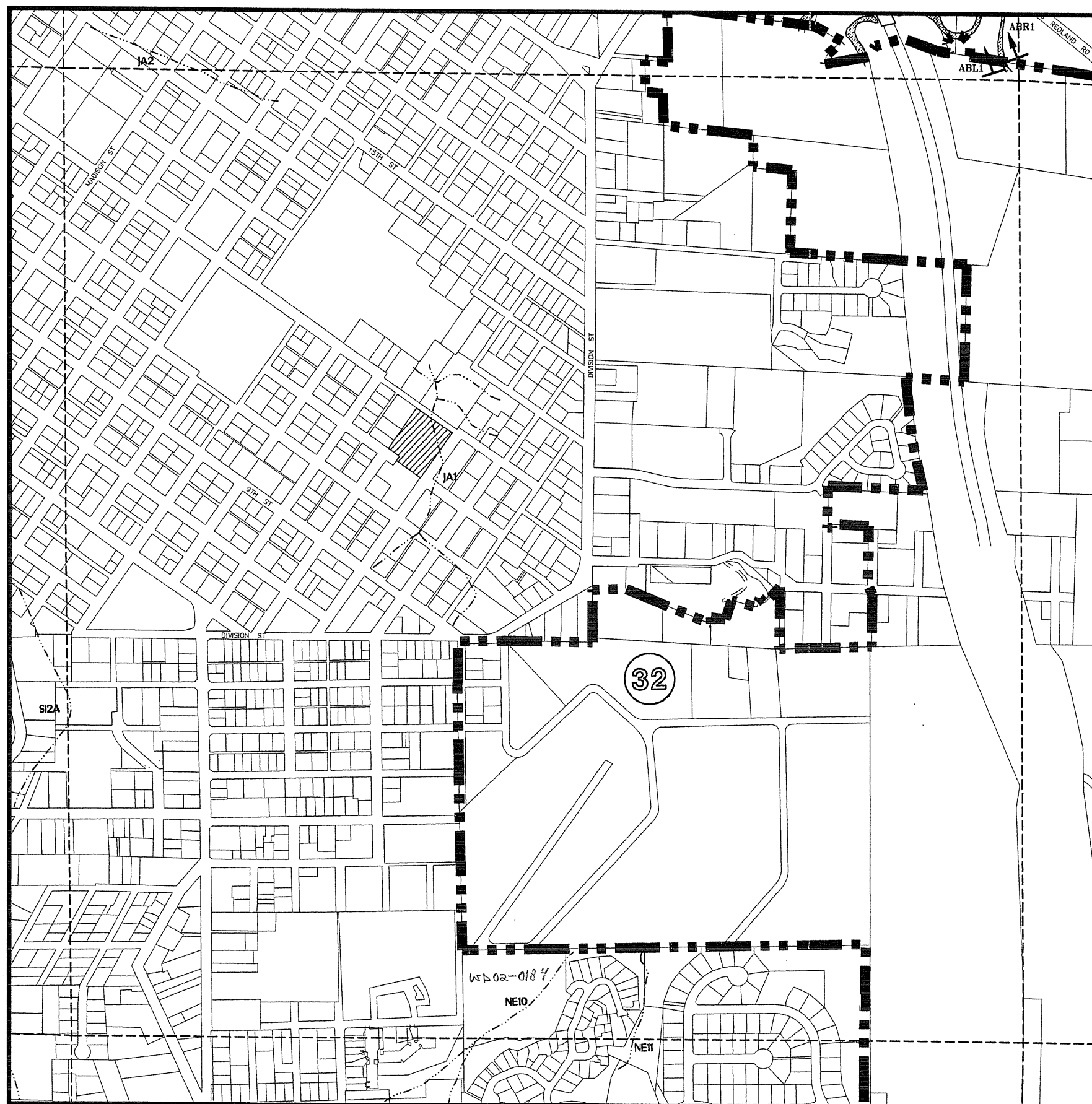

T 2S R 2E Section 32

## CITY OF OREGON CITY LOCAL WETLAND INVENTORY

### LEGEND

- Urban Growth Boundary
- Wetland
- AC2 Wetland label
- FCR1 Riparian label
- Sample site
- DSL DET wetland
- DSL DET label
- Mitigation wetland
- Site access not granted
- Stream

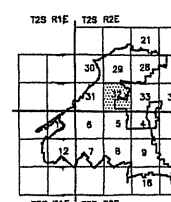

Wetland acreage

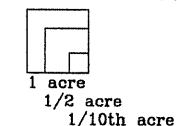

0 400 800  
FEET

JUNE  
1999

### WETLAND INFORMATION IS SUBJECT TO CHANGE

This map is for planning purposes only. Mapped wetland and riparian boundaries were not flagged or surveyed (unless noted as a delineation study). Boundaries for on-site verified wetlands are accurate to within 25'. There may be exceptions or unmapped wetlands subject to regulation. In all cases, actual field conditions determine wetland boundaries. If site alteration work is proposed, you are advised to contact the Oregon Division of State Lands or the U.S. Army Corps of Engineers with regulatory questions. This study was funded by an Oregon Department of Land Conservation and Development periodic review planning grant.

*City of Oregon City*

320 Warner Milne Road  
Oregon City, Oregon 97045

SHAPIRO  
INCORPORATED



APPROVED WETLANDS INVENTORY  
Oregon Division of State Lands  
Meets LU 3 standards  
Date 9/91 Approved by J. Moran

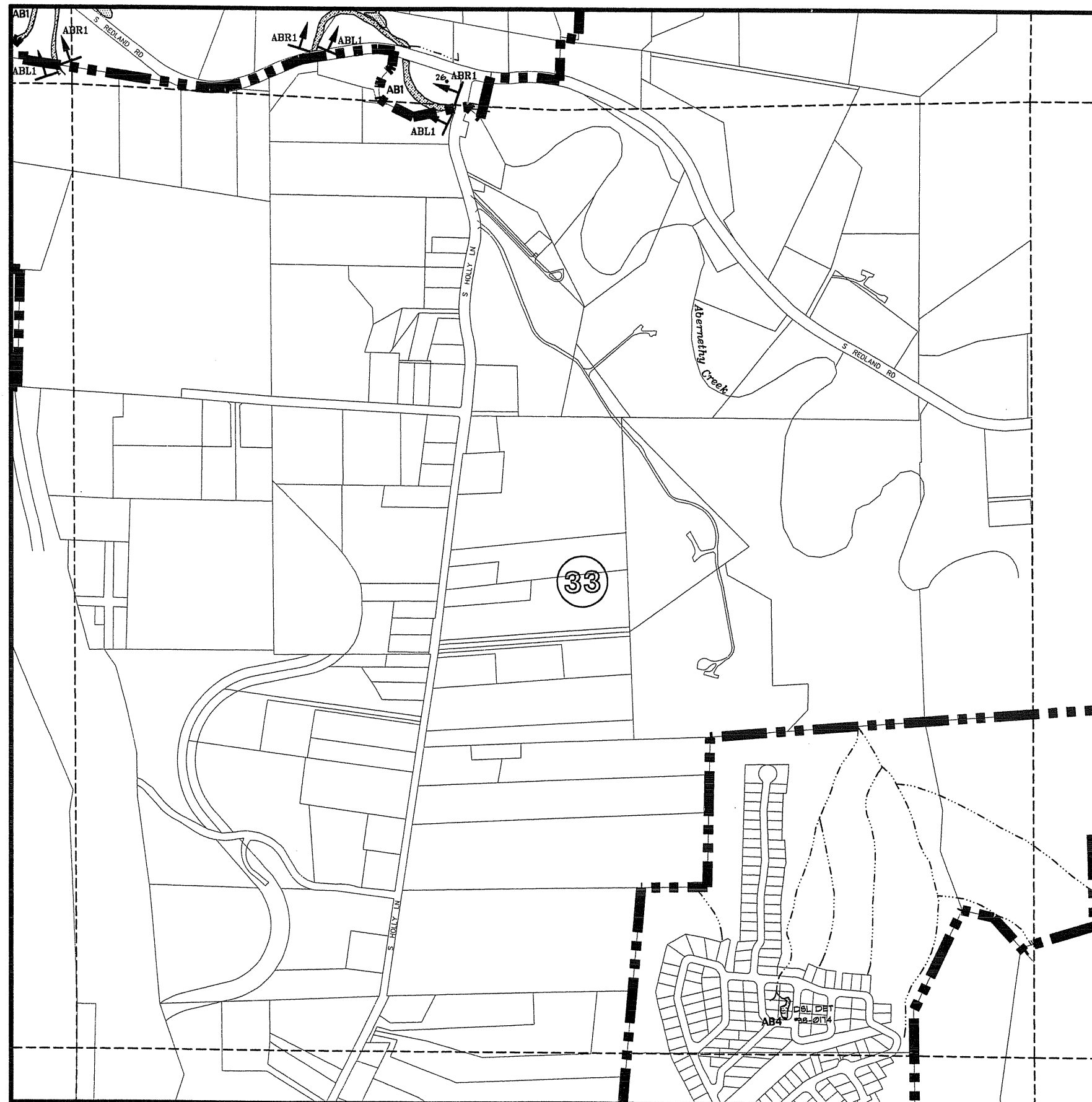

T 2S R 2E Section 33

## CITY OF OREGON CITY LOCAL WETLAND INVENTORY

### LEGEND

- Urban Growth Boundary
- Wetland
- Wetland label
- Riparian label
- Sample site
- DSL DET wetland
- DSL label
- Mitigation wetland
- Site access not granted
- Stream

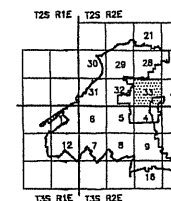

### Wetland acreage

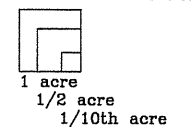

JUNE  
1999

### WETLAND INFORMATION IS SUBJECT TO CHANGE

This map is for planning purposes only. Mapped wetland and riparian boundaries were not flagged or surveyed (unless noted as a delineation study). Boundaries for on-site verified wetlands are accurate to within 25'. There may be exceptions or unmapped wetlands subject to regulation. In all cases, actual field conditions determine wetland boundaries. If site alteration work is proposed, you are advised to contact the Oregon Division of State Lands or the U.S. Army Corps of Engineers with regulatory questions. This study was funded by an Oregon Department of Land Conservation and Development periodic review planning grant.

*City of Oregon City*

320 Warner Milne Road  
Oregon City, Oregon 97045

SHAPIRO  
INCORPORATED



APPROVED WETLANDS INVENTORY  
Oregon Division of State Lands  
Meets L32 standards  
Date 7/99 Approved by J. Merlan

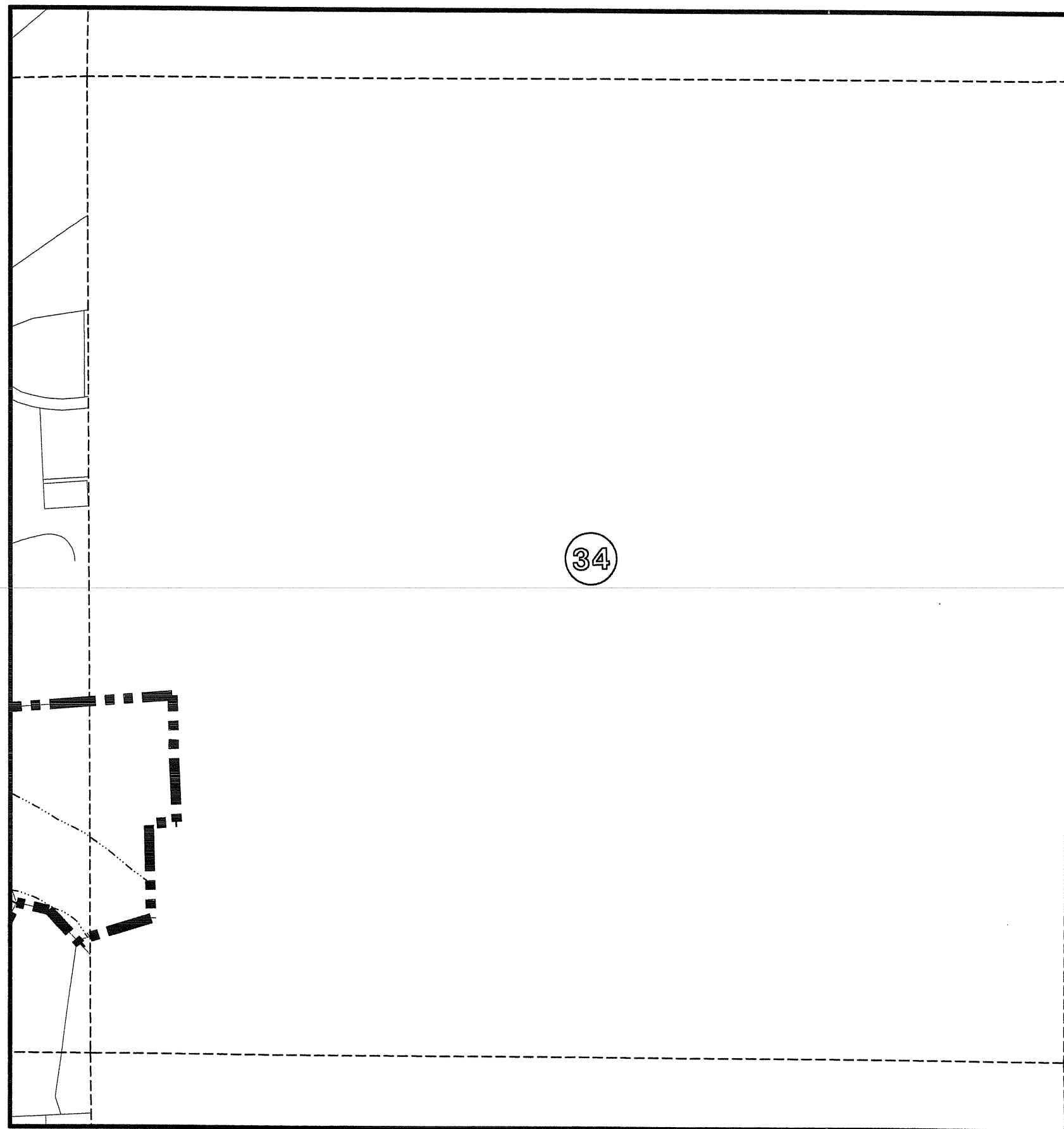

34

T 2S R 2E Section 34

# CITY OF OREGON CITY LOCAL WETLAND INVENTORY

## LEGEND

- Urban Growth Boundary
- Wetland
- AC2 Wetland label
- FCR1 Riparian label
- .46 Sample site
- DSL DET wetland
- DSL DET 931-0563 DSL label
- Mitigation wetland
- Site access not granted
- Stream

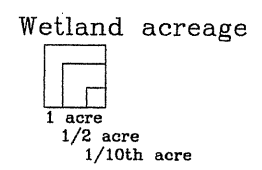
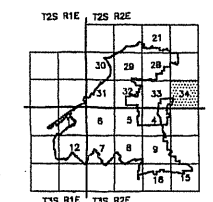

JUNE  
1999

### WETLAND INFORMATION IS SUBJECT TO CHANGE

This map is for planning purposes only. Mapped wetland and riparian boundaries were not flagged or surveyed (unless noted as a delineation study). Boundaries for on-site verified wetlands are accurate to within 25'. There may be exceptions or unmapped wetlands subject to regulation. In all cases, actual field conditions determine wetland boundaries. If site alteration work is proposed, you are advised to contact the Oregon Division of State Lands or the U.S. Army Corps of Engineers with regulatory questions. This study was funded by an Oregon Department of Land Conservation and Development periodic review planning grant.

*City of Oregon City*  
320 Warner Milne Road  
Oregon City, Oregon 97045

