

Taxlot Detail Report

Taxlot: 2-2E-27B -00400

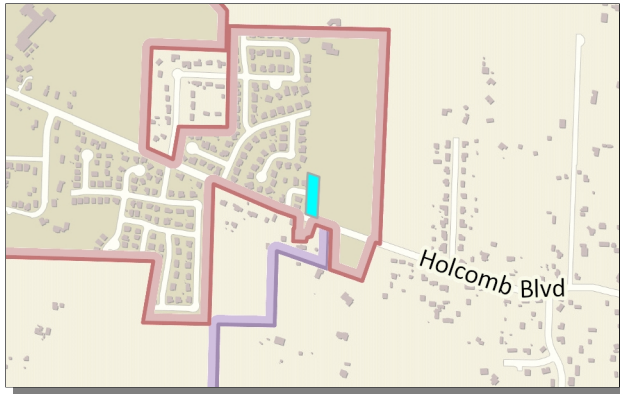

Overview Map

Taxlot Information

APN: 2-2E-27B -00400
Alt ID: 00555358
Site Address: 16260 JADA WAY
OREGON CITY, OR 97045
Year Built: 0

Taxpayer Information

Taxpayer: ABERNETHY LANDING LLC
Address: PO BOX 61426
VANCOUVER, WA 98666

Reference Information

Parcel Area (acres - approx): 0.9
Parcel Area (sq. ft. - approx): 38,332
Twn/Rng/Sec: 02S 02E 27
Tax Map Reference: 22E27B

Values

Values as of: 12/12/2017
Land Value (Mkt): \$189,288
Building Value (Mkt): \$0
Exempt Amount: \$0
Net Value (Mkt): \$189,288
Note: The values above are Market, NOT Assessed values.
Assessed Value: \$80,881

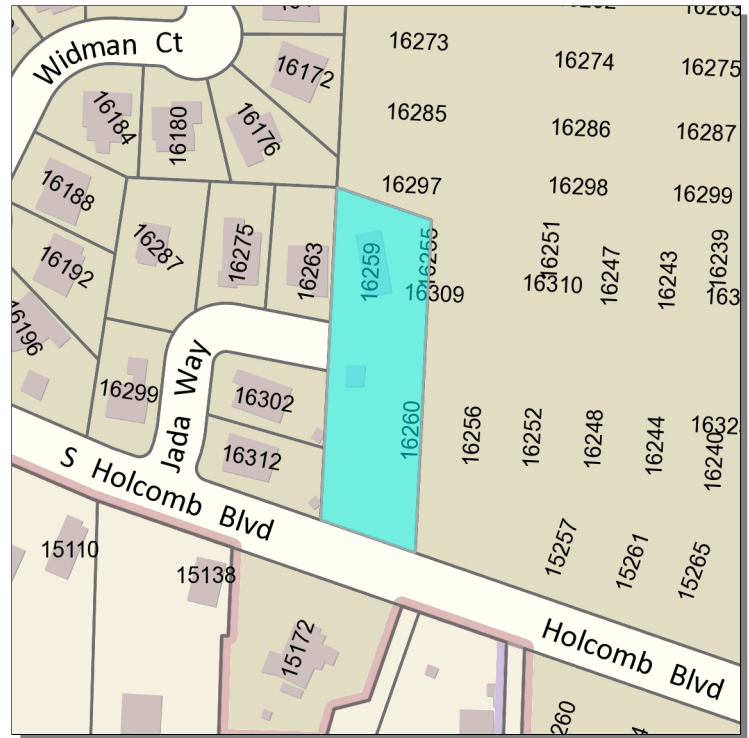

Taxlot highlighted in blue

Planning Designations

Zoning: R10
- 10,000 Single Family Dwelling District
Comprehensive Plan: Ir
- Residential - Low Density
Subdivision: NONE
PUD (if known):
Neighborhood Assn: Park Place NA
Urban Renewal District: Not in an urban renewal district
Concept Plan: Not in a concept plan area
Historic District: Not in a historic district
Historic Designated Structure? N
In Willamette Greenway? N
In Geologic Hazard? N
In High Water Table Area? N
In Nat. Res. Overlay District (NROD)? N
In 1996/FEMA 100 Yr Floodplain? N
In FEMA Floodway? N
In Sewer Moratorium Area? N
In Thayer Pond Fee Area? N
In Beaver Creek Rd Access Plan Area? N
In Barlow Trail Corridor? N

The City of Oregon City makes no representations, express or implied, as to the accuracy, completeness and timeliness of the information displayed. This map is not suitable for legal, engineering, surveying or navigation purposes. Notification of any errors is appreciated.

Report generated 6/27/2018 11:43 AM

City of Oregon City
PO Box 3040
625 Center St
Oregon City, OR 97045
(503) 657-0891
www.oregoncity.org

