



CANEMAH NEIGHBORHOOD ANALYSIS



ideasCollaborative
DESIGN | PLANNING | ARCHITECTURE
PORTLAND

COPYRIGHT ideasCollaborative, Inc. 2016

AriaTouch

making places that touch the human spirit

1001 SE Water Avenue, #130
Portland, Oregon 97214

TABLE of CONTENTS

Canemah Neighborhood	4
Historic Home Analysis	5-25
Home Analysis	27-35
Multi - Family Housing Analysis	36-38

CANEMAH NEIGHBORHOOD

The Canemah Historic District is located at the southwesterly edge of the city limits of Oregon City, on the southerly (rocky ledged) bank of the Willamette River, just above the Falls. The community lies within a crescent-shaped hollow in the basalt cliffs that rise to the south above the river. Its name is said to derive from a Native American word “kanim” for “canoe place” and it was the existence of a graveled beach that gave rise to the town’s establishment in 1845. Because of the falls, cargo and passengers had to be portaged at this point. The views, topography, and history create a deep sense of place within this community. The “gateway” as you approach Canemah along 99E both from the northeast and southwest, are long steep cliffs of basalt rock, one’s first exposure to the conditions of this place. The topography, geology and hydrology have created the uniqueness of this community in both positive and negative ways. Canemah is a historic landslide area. This knowledge is expressed through the widespread use of retaining walls (both basalt rock walls and concrete walls) throughout the entire neighborhood enabling the homes to be nestled up and down the hillside providing amazing views of the Willamette River and the Willamette Falls. These views have also given rise to the prevalence of first and second floor decks along with large window openings on the houses all along the hillside (both historic and non-historic). The retaining conditions have often been overgrown by ivy and moss making them less evident, creating a feeling of longevity and proof of the power of natural systems over man-made structures. To punctuate this message, as you walk through the neighborhood you hear the sound of running water cascading through the man made channels which are both beautiful and necessary to safely control the water flow of the hillside.



Northeast



Canemah



Southwest

Historic Homes

The Canemah Historic District has 61 contributing historic structures. This section does not include every historic home in the neighborhood, just a large sampling to understand the design elements of the Canemah historic home.

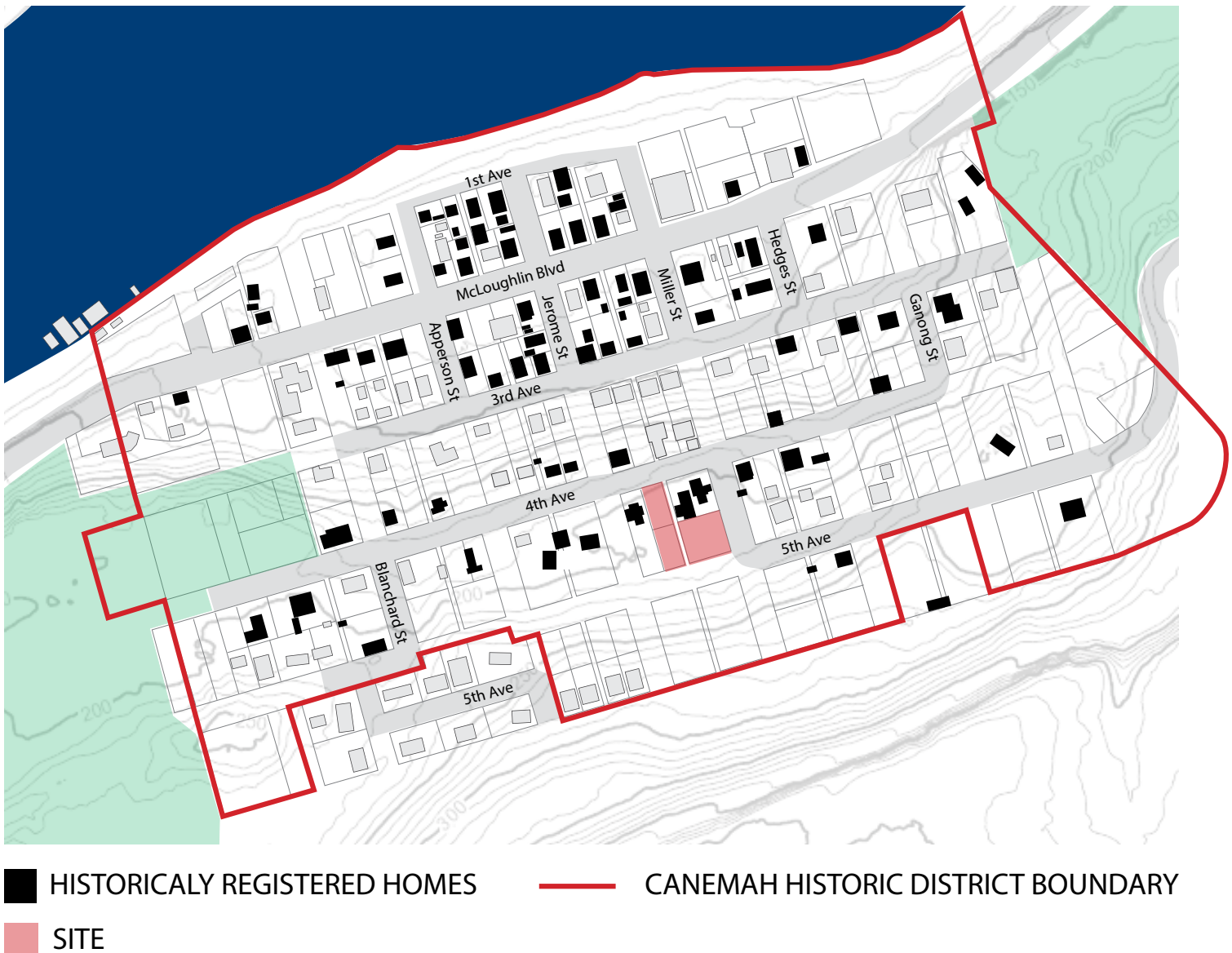

* all historic inventory information comes from Oregon Inventory of Historic Properties Historic Resource Inventory Form found on Oregon City's Canemah National Register District website: <http://www.orcity.org/planning/canemah-national-register-district>



702 4th Ave

Historic Home

1885

Vernacular Style

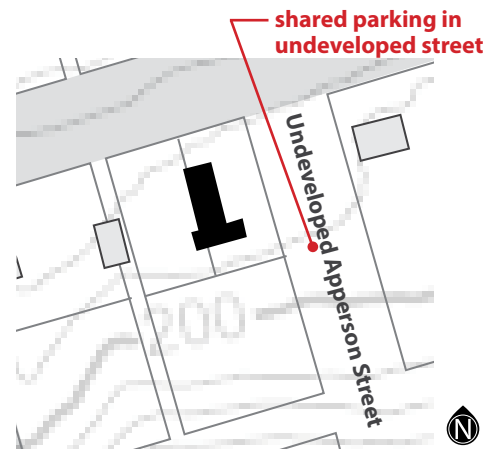

Covered front porch with simple raining. Columns simple forms. No ornamentation.



Large pervious parking lot area shared with neighbor in the undeveloped Apperson Street right of way.



Historic Inventory*:

2 Stories, no basement
Rectangular with Rear extension Plan
Wood Foundation
Wood Construction
Gable Roof
Windows: 1 over 1 Windows, 4 over 4 windows
Asbestos Shingles Siding (cover originals)
Pent-roofed with square posts with deocrative capitals, engaged with pilasters at house

Typical window types

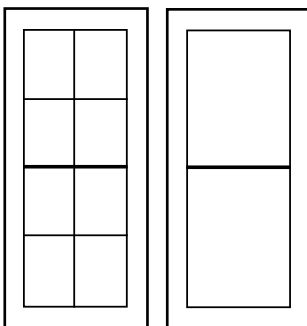



(A-1 & A-2) 502 4th Ave

Historic Home

1867

Vernacular Style

built in setback

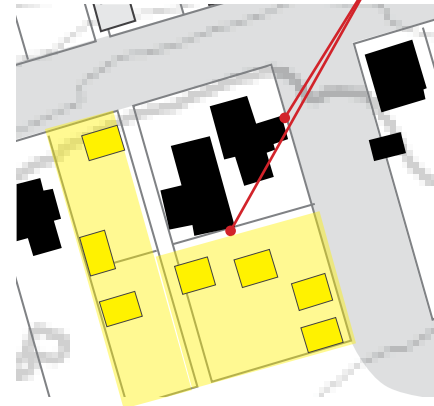

Higher density than proposed development



Dense Lot Coverage

Existing home with side addition built within East property line setback.

Additional barn/ADU with covered parking built within set back and lot density greater than allowed by current code.

Covered parking structure crosses property line.

Wide and long impervious paved parking area roughly 16 feet wide and 55 feet long. (880 square feet.) (Our proposed parking area is XXX)



Window types:

Many different types of windows on each of the (3) individual and separate house/building types on one property. (higher density than proposed development)

Housing types:

- (1) Main, historic home with additions
- (2) Side house
- (3) Barn/garage

Retaining Walls:

Multiple short basalt stone retaining walls around property and through the site.



Historic Inventory*: (main house)

2 Stories, no basement

L-Plan

Concrete Foundation

Wood Construction

Gable Roof

Windows: 6 over 1 Double Hung

Shiplap Siding

Pent-roofed porch with square posts, engaged square pilasters and decorative brackets



(H) 514 4th Ave

Historic Home

1922

Bungalow Style

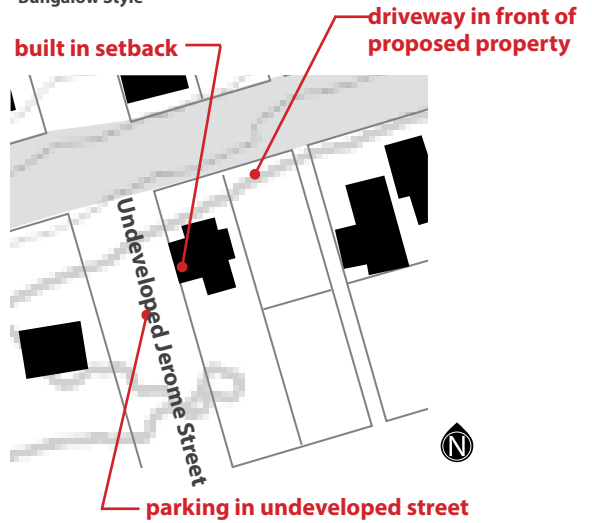

Bay of windows all along East facade of building turning the corner to the North of the building. This home has a many large window openings.

Basement with one window and exposed cement block foundation wall - painted brown to match the rest of the home to minimize appearance.

Typical window types

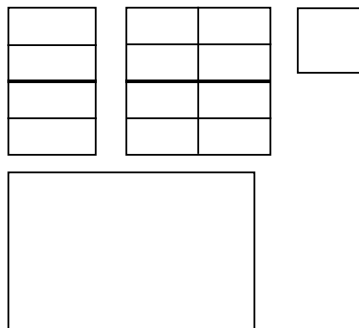

Large square window flanked with large rectangular windows on either side of front facade.

Large rectangular window on recessed front facade opening up the entire North facade to views and light.

Large front/side porch without canopy.

Shared parking in undeveloped Jerome Street

Driveway extends in front of proposed development's property and will have to be mitigated when development takes place

Historic Inventory*:

- 1 Stories, with basement
- Rectangular Plan
- Concrete Foundation
- Wood Construction
- Cross - Gable Roof, Front Gable enclosed
- Windows: Altered, 1 over 1 Windows, multipane enclosed porch
- Bevel Siding, Cornerboards
- Diagonally-braced purlins in gable ends





(E) 515 4th Ave

Historic Home

1916

Bungalow Style

built in setback



parking along 4th Street



Only parking for residence is along the side of the street. There is no parking on the site.



Due to environmental circumstances and site conditions home is built over the property line within setback.



Historic Inventory*:

1 1/2 Stories, no basement
 Rectangular Plan
 Concrete Foundation
 Wood Construction
 Gable Roof, central gable in the porch
 pent-roof on south
 Windows: 1 over 1 Windows double hung
 Shiplap Siding
 Diagonally-braced purlins and exposed rafters at gable

215 Miller Street

Historic Home

1862

Classic Revival



Parking in and along streetfront



Covered front porch

L-shapped home

On Street Parking



Historic Inventory*:

2 Stories, with basement
 Rectangular with extension Plan
 Exposed Stone Foundation
 Wood Construction
 Steep Pitched Gable Roof
 Windows: 6 over 6 double hung, simple molding
 Bevel Siding
 Paneled door, pent-roof with square posts,
 massive central chimney, cornice detail
 with detail architrave trim

Typical window types

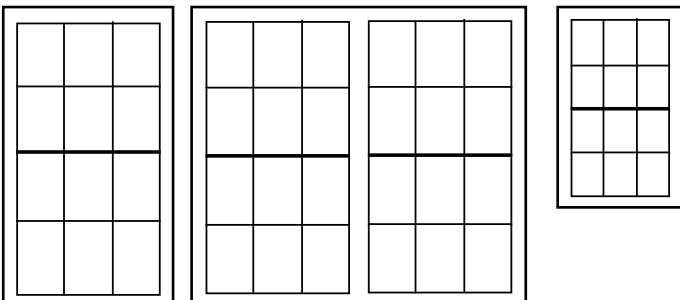

211 5th Ave

Historic Home

1889
Vernacular Style

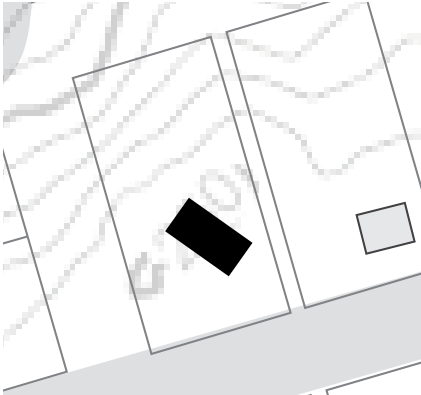

Parking lot space, Pull through driveway built in right of way

Built in grade
Site retaining wall built along the side of the house

Large rectangular windows hung along the front and side of the home.

Windows hung side by side creating a larger square shaped openings along the front and side facades of the home.



Historic Inventory*:
2 Stories, with basement
Rectangular with extension Plan
Concrete Foundation
Wood Construction
Gable Roof
Windows: 4 over 4 double hung
Shiplap Siding, wide rakeboards
single-bay gabled entry with return cornice and battered columns (added 1929), full length pent roof porch (added 1905) with square posts over concrete block

Typical window types

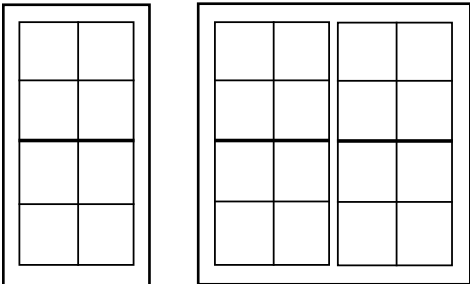

405 4th Ave

Historic Home

1890

Vernacular Style

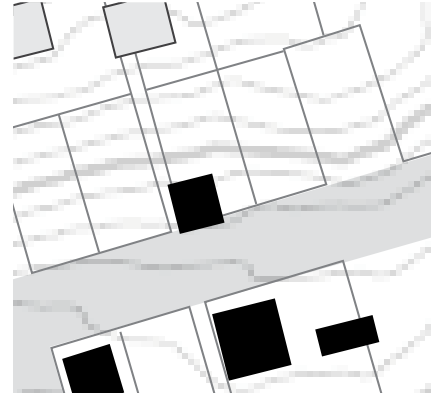

2nd Floor Porch

2nd Floor Porch

On Street Parking

Due to environmental circumstances is built over the property line



Historic Inventory*:

2 Stories, with basement
Rectangular Plan
Concrete Foundation (alteration, added 1944)
Wood Construction
Gable Roof
Windows: new aluminum windows - some original molding remains
T-1-11 Siding (alteration)
Deck (alteration) , Sliding Glass Door (alteration), Metal Chimney



416 4th Ave

Historic Home

1895

Vernacular Style

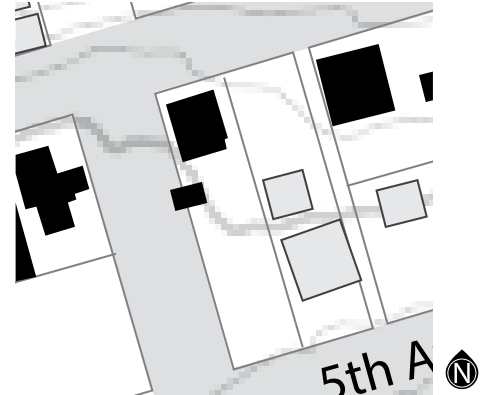

2nd Floor Porch



Built on setback with garage built over setback within the right of way of the road.

Parking is located along the side of the right of way along with an additional parking area behind the main house,



Historic Inventory*:

2 Stories, with basement
 Rectangular Plan
 Concrete Foundation
 Wood Construction
 Gable Roof with Pent Roof Porch
 Windows: 4 over 1 double Hung
 Shiplap and Shingle Siding
 Exposed Rafters, Diagonally- Braced
 purlins in gable ends, brick chimney

606 4th Ave

Historic Home

1865

Saltbox

Historic Inventory*:

1 1/2 Stories, no basement

Rectangular Plan

Concrete Foundation

Wood Construction

Gable Roof

Windows: 4 over 4 double hung,

Masonite Shingle Siding, wide rake and cornerboards

Classically style columns at front porch, exposed rafters on Pent Roof extension

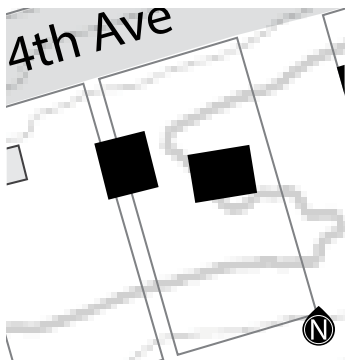

210 Hedges St

Historic Home

1911

Vernacular Style

Historic Inventory*:

2 Stories, with basement

Rectangular Plan

Concrete Foundation

Wood Construction

Gable Roof

Windows: 1 over 1 double hung, Diamond shaped windows

Shiplap Siding, corner boards, Rakeboards
Original Brick Chimney, pent-roof porch with turned posts, picket balustrade on front porch

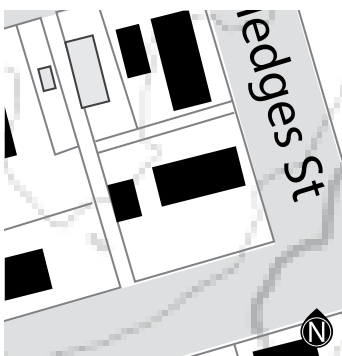

Multiple sizes shapes of windows



310 3rd Ave

Historic Home

1864

Colonial Revival, Saltbox

Historic Inventory*:

1 1/2 Stories, no basement
 Rectangular Plan
 Concrete Foundation
 Wood Construction
 Moderately pitched Gable Roof
 Windows: original 6 over 6 windows, some 1 over 1, multi-pane fixed
 Clapboard Siding

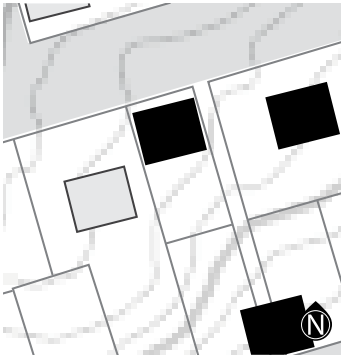

509 3rd Ave

Historic Home

1920

Bungalow Style

Historic Inventory*:

1 1/2 Stories, with basement
 Rectangular with extension Plan
 Concrete Foundation
 Wood Construction
 Gable Roof
 Windows: 1 over 1 double hung
 Bevel Siding
 Diagonally braced purlins

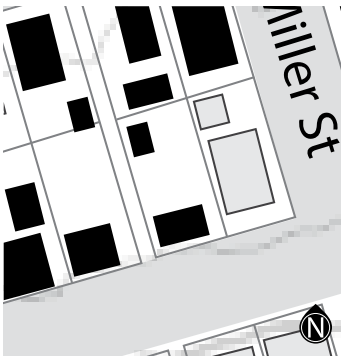

- On Street Parking
- Due to environmental circumstances is built over the property line

605 3rd Ave

Historic Home

1911
Vernacular Style



Vertical Siding



2nd story balcony on back of house



On Street Parking

The home is built on the property line with parking directly in front of the entrance within the side street.



Historic Inventory*:

2 Stories, with basement
Rectangular Plan
Concrete Foundation
Wood Construction
Gable Roof
Windows: Aluminum, Diamond shaped windows
Vertical Board Siding
Pent-roofed wraparound porch with some chamfered posts, brick chimney



609 3rd Ave

Historic Home

1907
Vernacular Style



On Street Parking

Home is built on the property line with parking in front of the home along the side of the street. Within the setback.

Historic Inventory*:

- 1 Stories, with basement
- Rectangular Plan
- Concrete Foundation
- Wood Construction
- Gable Roof, Pent-roof porch
- Windows: Alumnium
- Masonite Shingle
- Square Post with ornamental capitols



402 S. McLoughlin Blvd.

Historic Home

1828

Classic Revival Style



Dense lot coverage
(more dense than proposed development)

New additions to house



Multi car parking area off Hedges Street
(impervious parking along street with no planting buffer 6 90degree parking spaces with additional cars parked parallel to road)

Unique long skinny windows



Historic Inventory*:

2 Stories, with basement
Rectangular Plan with Recent addition
Concrete Foundation
Wood Construction
Low-Pitch Gable Roof
Windows: Multi-pane double hung
6/6 and 8-pane
Multi-pane French doors lead to balcony
Deck (alternation) , French doors
(alternation) Two story addition to east
(1970's)



216 3rd Ave

Historic Home

1918
Bungalow Style

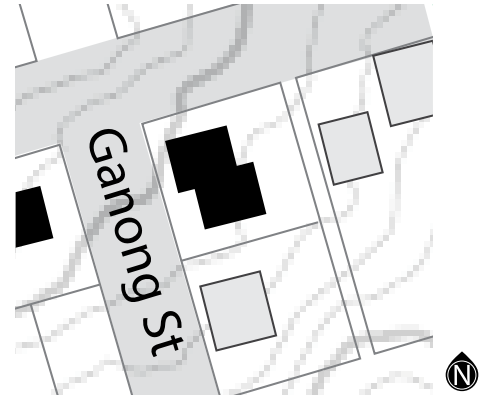

2nd Floor Porch



Various Window Styles

2nd Floor Porch



Pervious Large Parking area
directly off of the street.

No planting buffer.



Historic Inventory*:

2 Stories, no basement
Square Plan
Concrete Foundation
Wood Construction
Hipped Roof
Windows: Various, with various nubers of
small panes above one large pane, some
casement windows
Bevel Siding with cornerboards
unusual window trim, one story shed roof
addition to north

814 4th Ave

Historic Home

1950

Rest Home, Nursing Home

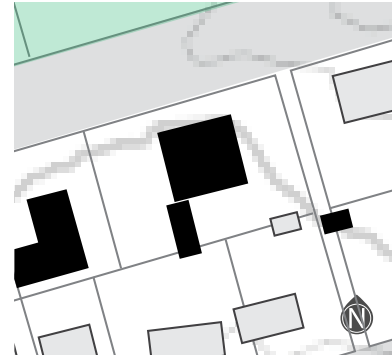

Pull through driveway and parking

Retaining wall/Basement
Foundation Wall

2nd story porch



Historic Inventory*:

1 1/2 Stories, with basement
Irregular Plan
Concrete Foundation
Wood Construction
Hip Roof with low pitched gable
Windows: Squat Double hung
Masonite Single Siding, Batten-sided
Shed roof with exposed rafters, vertical
balustrade and square posts



711 3rd Ave

Historic Home

1938

Tract

Historic Inventory*:

1 Story, no basement
 Rectangular Plan
 Concrete Foundation
 Wood Construction
 Shed Roof
 Windows: Multi-pane fixed, some Double hung
 Masonite Single Siding

715 3rd Ave

Historic Home

1935

Vernacular Style

Historic Inventory*:

1 Story, no basement
 Rectangular Plan
 Concrete Foundation
 Wood Construction
 Gable Roof
 Windows: Aluminum Sliding Windows
 Masonite Single Siding



Built into the earth

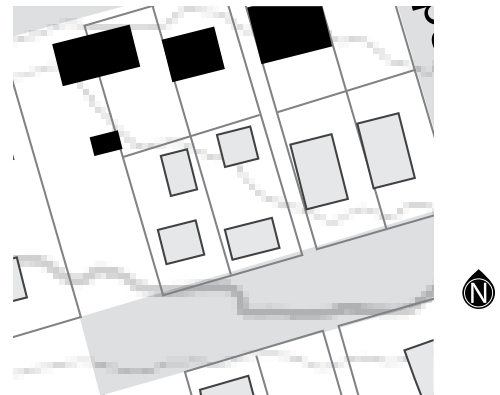



207 4th Ave

Historic Home

1895

Vernacular Style

Historic Inventory*:

2 Stories, with basement
Rectangular Plan
Concrete Foundation
Wood Construction
Gable Roof
Windows: 1 over 1 with narrow trim
Masonite Single Siding over original
Shiplap siding

On street Parking

Built over the property line

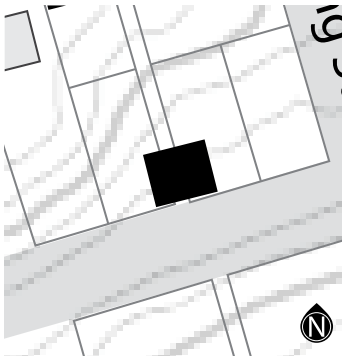

2nd Floor Porch

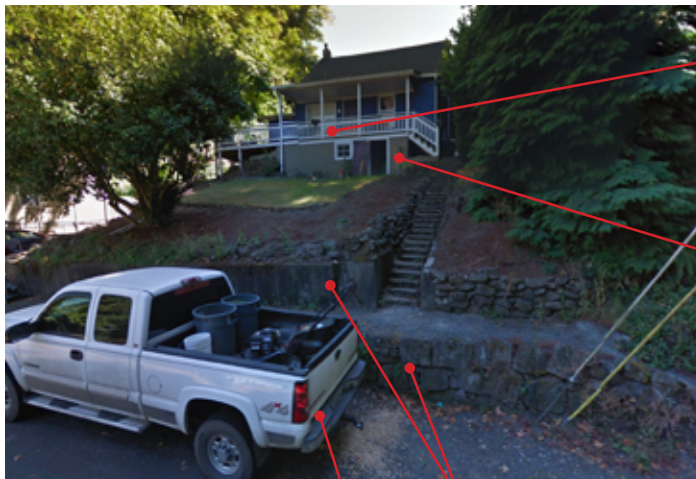

large wrap
around upper
story porch
- partially
covered

bottom floor
opening
built into the
hillside with a
large concrete
foundation
exposed

stepping back retaining
walls to height of 8 feet

parking in front of
house off street

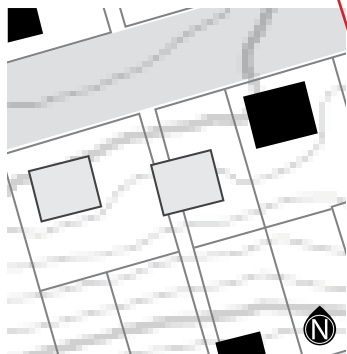

2nd Floor Porch

408 3rd Ave

Historic Home

1866

Vernacular Style

Historic Inventory*:

1 1/2 Stories, with basement
Rectangular with extensions Plan
Concrete Foundation
Wood Construction
Slightly bellcast Gable, Pent Roof Porch
Windows: variety, multi-pane, 6 over 1
double hung, 1 over 1
Masonite Single Siding over original bevel
siding
decorative "x" pattern balustrade, porch with
square posts

202 5th Ave

Historic Home

1933

Post WW1 Vernacular Style

Historic Inventory*:

1 Stories, no basement
Square Plan
Concrete Foundation
Wood Construction
Low Pitch Cross-Gable Roof
Windows: Geometric muntin-mullion design
Single Siding

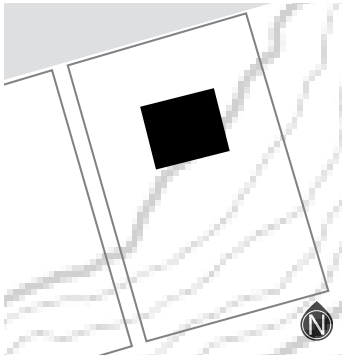



214 Jerome Street

Historic Home

1915

Bungalow

Historic Inventory*:

1 Stories, no basement
 Rectangular Plan
 Concrete Foundation
 Wood Construction
 Gable Roof
 Windows: mostly fixed windows
 Shiplap Siding, cornerboards bevel siding at front

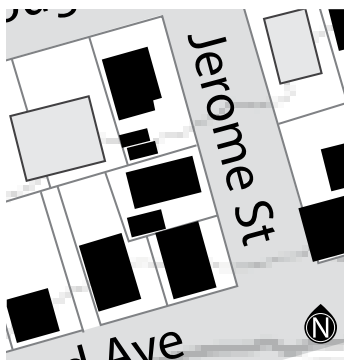

215 Jerome Street

Historic Home

1858

Gothic Revival

Historic Inventory*:

2 Stories, no basement
 Square Plan
 Concrete Foundation
 Wood Construction
 Steeply-pitched Gable Roof
 Windows: multi-paned double hung with simple molding
 masonite shingles over original siding

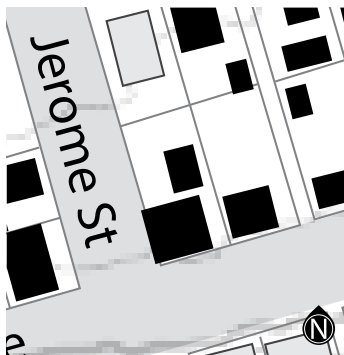

216 Jerome Street

Historic Home

1898

Vernacular Style

Historic Inventory*:

1 Stories, no basement

Rectangular Plan

Concrete Foundation

Wood Construction

Gable Roof

Windows: aluminum replaced double hung

Masonite Shingles over original siding

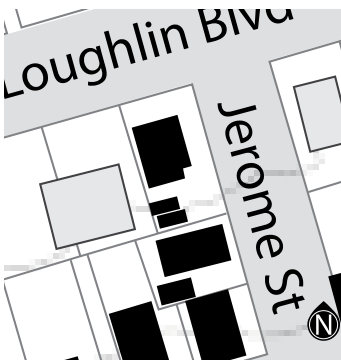

416 S McLoughlin Blvd

Historic Home

1867

Gothic Revival

Historic Inventory*:

2 Stories, with basement

Rectangular with Addition Plan

Concrete Foundation

Wood Construction

High Pitched Cross-Gable Roof

Windows: narrow 1 over 1 Double Hung

with Elaborate Architrave trim

Bevel Horizontal Board siding

Gothic arched door on second story,

leading to balcony with jig-sawn

balustrade, 2 brick chimneys

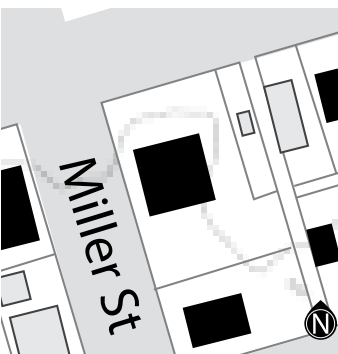

Second Story balcony

Non Historic Homes

(J)

421 5th Ave



extended roof overhang
providing cover for porch

exposed stepping up
foundation from bottom
level to main level of
home

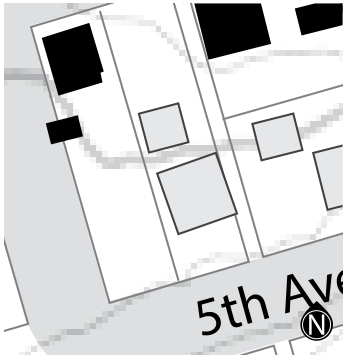

Extended roof overhang providing cover for porch
Home built into side of hill with stepping up foundation
around bottom level of the home.



605 4th Ave



Second Story Porch on rear of house

501 and 507 4th Ave

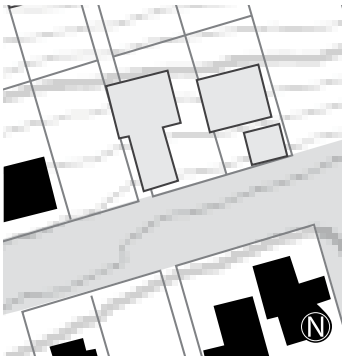

Large retaining wall
Off street parking

601 4th Ave



extended roof overhang
providing cover for porch

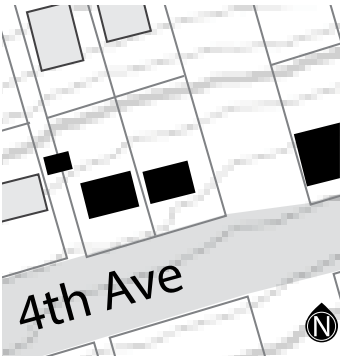

Parking Directly off road
Extended roof overhang creating cover for front porch.

614 3rd Ave

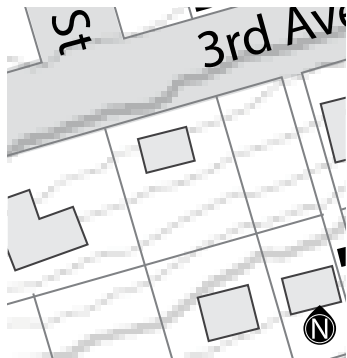

2nd Floor Porch

Uncovered upper level porch.

Home built within the side of the hill with retaining walls along the sides of the home

502 and 506 3rd Ave



Roof overhang extending 5+ feet with no column support

Second floor balcony over first level



2nd Floor Porch

Retaining wall

Second Story Porch

Roof overhang extending over porch 6+ feet with no column support

316 3rd Ave



extended roof overhang
providing cover for porch

large front facade window
openings

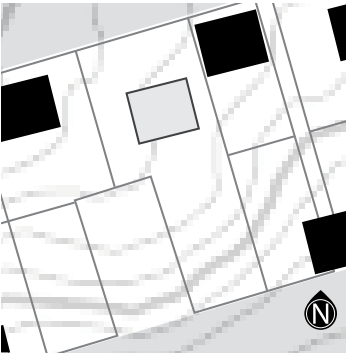

2nd Floor Porch

Roof overhang providing cover for front porch
Large open windows along entire first level

704 3rd Ave

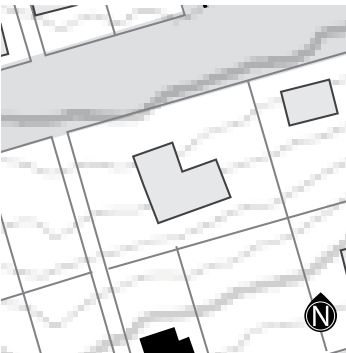

2nd Floor Porch

Retaining Walls
Multiple tall stone retaining walls stepping back from the front
of this property.

716 3rd Ave



Upper level balcony
covering first level

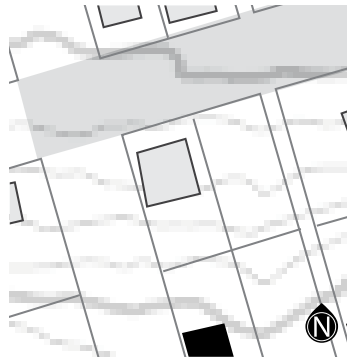

Second story porch

510 & 514 3rd Ave



Upper level balcony
covering first level

Tall concrete retaining
wall (6') in front of home

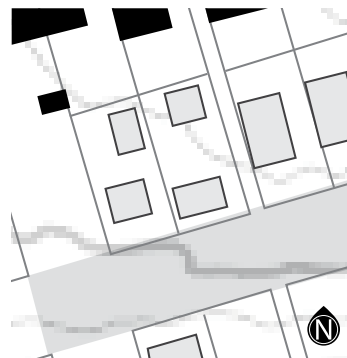

Parking at the street level
2nd story porch
Retaining Wall

611 & 615 4th Ave



On street parking
Large parking lot area
Large, suspended balcony porches off the upper levels of the home

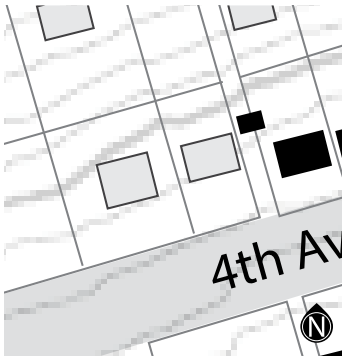

Large parking area



Suspended balcony porches off of upper levels

402 5th Ave



Tall concrete retaining wall foundation

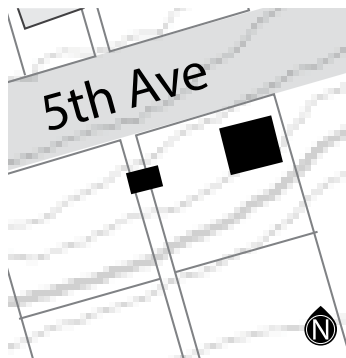

Raised porch



408 4th Ave

Home

1900

HISTORIC OR NOT??

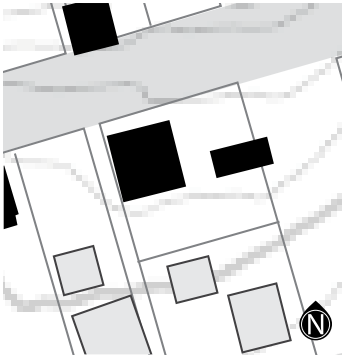

Write about the unique condition of this house



606 3rd Ave

Upper level balcony
covering first level

Tall concrete retaining
wall

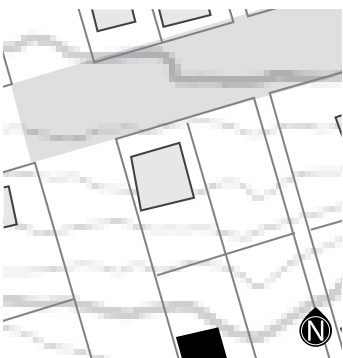

Second story porch
Retaining Wall

516 Jerome St.

XXXXXX



Large window for views

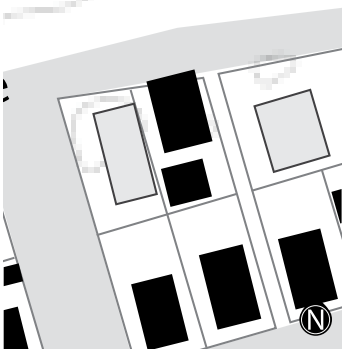

915 3rd Ave

Built into the landscape

2nd story porch

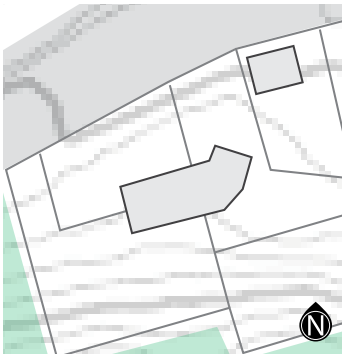

801 3rd Ave

Apartment Complex



Upper level balcony
covering first level



Tall concrete retaining
wall

Large Parking area



Parking Lot

Parking Lot

205 3rd Ave

Apartment Complex



Upper level balcony
covering first level

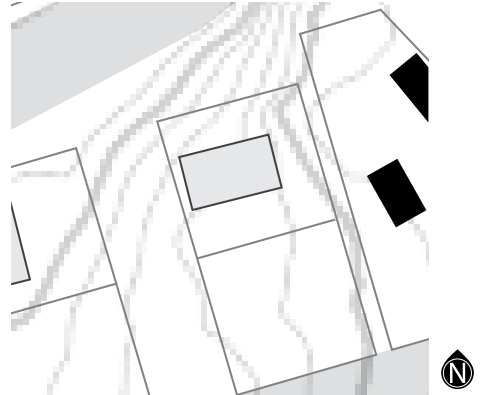

Large Parking area

Parking Lot



Parking Lot

Multi-Family Homes

302 S McLoughlin Blvd

Apartment Complex

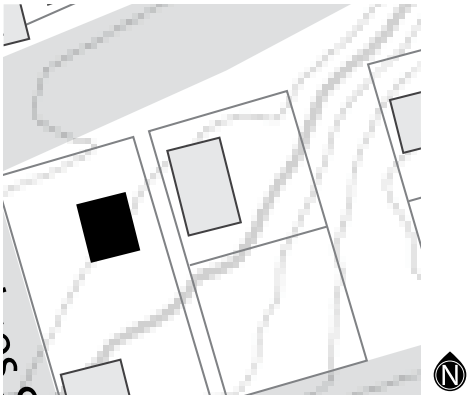

Upper level balcony covering first level

Tall concrete retaining wall

Large Parking area



Parking Lot



Parking Lot

