



**OREGON
CITY**

625 Center Street | PO Box 3040 | Oregon City OR 97045
Ph: (503) 657-0891 | Fax (503) 657-7892

Oregon City Metro Enhancement Grant Exit Report

This form is to be filled out within 30 days of completion of the Metro Enhancement grant project. Please limit responses to the space provided. If available, please attach an event photo and any promotional material samples (advertisements, flyers, posters, etc.)

When complete please submit to Michele Beneville at City Hall, 625 Center Street. Failure to provide this final exit report will make project Sponsor ineligible for future Metro Enhancement grants.

Project Title THE ENHANCEMENT PROJECT STRAIGHT HISTORIC CEMETARY

Organization EARTH CRUSADERS and PARK PLACE NEIGHBORHOOD ASSOC.

Project Coordinator JERRY HERRMANN and LINDA VANHAVERBEKE PHONE 503-260-3432

Email jerry.herrmann@birdlink.net

1. Brief project description:

PROJECT PROPOSED TO INVOLVE OREGON CITY Junior ROTC and community volunteers in upgrading the entire 8,000sqft area of pioneer cemetery founded by Hiram Straight and family (Wagon Train Emigrants of 1843). Fifty (50) graves exist in this area with some twenty (20) identified.

The project was designed and executed to: reduce overall annual maintenance requirements through massive mulching; beautify the site with up to 150 additional plantings; involve and educate youth.

2. Description of project accomplishments:

200 total plantings were installeda carefully set out ever-green screen was established to curtail traffic issues adjoining the site***fourty youth were involved in this project and assisted in upgrading Oregon City's Downtown street trees and vegetated areas in our ADOPT A SPACE PROGRAM that we do for each Metro Enhancement, Marine Board, or Oregon Youth Conservation grant program.

3. Measures of performance (i.e. number of people served; effects of the project):

WE EXPECTED UP TO FOURTY YOUTH but in fact had over 60 total youth working side by side with other community members (TOTAL INVOLVED OVER 15 weekends of project duration)

ALL AREAS OF BEAUTIFICATION, SCREENING and planting were acheived. Over 80 yards of mulches and soil amendmets wer applied.

A CONCLUDING DEDICATION . EVENT (May 10th) produced a salmon bake and youth presentations and tours for 25 persons from the community attending...THIS EVENT WAS PRODUCED and EXECUTED ENTIRELY BY OREGON CITY JROTC YOUTH and some Park Place Neighborhood Association members.

4. List additional sponsors of the project:

COFFMAN EXCAVATING CLACKAMAS LANDSCAPE SUPPLY
OREGON CITY PARKS AND RECREATION EARTH CRUSADERS
PARKPLACE NEIGHBORHOOD ASSOCIATION TONY's FISH MARKET
ALL SPONSORS came through as planned!

5. How were Metro Enhancement grant funds spent?

FUNDS WERE USED TO:

- purchase plantings, mulches, soil amendmets and fertilizers
- print work assignments and volunteer mobilization materials
- supervise 15 weekends of work
- assemble support materials; maintain accurate records of purchases, stipends for youth and all related youth and community organization

6. Final budget:

Suggested List (not inclusive)	(A) Metro Grant Dollars	(B) Matching Funds (Cash)	(C) In-Kind Matching	(D) Total
Personnel Services (salaries, administration)	\$ 350	\$ 400 (EC)	\$ 2500	\$ 3250
Project Administration costs (clerical, advertising, graphics, printing, postage)	\$ 1000	\$	\$ 1200	\$ 2200
Materials	\$ 1250	\$	\$ 1800	\$ 2800
Equipment/Supplies	\$ 353	\$	\$ 3000	\$ 3353
Construction Costs (plants and related)	\$ 2000	\$	\$ 950	\$ 2950
Event Costs (youth supervision)	\$ 950	\$	\$ 350	\$ 1300
Transportation Costs	\$	\$	\$	\$
Insurance Costs (if needed)	\$ 1330	\$	\$	\$ 1330
Additional Expenses (list) Youth stipends Rite O Way permit	\$ 1270 NOT REQD	\$	\$ 1000	\$ 2270
Totals	\$ 8473	\$ 400	\$ 10800	\$ 19673

STRAIGHT CEMETARY FINAL REPORT
REPORT-PERIOD MARCH thru MAY
2014

MARCH Continued weed control and mulching of site
application of fertilizers to stock

Staking and stabilizing of all plant selections
including evergreen hedge plants

APRIL Planting of site with donated stocks and
purchased stocks; re-mulching to
avoid losses due to severe heat event

Preparation of site for dedication event;
initial scheduling of event for City Commission
date of May 6th; rescheduling of event for
Saturday May 10th 4pm to 6pm; 30 persons
invited

MAY Final plantings placed; continued weed control
to ready site for dedication and open house

Students (ROTC) and Crew Leaders from Earth
Crusaders prepare for educational presentations
for day of dedication

MAY 10th DEDICATION and OPEN HOUSE; Indian style Salmon
Bake and foods supplied by Park Place Neighborhood
Assoc and Earth Crusaders

25 persons attend

SEE ATTACHED DEDICATION INFORMATION ATTACHED

Straight Pioneer Cemetery

Hiram Aldrich
Straight and his
wife, Susan
Lasswell
Straight, came
to Oregon by
wagon train

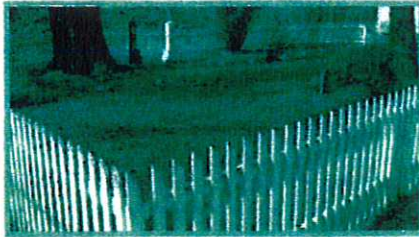

during the Great Migration of 1843. The parcel of land which the cemetery occupies is part of a 600 acre government land claim settled in 1844. Hiram Straight was elected to the pre-territorial provisional government in 1845 and 1846. He was foreman of the jury which convicted the Indians responsible for the Whitman massacre of 1847 near what is now Walla Walla, Washington. The trial was held in Oregon City. In 1856 Hiram Straight was elected as representative to the legislature of the Oregon Territorial Government. In 1892 Hiram Straight and members of his family dedicated this cemetery, where both Hiram, who died in 1897, and Susan, who died in 1883, are buried, as are several of his children and many grandchildren.



There are approximately 50 graves in the cemetery, but we are able to document only 15 with names and dates. The grave yard was in very poor repair until 1982 when the "Posy Pickers Garden Club" took over its restoration. In September of 1982, the club rededicated the

cemetery and placed the historical marker. Restoration was done again in 2003 by Park Place Neighborhood Association and the Oregon City Parks Department.



1800

- 1806 A party of Astorian fur traders are the first whites in the vicinity
- 1829 An epidemic of "Intermittent Fever" breaks out; Native American population hardest hit
- 1843 The first wagon train arrives, with Straight family, Cason family, and Charles Pickett, among others
- 1844 The Straight family moves onto their claim
- 1846 The Hunsaker family arrives; Pickett departs for California
- 1849 Christmas flood washes away Clackamas City
- 1851 The Clackamas nation signs treaty with the Indian Superintendent, Anson Dart, to relinquish their lands, though they do not agree to move
- 1853 Hunsaker builds a bridge over the Clackamas River near High Rocks; he sells it to Fendel Cason the following year
- 1856 All Native Americans in the Oregon City area are removed by military force to the Grande Ronde Reservation; third Hiram Straight house is built
- 1868 A paper mill is built on the bank of the Clackamas River, stimulating growth of a community that would be called Park Place
- Susan Straight dies 1883
- The plat for Park Place is officially filed 1889
- Hiram Straight dies 1897

1900

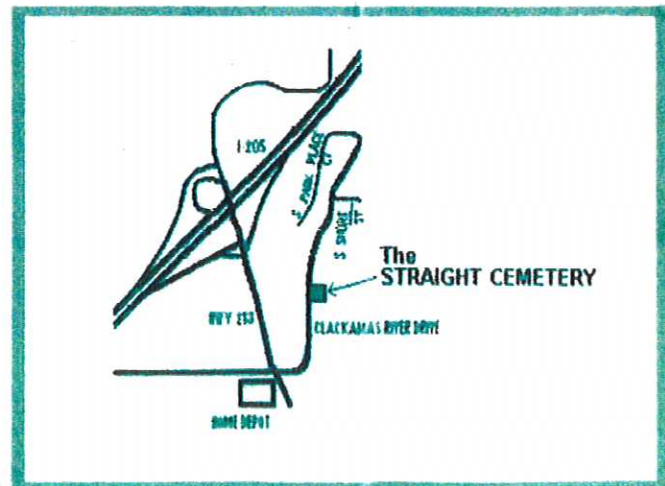

The Straight Cemetery
13014 S. Clackamas River Dr, Oregon City, OR 97045

PROJECT
OVERVIEW
SITE WORK

\$ 5500 in donated materials and supplies
450 hours of community service by JROTC youth
5,000 soft Rehabilitation and New Plantings

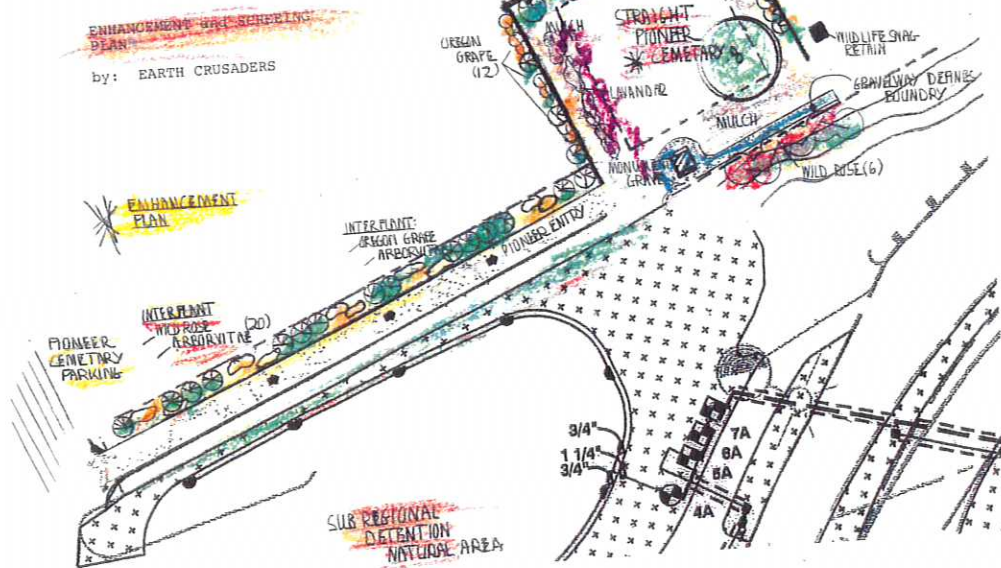

CREW LEADERS and CREW MEMBERS sponsored
by Earth Crusaders and Oregon Youth Conservation
Corps



Oregon City School District Junior ROTC
youth crew members 15 weekends 2013-14