

CITY OF OREGON CITY

GRADING, DRAINAGE, PAVING, SIGNING, ILLUMINATION, SIGNALS & ROADSIDE DEVELOPMENT

MOLALLA AVENUE PHASE 3: BEAVERCREEK ROAD TO OR 213

MOLALLA AVENUE
MARCH 2020

BEGIN PROJECT
STA. "M" 30+48.00

END PROJECT
STA. "M" 87+13.70

SEC. 5 & 8, T. 3 S., R. 2 E., W.M.

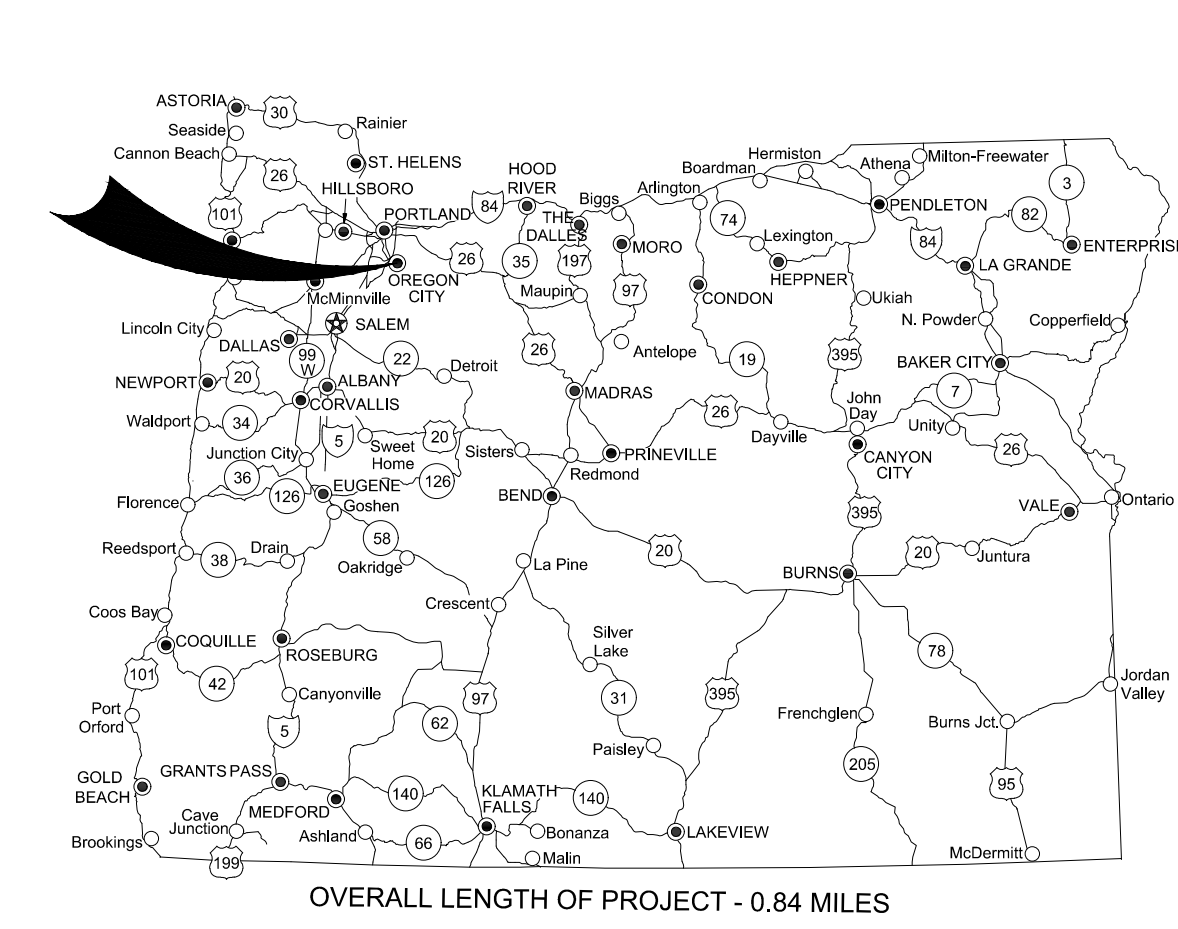
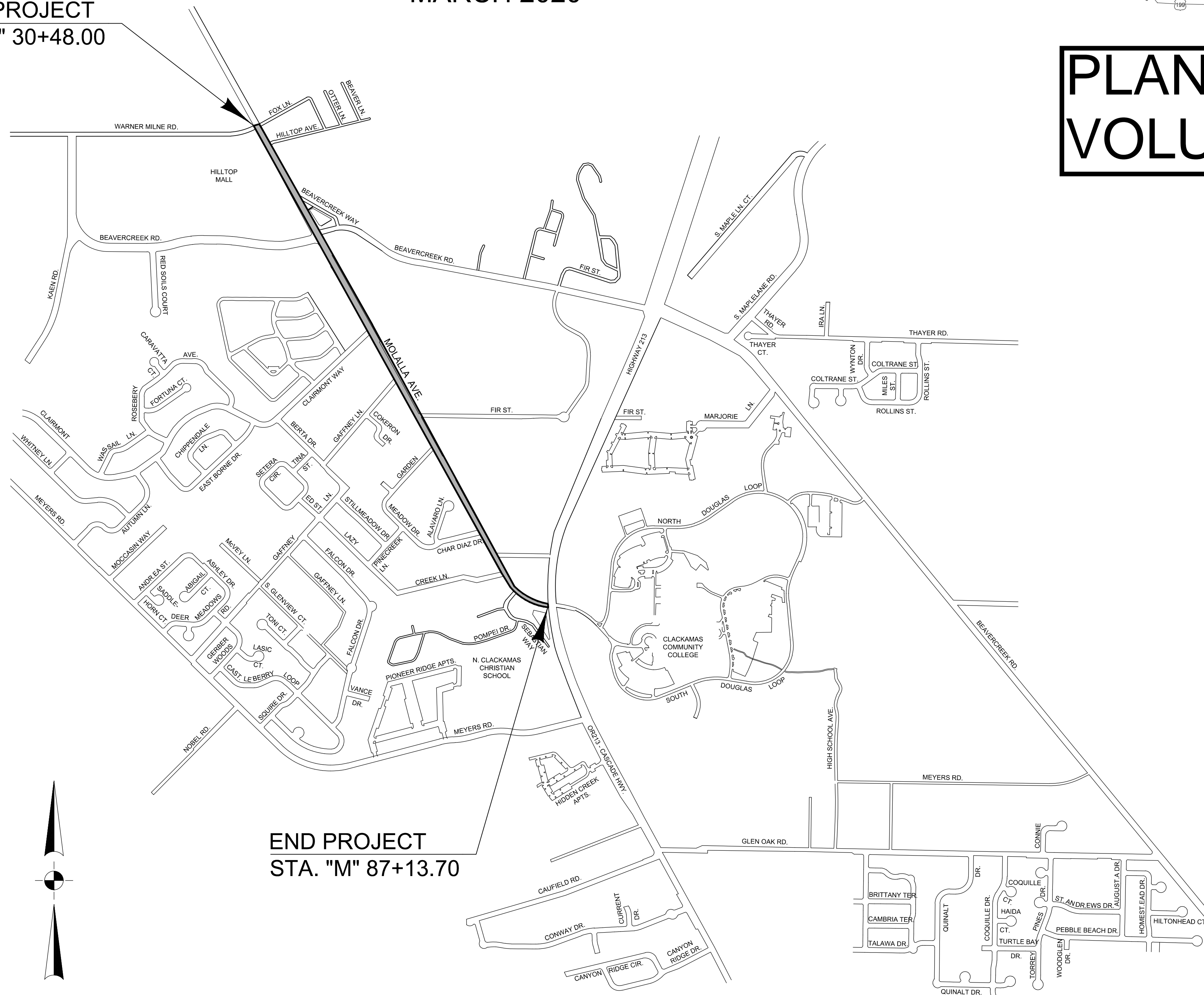

OVERALL LENGTH OF PROJECT - 0.84 MILES

**PLANS:
VOLUME 2 OF 4**

INDEX OF SHEETS	
SHEET NO.	DESCRIPTION
1	TITLE SHEET
1A	SHEET INDEX CONTINUED & STD. DWG. NOS.
1A-2	MOLALLA AVE. SHEET LAYOUT PLAN
1A-3	GENERAL NOTES
1A-4	GENERAL NOTES CONTINUED

REGISTERED PROFESSIONAL ENGINEER
64332
Amy L. Jones
OREGON
NOVEMBER 14, 2000
EXPIRES: 06/30/2021

DOWL
SUBMITTAL DATE: Feb. 12, 2020
DRAWN BY: CITY, Wilhelm
PROJECT NO: 517010
DESIGNED BY: Nick Reid
SCALE: AS SHOWN

OC PROJECT #: CI 18-004
MOLALLA AVENUE PHASE 3: BEAVERCREEK ROAD TO OR 213
MOLALLA AVENUE
CLACKAMAS COUNTY
TITLE SHEET

REV. NO.	DATE	DESCRIPTION



CITY OF OREGON CITY
PUBLIC WORKS DEPARTMENT
APPROVAL FOR CONSTRUCTION

APPROVED AS SUBMITTED
 APPROVED AS NOTED IN RED

SIGNATURE
NAME: _____
DATE: _____

BID DATE: 02/21/2020
OC RECORD DRAWING#:

DRAWING NUMBER:
1

ATTENTION !
OREGON LAW REQUIRES YOU TO FOLLOW RULES ADOPTED BY THE OREGON UTILITY NOTIFICATION CENTER. THOSE RULES ARE SET FORTH IN OAR 952-001-0010 THROUGH OAR 952-001-0100. YOU MAY OBTAIN COPIES OF THE RULES FROM THE CENTER OR ANSWERS TO QUESTIONS ABOUT THE RULES BY CALLING (503) 232-1987.