

CHANGE ORDER

DATE OF ISSUANCE 2/8/2019 EFFECTIVE DATE No. 4  
2/8/2019

PROJECT: 2018 Water System Improvements

OWNER City of Oregon City

CONTRACTOR Trench Line Excavation, Inc

Contract: CI 18-006

OWNER's Contract No. CI 18-006 ENGINEER's Project No. 1448A

ENGINEER Wes Wegner (Wallis Engineering)

The following includes details for change order 4 which includes multiple items.

Change Order 4 –

- Item 4.1 – Extend quantities for Rock Excavation to 260 total CY; additional 185 CY beyond original contract
- Item 4.2 – Additional compensation for loss of efficiency due to full depth rock excavation on Center Street and 9<sup>th</sup> Street
- Item 4.3 – Remove existing tee and 2 existing valves on Park Avenue
- Item 4.4 – Changes to Warner Avenue connection at Molalla Avenue
- Item 4.5 – Changes to pavement restoration on Center Street and 9<sup>th</sup> Street
- Item 4.6 – Change to typical trench restoration asphalt thickness
- Item 4.7 – Reconnect existing sewer lateral to 824 Center Street
- Item 4.8 – Modify fire line connection to 824 Center Street authorized with Change Order 2

You are directed to make the following changes in the Contract Documents.

**Item 4.1: Extend quantities for Rock Excavation to 261 total CY; additional 186 CY**

Description: Extend the quantities for Bid Item 6 – Rock Excavation to a total of 261 CY at the contract unit price of \$265/CY to account for additional quantities encountered while installing water main and appurtenances on Center and 9<sup>th</sup> Street.

Reason for Change Order: The decomposed basalt material encountered during geotechnical investigations and shown in the plans was anticipated to only require typical trenching methods. When encountered in the field, this material required typical rock excavation techniques to avoid significant overburden of the trench and degradation of the existing road. As a result of the need for rock removal techniques, additional rock excavation quantities are warranted that exceed the quantities included in the original contract and were measured per the pay limits identified in Section 00405.81(a) of the standard specifications.

Change in Contract Price: Work under Change Order Item 4.1 will be paid at the unit contract price for Bid Item 6 – Rock Excavation for 186 CY. Total increase in contract price is \$49,290.00.

Change in Contract Times: No change in Contract Time was requested by the Contractor.

**Item 4.2: Additional compensation for loss of efficiency due to full depth rock excavation on Center Street and 9<sup>th</sup> Street**

Description: Additional compensation is required to account for the loss of efficiency in water main trenching production due to the presence of full depth rock on Center and 9<sup>th</sup> Street.

Reason for Change Order: Similar to item 4.1 described above, the full depth rock encountered in the trench on Center Street and 9<sup>th</sup> caused production disruption for the water line installation. The contractor provided justification that the unit contract prices for water main installation are indicative of normal trenching conditions and do not reflect slow production associated with full depth rock excavation. After additional conversations with the City and Contractor, the Engineer and City agree that additional compensation is appropriate to account for the loss of production due to the unforeseen condition of rock being present for the full depth of the trenching operations.

Change in Contract Price: Work under Change Order Item 4.2 will be paid at the lump sum price of \$30,210.00

Change in Contract Times: No change in Contract Time was requested by the Contractor.

**Item 4.3: Remove existing tee and 2 existing valves on Park Avenue**

Description: Remove the existing tee and the two existing valves on Park Avenue that connect to the existing water main on Cherry Street which is replaced with this project as shown on revised C13.

Reason for Change Order: It was identified that removing the existing tee and connected valves would be advantageous for the future operation of the water system once this project is complete. It also removes additional valves on the system that provide little redundancy benefit but still require annual maintenance.

Change in Contract Price: Work under Change Order Item 4.3 will be paid at the lump sum price of \$1,050.00

Change in Contract Times: No change in Contract Time was requested by the Contractor.

#### **Item 4.4: Changes to Warner Avenue connection at Molalla Avenue**

Description: Modify the proposed improvements per the sheet revisions to sheet C11.

Reason for Change Order: After potholing the existing valve near Molalla Avenue and Warner Street and verifying the configuration of the existing waterline fittings, it was determined that replacing the piping and valve all the way to the existing waterline in Molalla Avenue was not appropriate at this time. The improvements removed with this change order are anticipated to be completed with future waterline improvements on Molalla Avenue. Multiple bid item unit quantities are modified as a result of this change as follows:

Bid Item 2: Reduce lump sum value by \$250.00.

Bid Item 12: Reduce by 162 SY at the unit contract price of \$95.00/SY.

Bid Item 18: Increase unit quantities by 20 LF at the unit contract price of \$74.00/LF.

Bid Item 19: Reduce unit quantities by 35 LF at the unit contract price of \$195.00/LF.

Change in Contract Price: Work under Change Order Item 4.4 will modify the estimated contract quantities and result in a decrease in contract price totaling (\$20,985.00)

Change in Contract Times: No change in Contract Time was requested by the Contractor.

#### **Item 4.5: Changes to pavement restoration on Center Street and 9<sup>th</sup> Street**

Description: Construct pavement restoration on Center Street and 9<sup>th</sup> Street per the attached Exhibit 1

Reason for Change Order: Pavement disturbance created as a result of the waterline installation will require additional asphalt restoration beyond the typical trench patching shown in the plans. The existing quality of the asphalt, presence of shallow rock and existing thickness of the asphalt all resulted in trenches of varying width. To adequately restore the asphalt on Center and 9<sup>th</sup> Street, wider pavement restoration is required to restore the road to an acceptable condition.

A new bid item is created to measure and pay for this work:

Bid Item 4.5 A – Center and 9<sup>th</sup> Permanent ACP restoration. 1,800 SY @ \$35.60/SY = \$64,080.00

This change also results in a quantity reduction of Bid Item 10 as the newly created bid item will replace some of the restoration included in the original contract:

Bid Item 10 – Trench Resurfacing, Permanent ACP, 5-Inch Depth. Reduce by 821 SY @ \$58.00/SY = (\$47,618.00)

Change in Contract Price: Work under Change Order Item 4.5 will be paid at the change order unit price for Bid Item 4.5A and results in an increase to the contract price totaling \$16,462.00.

Change in Contract Times: No change in Contract Time was requested by the Contractor.

#### **Item 4.6: Typical trench restoration changes**

Description: Construct the typical trench restoration per the Contract plans except change the final asphalt thickness to 3 inches instead of 5 inches. Trench restoration on Holmes Lane will have a 4 inch thickness.

Reason for Change Order: Following excavation of the waterline, it was observed that the existing pavement thicknesses were less than that proposed for the permanent trench restoration. Revising the permanent trench restoration to a 3 inch thickness will more closely match the asphalt section of the existing roadways. Holmes Lane will be modified to a 4 inch thick trench patch.

Two new bid items are created to measure and pay for this work:

Bid Item 4.6 A – Trench Resurfacing, Permanent ACP, 3-Inch Depth. 1,233 SY @ \$35.60/SY = \$43,894.80

Bid Item 4.6 B – Trench Resurfacing, Permanent ACP, 4-Inch Depth. 20 SY @ \$47.90/SY = \$958.00

This change also results in a quantity reduction of Bid Item 10 as the newly created bid item will replace all of the trench restoration included in the original contract not revised with Item 4.5 above:

Bid Item 10 – Trench Resurfacing, Permanent ACP, 5-Inch Depth. Reduce by 1,253 SY @ \$58.00/SY = (\$72,674.00)

Change in Contract Price: Work under Change Order Item 4.6 will be paid at the change order unit price for Bid Item 4.6A and results in a decrease to the contract price totaling (\$27,821.20.)

Change in Contract Times: No change in Contract Time was requested by the Contractor.

#### **Item 4.7: Reconnect existing sewer lateral to 824 Center Street**

Description: Reconstruct the existing sewer lateral to 824 Center Street.

Reason for Change Order: During installation of the watermain, an existing pipe was discovered and determined by the City to be an abandoned storm pipe. The pipe was removed, but it was later discovered that this was an existing sanitary sewer lateral to 824 Center Street that was connected to an abandoned storm system. 824 Center Street had been vacant for some time and loss of service from abandoning the storm system did not become apparent until the residence became occupied at the same time as the waterline work began. This change order includes the work to reconstruct the sewer lateral and connect it to the existing sanitary sewer main within 9<sup>th</sup> Street.

Change in Contract Price: Work under Change Order Item 4.7 was conducted by Force Account in accordance with Section 00197 of the Specification and results in an increase to the contract price totaling (\$5,924.00.)

Change in Contract Times: No change in Contract Time was requested by the Contractor.

**Item 4.8: Modify fire line connection to 824 Center Street authorized with Change Order 2**

Description: Modify the work proposed in Change Order 2 to include installing a new 4 inch diameter fireline, including the tee and valve at the main, installing a new 4 inch valve prior to the existing curb, capping the new line after the new valve, providing a 2 inch diameter port and riser in the planter strip and cutting and capping the existing fire line behind the curb.

Reason for Change Order: Following execution of Change Order 2, the City identified that the discovered fire line should not be reconnected to the existing fire line due to concerns with inadequate backflow prevention inside the existing structure. Alternatively, the City directed the Contractor to modify the work described in Change Order 2 to include providing a new fire line but not connecting it to the existing fire line at this time. This will allow future connection to the fire line when all backflow prevention devices are brought up to code, but will not require disturbing the street or recently constructed water improvements.

Change in Contract Price: Work under Change Order Item 4.8 will be paid at the lump sum price of \$2,144.00

Change in Contract Times: No change in Contract Time was requested by the Contractor.

CHANGE IN CONTRACT PRICE:	CHANGE IN CONTRACT TIMES:
Original Contract Price: \$884,750.00	Original Contract Times: Substantial Completion: <u>NA</u> Ready for final payment: <u>85 Calendar Days</u> <small>(days or dates)</small>
Net Increase from previous Change Orders No. <u>0</u> to No. <u>3</u> : \$13,412.00	Net change from previous Change Orders No. <u>0</u> to No. <u>3</u> : Substantial Completion: <u>0</u> Ready for final payment: <u>0</u> <small>(days)</small>
Contract Price prior to the Change Order: \$898,162.00	Contract Times prior to this Change Order: Substantial Completion: <u>NA</u> Ready for final payment: <u>85 Calendar Days</u> <small>(days or dates)</small>
Net Increase (Decrease) of the Change Order: \$56,273.80	Net Increase (Decrease) of this Change Order: Substantial Completion: <u>NA</u> Ready for final payment: <u>0 Calendar Days</u> <small>(days)</small>
Contract Price with all approved Change Orders: \$ 954,435.80	Contract Times with all approved Change Orders: Substantial Completion: <u>NA</u> Ready for final payment: <u>85 Calendar Days</u> <small>(days or dates)</small>

RECOMMENDED:

By:   
ENGINEER (Authorized Signature)

Date: 2/8/2019

APPROVED:

By: \_\_\_\_\_  
OWNER (Authorized Signature)

Date: \_\_\_\_\_

ACCEPTED:

By:   
CONTRACTOR (Authorized Signature)

Date: 2/8/2019

EJCDC No. 1910-8-B (1996 Edition)

Prepared by the Engineers Joint Contract Documents Committee and endorsed by The Associated General Contractors of America and the Construction Specifications Institute.

# Item 4.3 & 4.4

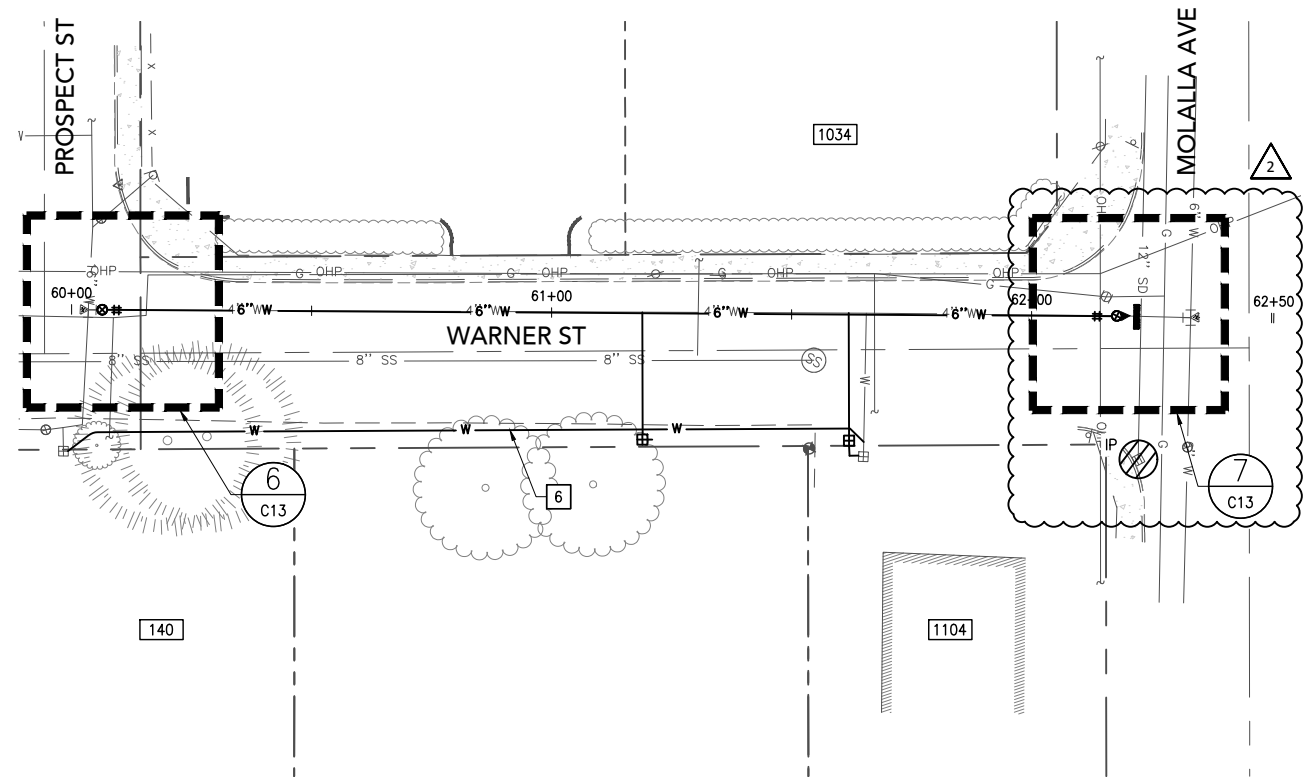
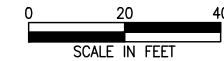

PLAN

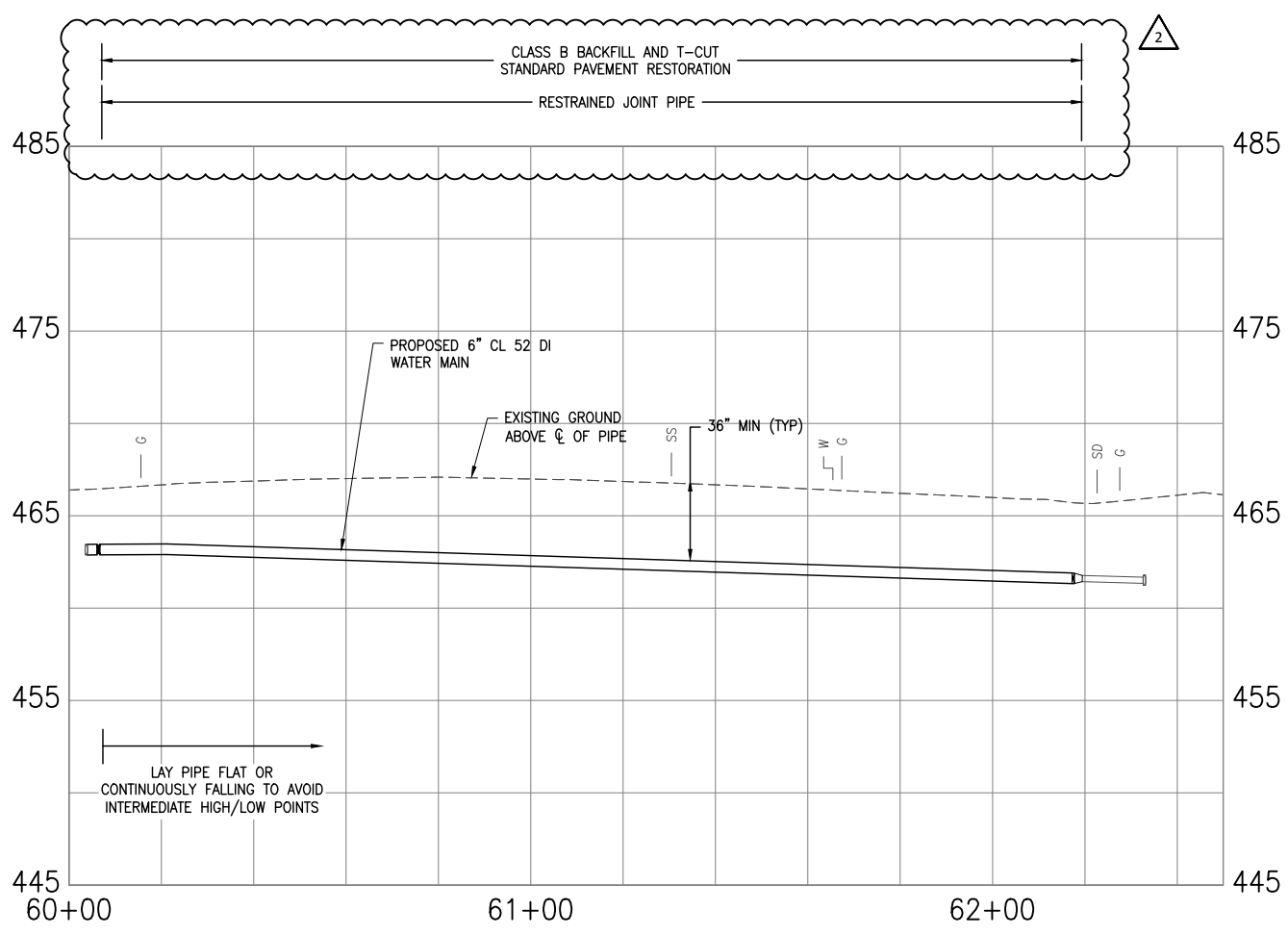

PROFILE  
SCALE: 1" = 20' HORIZ  
1" = 5' VERT

### KEY NOTES

- 6 PROVIDE TEMPORARY 1-INCH WATER SERVICE TO 1104 MOLALLA AVENUE. TEMPORARY WATER SERVICE SHALL MEET ALL LOCAL PLUMBING CODE REQUIREMENTS EXCEPT THAT COVER/BURY DETPH MAY BE REDUCED TO 1-FOOT. REMOVE TEMPORARY SERVICE FOLLOWING CONNECTION OF NEW WATER MAIN.

### WATER SERVICE SCHEDULE

STATION	ADDRESS	SERVICE LINE SIZE (IN)	SIDE	METER SIZE
61+19	VACANT LOT	1	FAR	5/8" X 3/4"
61+62	1104	1	FAR	5/8" X 3/4"

### CONSTRUCTION NOTES

- WHERE BENDS ARE NOT SHOWN, DEFLECT JOINTS A MAXIMUM OF HALF THE MANUFACTURER'S RECOMMENDATION TO ACHIEVE THE ALIGNMENT AND PROFILE SHOWN.
- VALVE ABANDONMENT SHALL CONSIST OF REMOVING VALVE STEM, CUTTING AND REMOVING NUT, REMOVING VALVE BOX, AND BACKFILLING.
- PROTECT EXISTING CURB AND SIDEWALK WHERE POSSIBLE. COORDINATE REMOVAL WITH INSPECTOR PRIOR TO SAWCUTTING.
- EXISTING WATER MAIN IN WARNER STREET SHALL BE REMOVED AND DISPOSED OF OFF SITE.

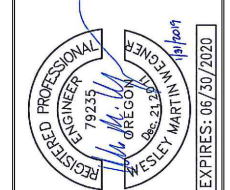

NO.	REVISION	DATE
1	CONNECTION CHANGES	1/31/19
BY	DATE	
WMW	1/31/19	
DESIGNED BY:	JV	
DRAWN BY:	CK	
REF:	WMW/DB	

## WARNER STREET PLAN & PROFILE



PROJECT NO: 1448A  
DATE: 6/2018

## 2018 WATER SYSTEM IMPROVEMENTS

CI 18-006



DRAWING NO:

# C11

**Item 4.3 & 4.4**

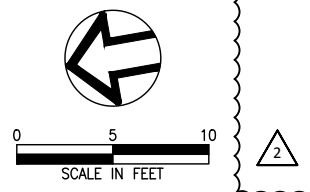
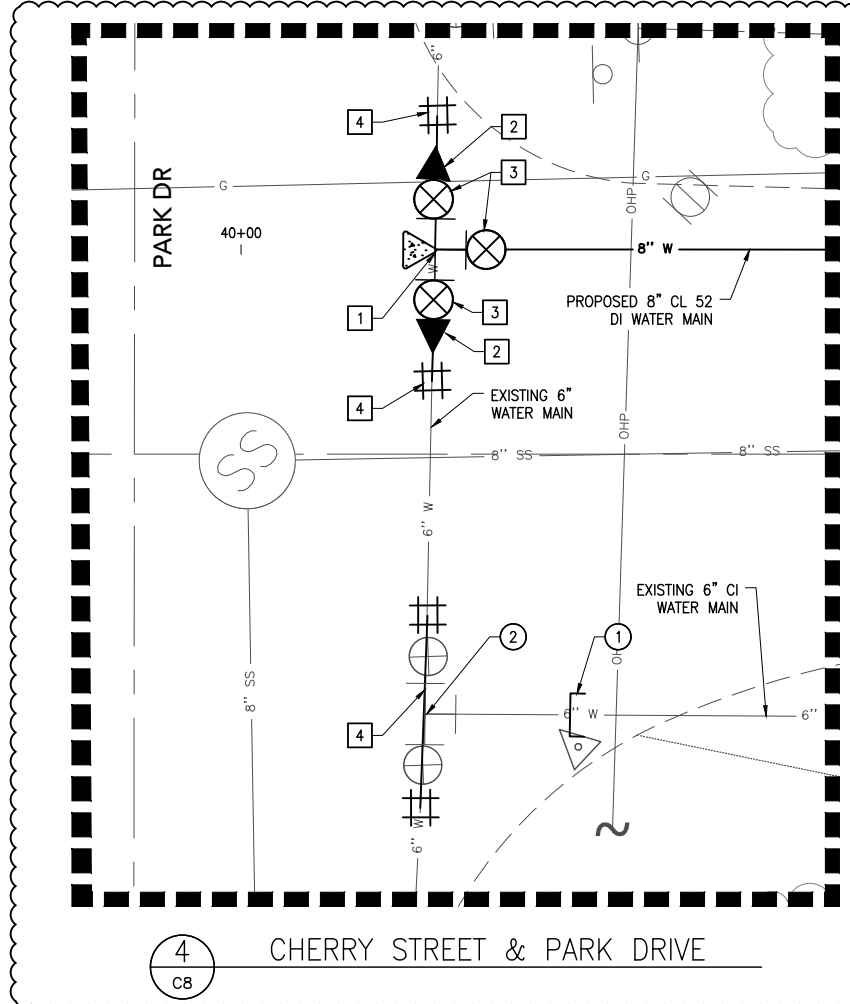

- REMOVE: EXISTING PIPING AND FITTINGS AS NECESSARY TO PERMIT INSTALLATION OF PIPE AND FITTINGS SHOWN.
- ① ABANDON PIPE AND FILL W/ CLSM
  - ② REMOVE EXISTING TEE AND VALVES
- INSTALL:
- ① 1 ~ 8" FL TEE W/ THRUST BLOCK
  - ② 2 ~ 6" X 8" MJ REDUCER AND 8" DI SPOOL
  - ③ 3 ~ 8" FL X MJ GV
  - ④ 3 ~ 6" PE DI SPOOL AND COUPLING

4 CHERRY STREET & PARK DRIVE

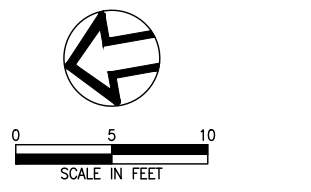
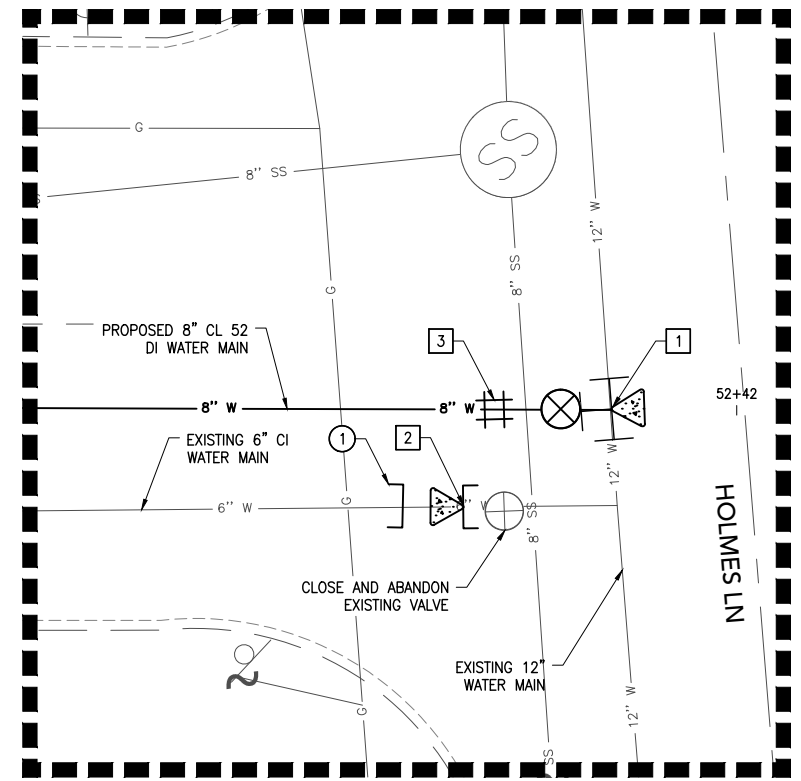

- REMOVE: EXISTING PIPING AND FITTINGS AS NECESSARY TO PERMIT INSTALLATION OF PIPE AND FITTINGS SHOWN.
- ① ABANDON PIPE AND FILL W/ CLSM
- INSTALL:
- ① 1 ~ 12" X 8" TAPPING SLEEVE W/ 8" FL X MJ GV AND THRUST BLOCK
  - ② 1 ~ 6" MJ PLUG OR BLIND FLANGE W/ THRUST BLOCK (CONTRACTOR TO VERIFY WHICH SIZE AND TYPE WILL BE REQUIRED)
  - ③ 1 ~ 8" DI LONG SLEEVE (AS NEEDED TO ALLOW TESTING)

5 CHERRY STREET & HOLMES LANE

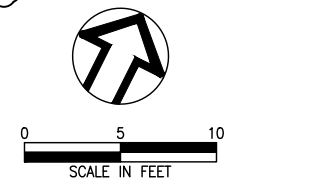
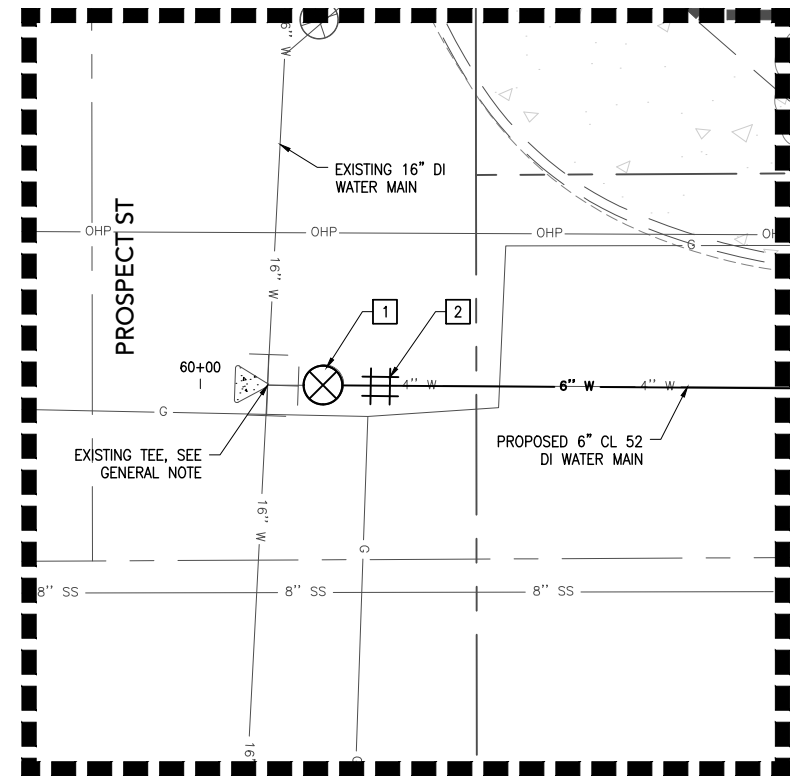

- REMOVE: EXISTING PIPING AND FITTINGS AS NECESSARY TO PERMIT INSTALLATION OF PIPE AND FITTINGS SHOWN.
- INSTALL:
- ① 1 ~ REMOVE AND REPLACE EXISTING 6" VALVE W/ NEW 6" GV, CONFIRM EXISTING JOINT TYPE AND MATCH
  - ② 1 ~ 6" DI LONG SLEEVE (AS NEEDED TO ALLOW TESTING)

6 WARNER STREET & PROSPECT STREET

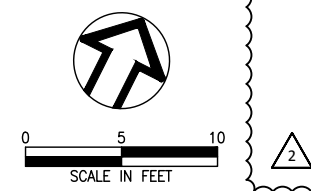
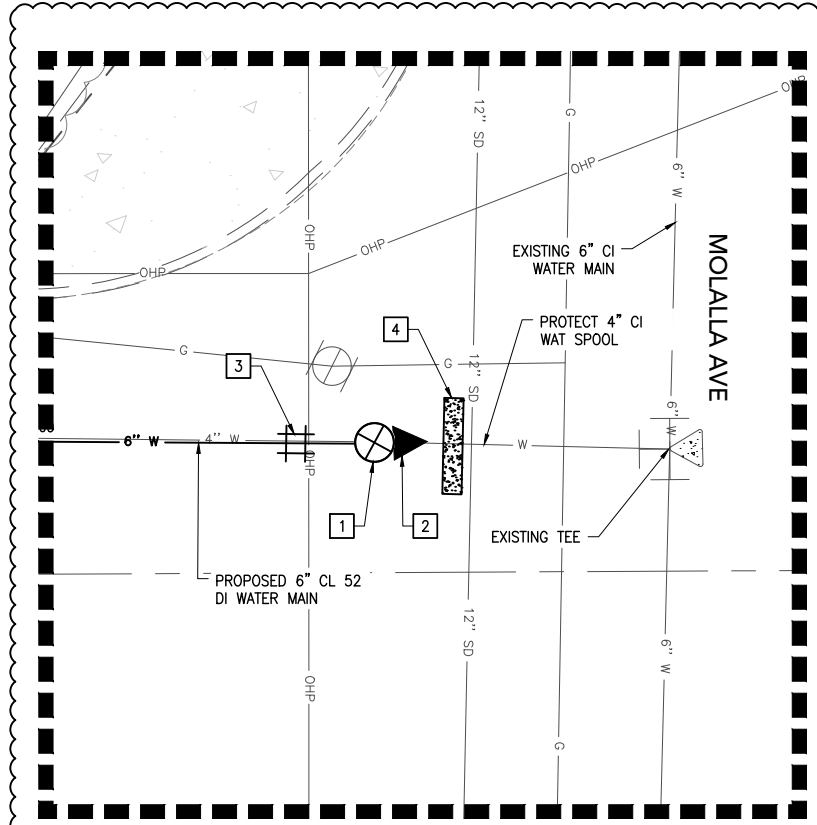

- REMOVE: EXISTING PIPING AND FITTINGS AS NECESSARY TO PERMIT INSTALLATION OF PIPE AND FITTINGS SHOWN.
- INSTALL:
- ① 1 ~ 6" MJ GV TO REPLACE EXIST VALVE. INSTALL 6" PE DI SPOOL AND ADAPTERS AS REQUIRED
  - ② 1 ~ 6" X 4" MJ REDUCER IF REQUIRED
  - ③ 1 ~ 6" DI LONG SLEEVE (AS NEEDED TO ALLOW TESTING)
  - ④ STRADDLE THRUST BLOCK. RESTRAIN EXIST VALVE PRIOR TO WATERMAIN INSTALLATION W/ ALL-THREAD RODS

7 WARNER STREET & MOLALLA AVE

**GENERAL NOTE**  
 POTHOLE EXISTING PIPE AND FITTINGS AT CONNECTION AND ABANDONMENT LOCATIONS TO CONFIRM EXISTING PIPE AND FITTING TYPE, SIZE, MATERIAL, AND JOINTS PRIOR TO ORDERING CONNECTION AND ABANDONMENT FITTINGS. ENGINEER TO APPROVE FITTINGS AND CONFIGURATION PRIOR TO INSTALLATION.

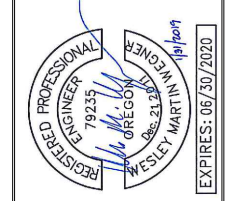

DATE	1/31/19
BY	WMW
REVISION	CHANGES
NO.	1
DESIGNED BY	JV
DRAWN BY	CK
REF.	WMW/DB
SCALE	ONE INCH AT FULL SCALE. NOT ONE INCH ADJUST IF SCALE ACCORDINGLY

**CONNECTION DETAILS II**



DATE: 6/2018  
 PROJECT NO: 1448A

**2018 WATER SYSTEM IMPROVEMENTS**

CI 18-006



DRAWING NO:

**C13**



**Item 4.5 & 4.6**

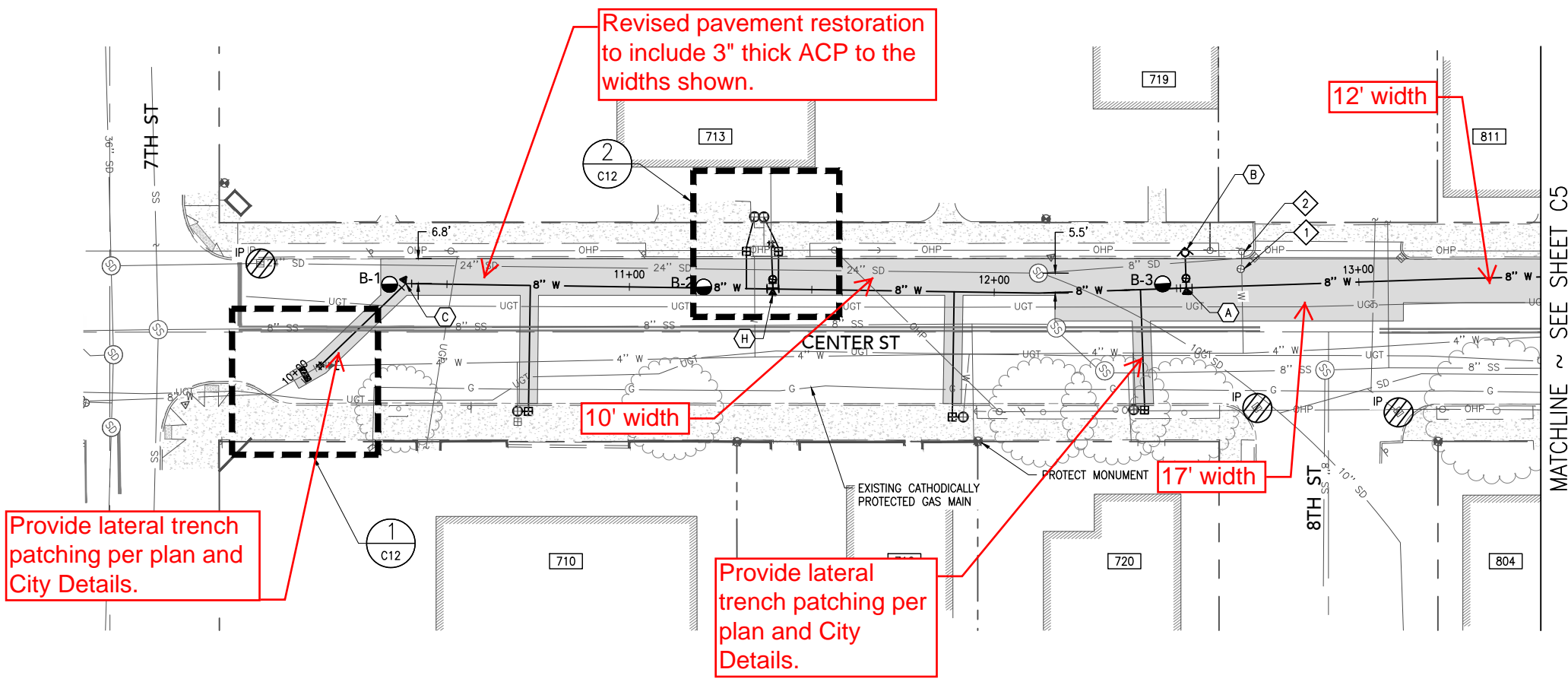
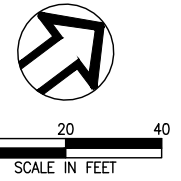

MATCHLINE ~ SEE SHEET C5

**VALVE & FITTING SCHEDULE**

- (A) INSTALL: (TYP 1)  
1 ~ 8" X 6" FL X MJ TEE W/ THRUST BLOCK  
1 ~ 6" FL X MJ GV
- (B) INSTALL: (TYP 1)  
1 ~ FIRE HYDRANT ASSEMBLY, SEE CITY STANDARD DETAIL 401, SHEET D2
- (C) INSTALL: (TYP 1)  
1 ~ 8" MJ 45° BEND W/ THRUST BLOCK
- (H) INSTALL: (TYP 1)  
1 ~ 8" X 4" FL X MJ TEE W/ THRUST BLOCK  
1 ~ 4" FL X MJ GV

**ABANDONMENT SCHEDULE**

- (1) ABANDON: (TYP 1)  
1 ~ EXISTING VALVE
- (2) ABANDON: (TYP 1)  
1 ~ EXISTING FIRE HYDRANT

**WATER SERVICE SCHEDULE**

STATION	ADDRESS	SERVICE LINE SIZE (IN)	SIDE	METER SIZE
10+73	710	2	FAR	2" WITH PRV
11+32	713	1	NEAR	5/8" X 3/4" WITH PRV
11+41	713	2	NEAR	1 1/2" WITH PRV
11+89	716	1	FAR	5/8" X 3/4" WITH PRV
12+40	720	1	FAR	5/8" X 3/4" WITH PRV

**CONSTRUCTION NOTES**

- WHERE BENDS ARE NOT SHOWN, DEFLECT JOINTS A MAXIMUM OF HALF THE MANUFACTURER'S RECOMMENDATION TO ACHIEVE THE ALIGNMENT AND PROFILE SHOWN.
- VALVE ABANDONMENT SHALL CONSIST OF REMOVING VALVE STEM, CUTTING AND REMOVING NUT, REMOVING VALVE BOX, AND BACKFILLING.
- PROTECT EXISTING CURB AND SIDEWALK WHERE POSSIBLE. COORDINATE REMOVAL WITH INSPECTOR PRIOR TO SAWCUTTING.
- EXISTING WATER MAIN IN CENTER STREET SHALL BE ABANDONED IN PLACE. EXPOSED ENDS SHALL BE CAPPED OR GROUT PLUGGED.
- SEE GEOTECHNICAL REPORT FOR ADDITIONAL INFORMATION ON BORING INVESTIGATIONS.

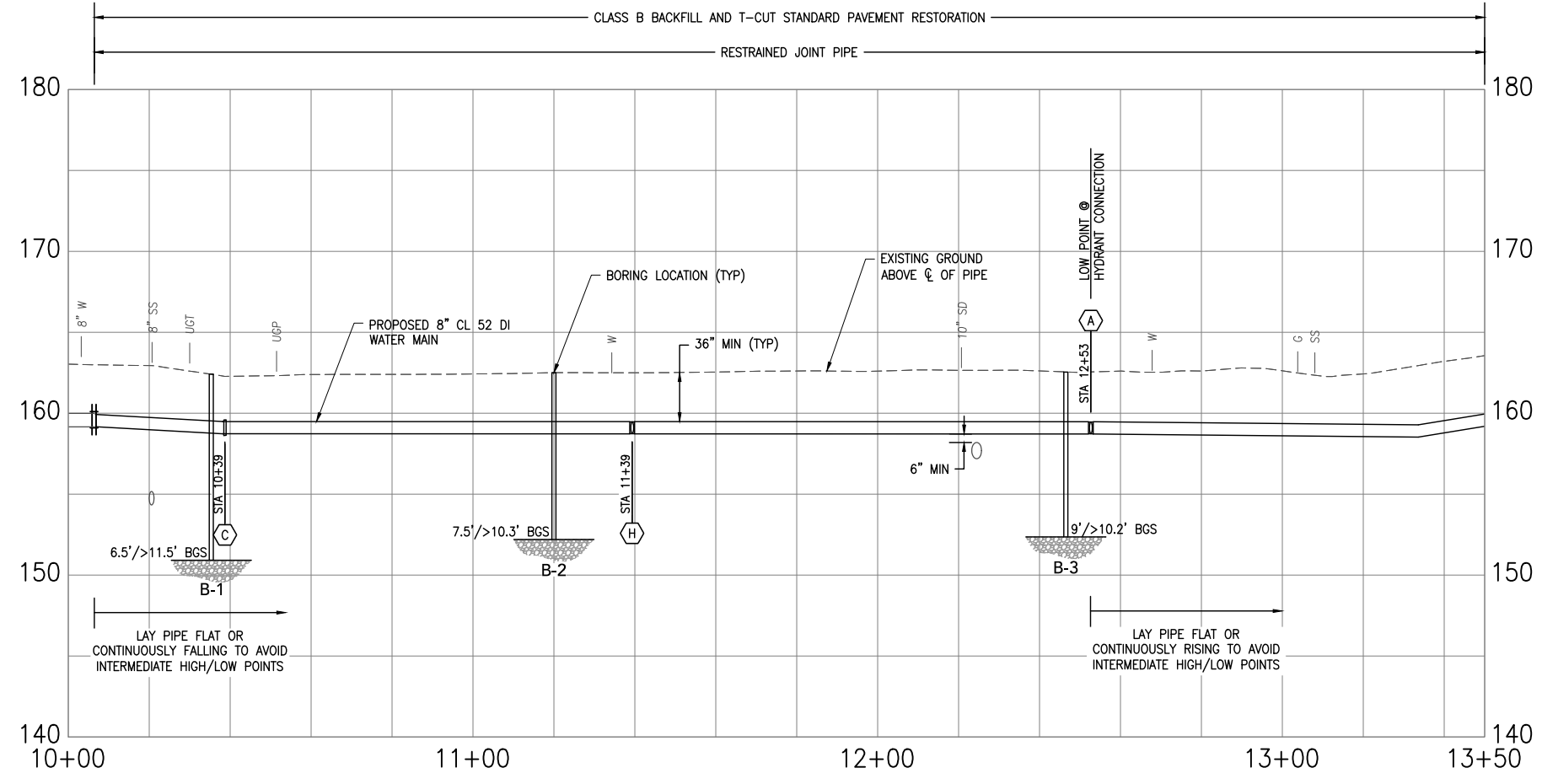

**PROFILE**  
SCALE: 1" = 20' HORIZ  
1" = 5' VERT

P:\1448A DC 2018 Waterline Replacement\500 DMG\501 Plan Sheets\4 PLAN AND PROFILE.dwg, 1/31/2018 10:42:34 AM, Chad Kays

NO.	REVISION	BY	DATE

**CENTER STREET PLAN & PROFILE BEGIN TO STA 13+50**

**wallis engineering**  
213 W. 1st Street, Suite 200  
Vancouver, WA 98660  
360.685.7041

DATE: 6/2018  
PROJECT NO: 1448A

**2018 WATER SYSTEM IMPROVEMENTS**  
CI 18-006



DRAWING NO:  
**C4**  
4 OF 17

**Item 4.5 & 4.6**

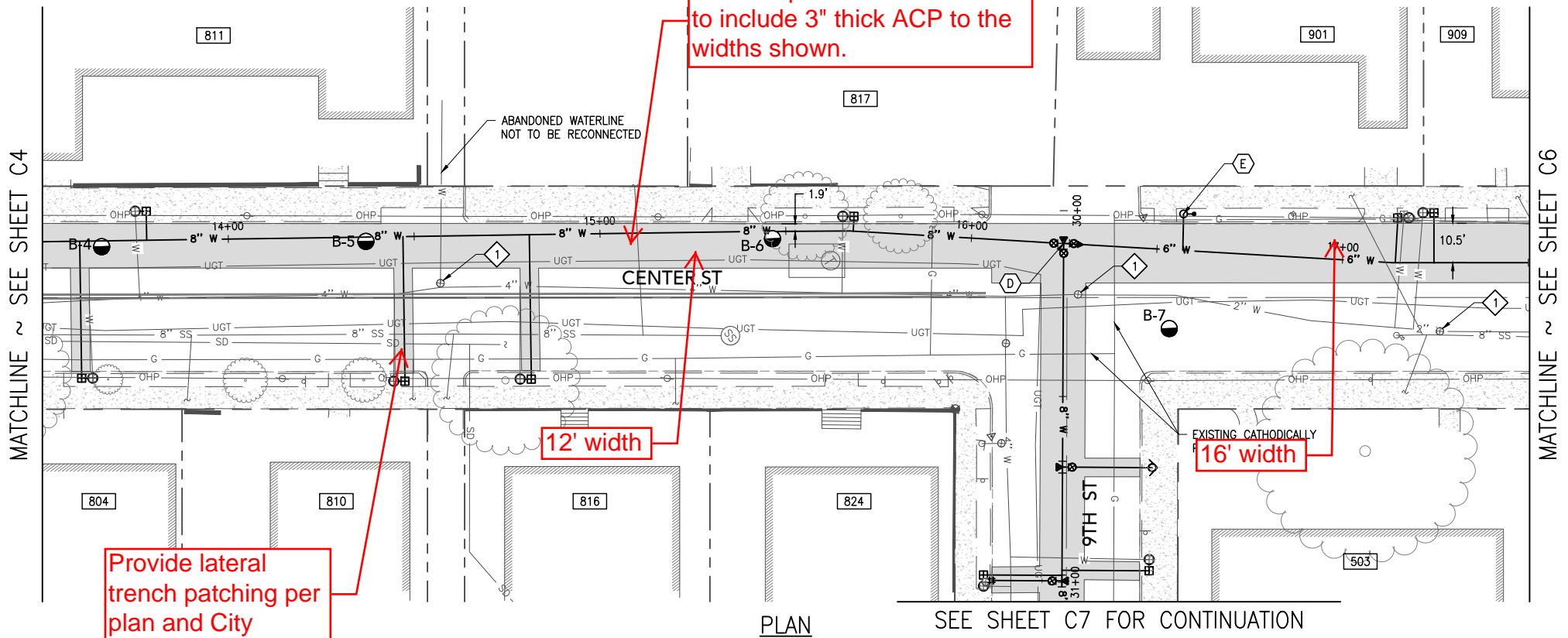
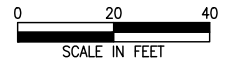

**VALVE & FITTING SCHEDULE**

- (D) INSTALL: (TYP 1)**  
 1 ~ 8" FL TEE W/ THRUST BLOCK  
 3 ~ 8" FL X MJ GV  
 1 ~ 8" PE DI SPOOL  
 1 ~ 8" X 6" MJ REDUCER
- (E) INSTALL: (TYP 1)**  
 1 ~ 1" COMBINATION AIR RELEASE VACUUM VALVE, SEE CITY STANDARD DETAIL 417, SHEET D3

**ABANDONMENT SCHEDULE**

- (1) ABANDON: (TYP 3)**  
 1 ~ EXISTING VALVE

**WATER SERVICE SCHEDULE**

STATION	ADDRESS	SERVICE LINE SIZE (IN)	SIDE	METER SIZE
13+60	804	1	FAR	5/8" X 3/4" WITH PRV
13+78	811	1	NEAR	5/8" X 3/4" WITH PRV
14+47	810	1	FAR	5/8" X 3/4" WITH PRV
14+81	816	1	FAR	5/8" X 3/4" WITH PRV
15+68	817	1	NEAR	1" WITH PRV
17+14	901	1	NEAR	3/4" WITH PRV
17+25	909	1	NEAR	5/8" X 3/4" WITH PRV

**CONSTRUCTION NOTES**

- WHERE BENDS ARE NOT SHOWN, DEFLECT JOINTS A MAXIMUM OF HALF THE MANUFACTURER'S RECOMMENDATION TO ACHIEVE THE ALIGNMENT AND PROFILE SHOWN.
- VALVE ABANDONMENT SHALL CONSIST OF REMOVING VALVE STEM, CUTTING AND REMOVING NUT, REMOVING VALVE BOX, AND BACKFILLING.
- PROTECT EXISTING CURB AND SIDEWALK WHERE POSSIBLE. COORDINATE REMOVAL WITH INSPECTOR PRIOR TO SAWCUTTING.
- EXISTING WATER MAIN IN CENTER STREET SHALL BE ABANDONED IN PLACE. EXPOSED ENDS SHALL BE CAPPED OR GROUT PLUGGED.
- SEE GEOTECHNICAL REPORT FOR ADDITIONAL INFORMATION ON BORING INVESTIGATIONS.

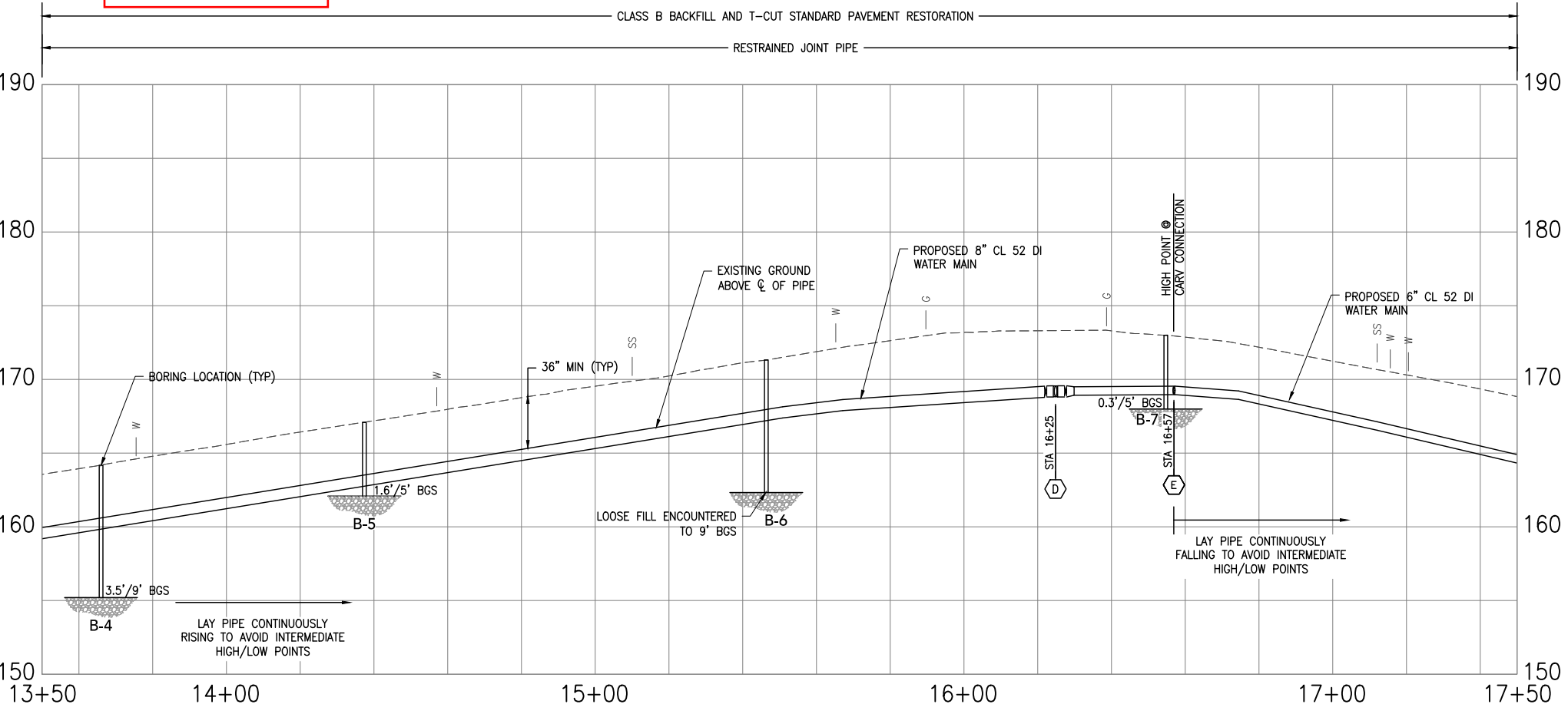

**PROFILE**

SCALE: 1" = 20' HORIZ  
 1" = 5' VERT

NO.	REVISION	BY	DATE

**CENTER STREET PLAN & PROFILE STA 13+50 TO STA 17+50**

**wallis engineering**  
 213 W. 10th Street, Suite 200  
 Vancouver, WA 98660  
 360.685.7041

PROJECT NO: 1448A  
 DATE: 6/2018

**2018 WATER SYSTEM IMPROVEMENTS**

OREGON CITY

CI 18-006

DRAWING NO:  
**C5**  
 5 OF 17

P:\14148A DC 2018 Waterline Replacement\500 DMG\501 Plan Sheets\4 PLAN AND PROFILE.dwg, 1/31/2018 10:42:39 AM, Chad Kays

# Item 4.5 & 4.6

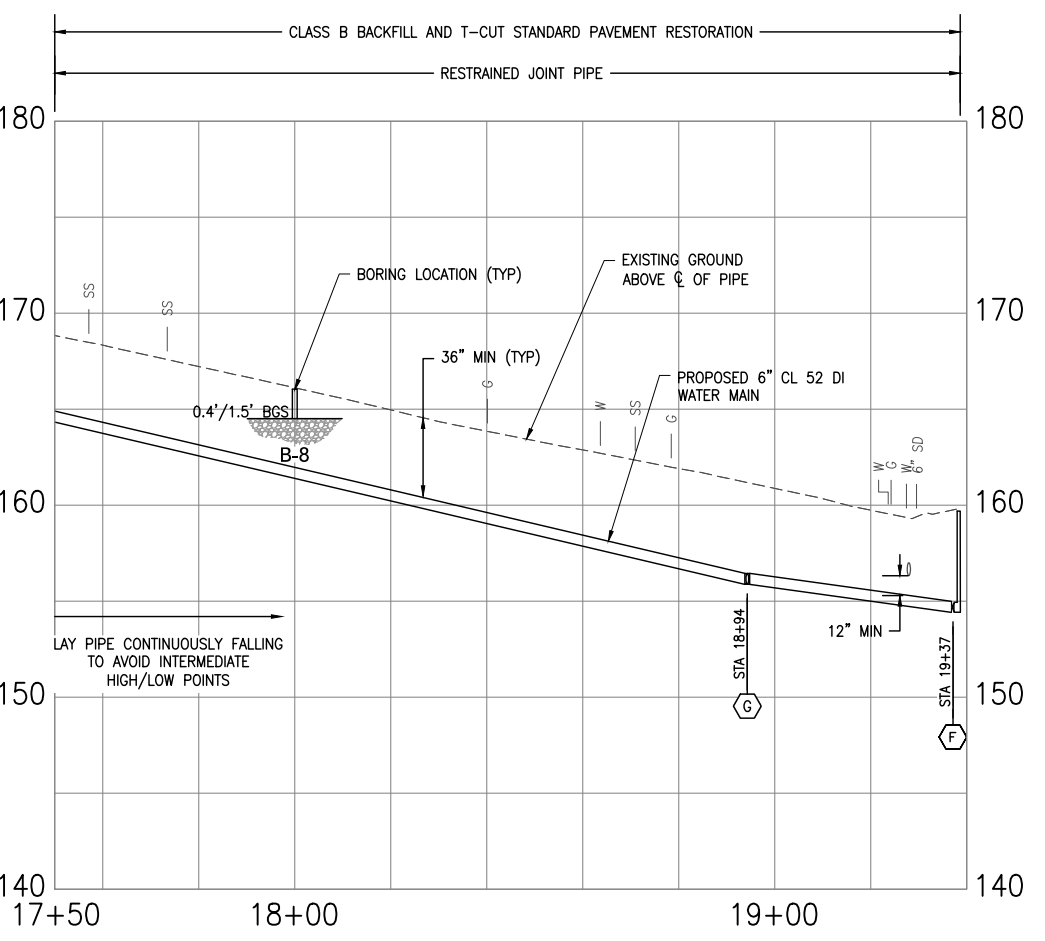
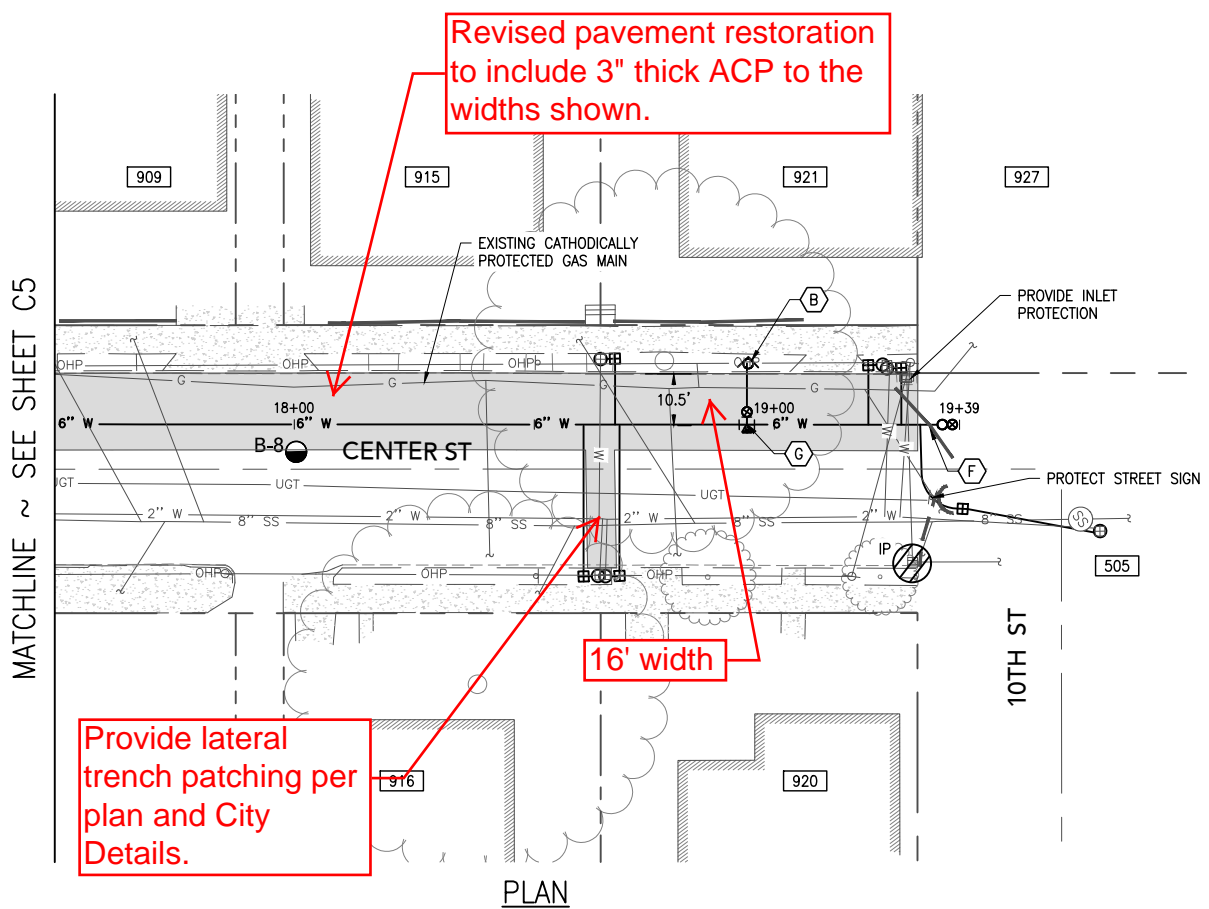
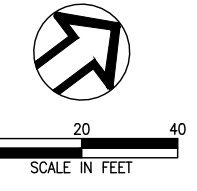

PROFILE  
SCALE: 1" = 20' HORIZ  
1" = 5' VERT

### VALVE & FITTING SCHEDULE

- (B) INSTALL: (TYP 1)  
1 ~ FIRE HYDRANT ASSEMBLY, SEE CITY STANDARD DETAIL 401, SHEET D2
- (F) INSTALL: (TYP 1)  
1 ~ BLOWOFF ASSEMBLY, SEE CITY STANDARD DETAIL 405, SHEET D2
- (G) INSTALL: (TYP 1)  
1 ~ 6" X 6" FL X MJ TEE W/ THRUST BLOCK  
1 ~ 6" FL X MJ GV

### WATER SERVICE SCHEDULE

STATION	ADDRESS	SERVICE LINE SIZE (IN)	SIDE	METER SIZE
18+60	916	1	FAR	5/8" X 3/4" WITH PRV
18+67	915	1	NEAR	5/8" X 3/4" WITH PRV
18+68	920	1	FAR	5/8" X 3/4" WITH PRV
19+20	921	1	NEAR	5/8" X 3/4" WITH PRV
19+26	927	1	NEAR	5/8" X 3/4" WITH PRV
19+30	505	1	FAR	5/8" X 3/4" WITH PRV

### CONSTRUCTION NOTES

1. WHERE BENDS ARE NOT SHOWN, DEFLECT JOINTS A MAXIMUM OF HALF THE MANUFACTURER'S RECOMMENDATION TO ACHIEVE THE ALIGNMENT AND PROFILE SHOWN.
2. VALVE ABANDONMENT SHALL CONSIST OF REMOVING VALVE STEM, CUTTING AND REMOVING NUT, REMOVING VALVE BOX, AND BACKFILLING.
3. PROTECT EXISTING CURB AND SIDEWALK WHERE POSSIBLE. COORDINATE REMOVAL WITH INSPECTOR PRIOR TO SAWCUTTING.
4. EXISTING WATER MAIN IN CENTER STREET SHALL BE ABANDONED IN PLACE. EXPOSED ENDS SHALL BE CAPPED OR GROUT PLUGGED.
5. SEE GEOTECHNICAL REPORT FOR ADDITIONAL INFORMATION ON BORING INVESTIGATIONS.

NO.	REVISION	BY	DATE

## CENTER STREET PLAN & PROFILE STA 17+50 TO END



DATE: 6/2018  
PROJECT NO: 1448A

## 2018 WATER SYSTEM IMPROVEMENTS

CI 18-006



DRAWING NO:

# C6

P:\1448A DC 2018 Waterline Replacement\500 DMG\501 Plan Sheets\4 PLAN AND PROFILE.dwg, 1/31/2018 10:42:42 AM, Chad Hoyt

SEE SHEET C5 FOR CONTINUATION

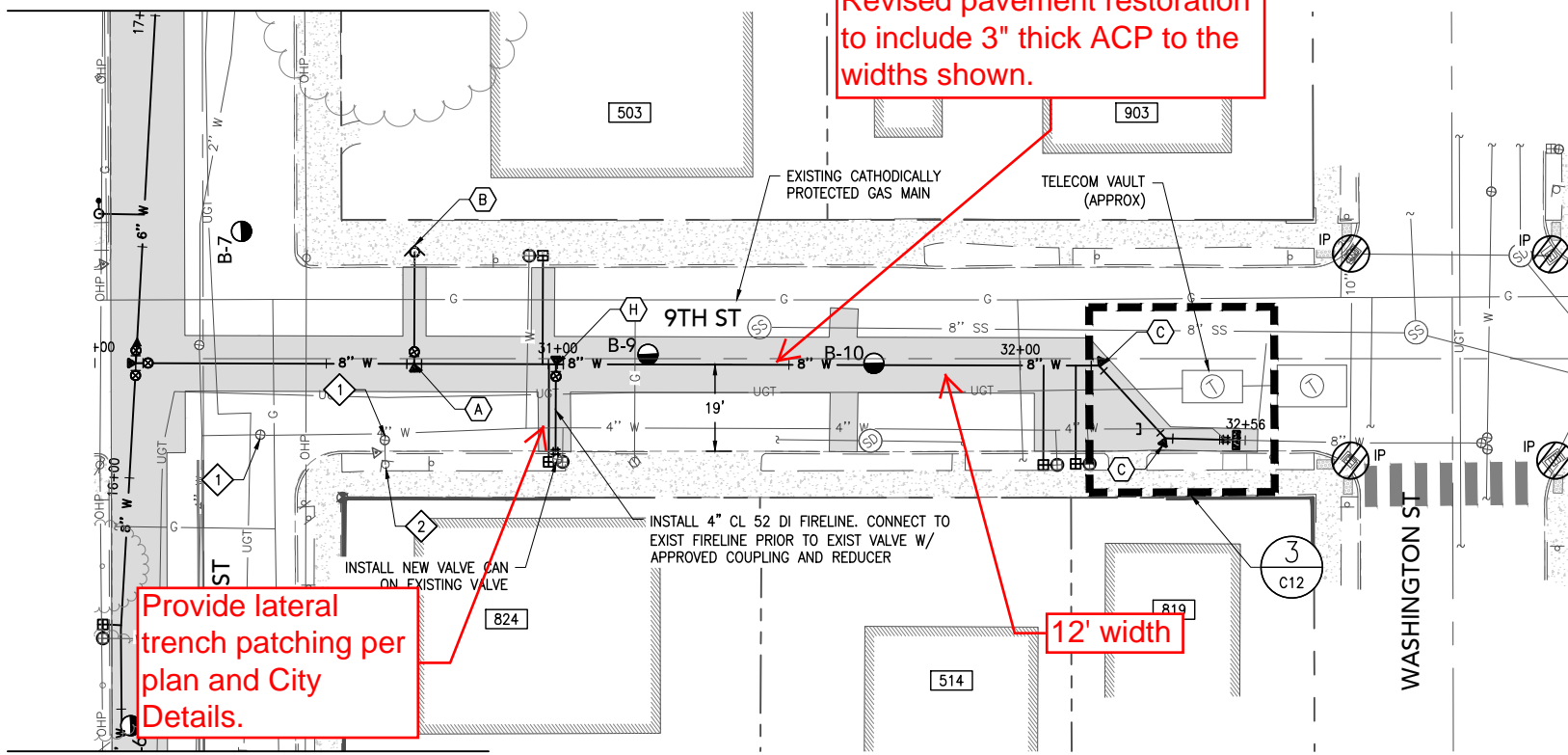

SEE SHEET C5 FOR CONTINUATION

PLAN

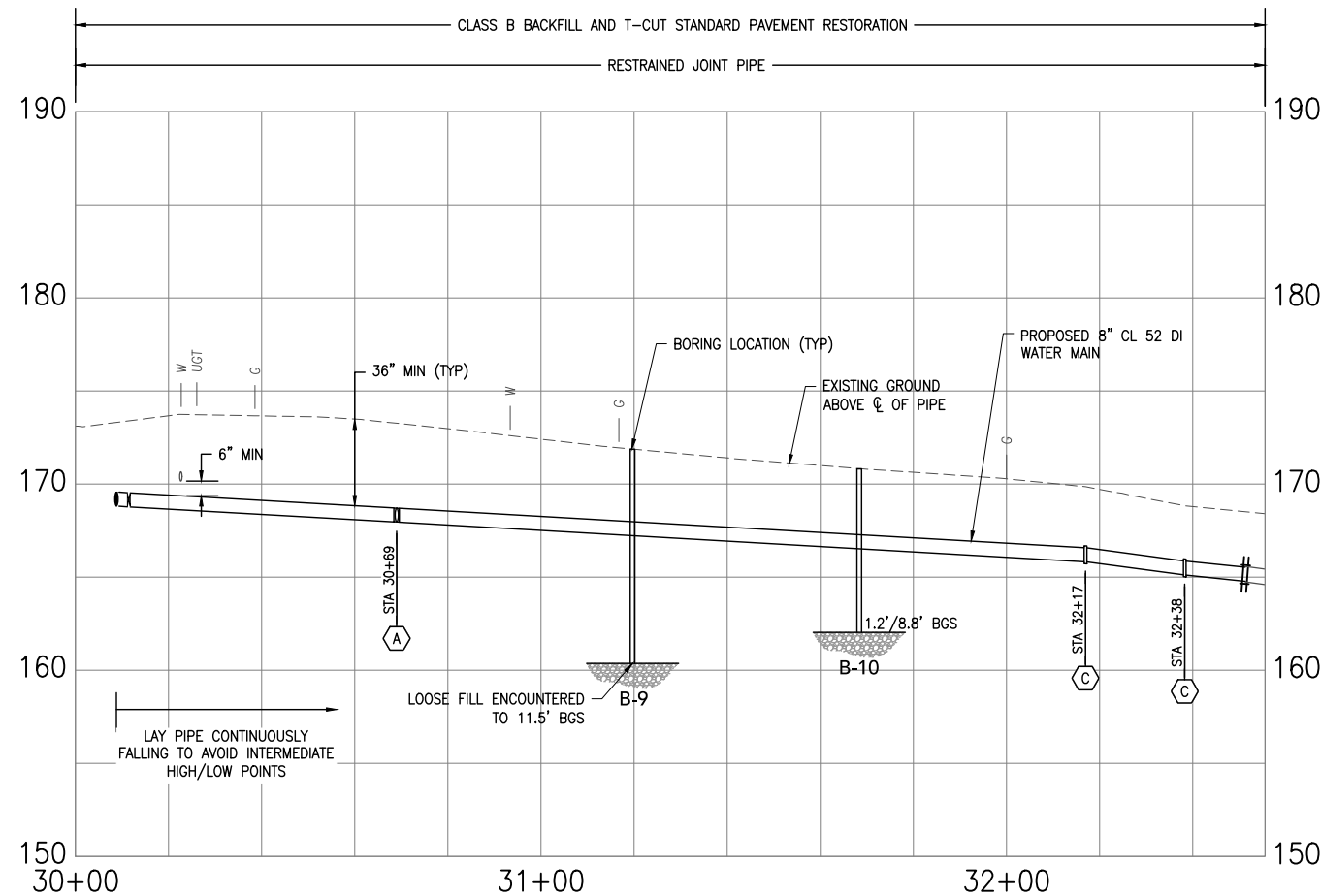

PROFILE  
SCALE: 1" = 20' HORIZ  
1" = 5' VERT

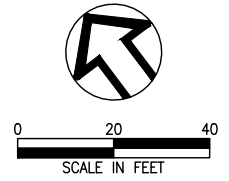

VALVE & FITTING SCHEDULE

- (A) INSTALL: (TYP 1)  
1 ~ 8" X 6" FL X MJ TEE W/ THRUST BLOCK  
1 ~ 6" FL X MJ GV
- (B) INSTALL: (TYP 1)  
1 ~ FIRE HYDRANT ASSEMBLY, SEE CITY STANDARD DETAIL 401, SHEET D2
- (C) INSTALL: (TYP 2)  
1 ~ 8" MJ 45° BEND W/ THRUST BLOCK

ABANDONMENT SCHEDULE

- (1) ABANDON: (TYP 2)  
1 ~ EXISTING VALVE
- (2) ABANDON: (TYP 1)  
1 ~ EXISTING FIRE HYDRANT
- (H) INSTALL: (TYP 1)  
1 ~ 8" X 4" FL X MJ TEE W/ THRUST BLOCK  
1 ~ 4" FL X MJ GV  
CUT TEE INTO RECENTLY INSTALLED WATER MAIN W/ SLEEVE AND SPOOL ON ONE SIDE AS NEEDED.

WATER SERVICE SCHEDULE

STATION	ADDRESS	SERVICE LINE SIZE (IN)	SIDE	METER SIZE
30+97	503	1	FAR	5/8" X 3/4" WITH PRV
30+98	824	2	NEAR	1 1/2" WITH PRV
32+05	514	1	NEAR	5/8" X 3/4" WITH PRV
32+12	819	1	NEAR	5/8" X 3/4" WITH PRV

CONSTRUCTION NOTES

1. WHERE BENDS ARE NOT SHOWN, DEFLECT JOINTS A MAXIMUM OF HALF THE MANUFACTURER'S RECOMMENDATION TO ACHIEVE THE ALIGNMENT AND PROFILE SHOWN.
2. VALVE ABANDONMENT SHALL CONSIST OF REMOVING VALVE STEM, CUTTING AND REMOVING NUT, REMOVING VALVE BOX, AND BACKFILLING.
3. PROTECT EXISTING CURB AND SIDEWALK WHERE POSSIBLE. COORDINATE REMOVAL WITH INSPECTOR PRIOR TO SAWCUTTING.
4. EXISTING WATER MAIN IN 9TH STREET SHALL BE ABANDONED IN PLACE. EXPOSED ENDS SHALL BE CAPPED OR GROUT PLUGGED.
5. SEE GEOTECHNICAL REPORT FOR ADDITIONAL INFORMATION ON BORING INVESTIGATIONS.

DATE	1/25/19
BY	WW
REVISION	
NO	824 FIRELINE
DESIGNED BY	JV
DRAWN BY	CK
SCALE	ONE INCH AT FULL SCALE, NOT ONE INCH ADJUST IF SCALE ACCORDINGLY

9TH STREET PLAN & PROFILE



DATE: 6/2018  
PROJECT NO: 1448A

2018 WATER SYSTEM IMPROVEMENTS



DRAWING NO:

C7

P:\1448A DC 2018 Waterline Replacement\500 DWG\501 Plan Sheets\4 PLAN AND PROFILE.dwg, 1/31/2019 10:42:48 AM, Chad Kays

This map is not suitable for survey, engineering, legal, or navigation purposes. Data errors and omissions may exist.

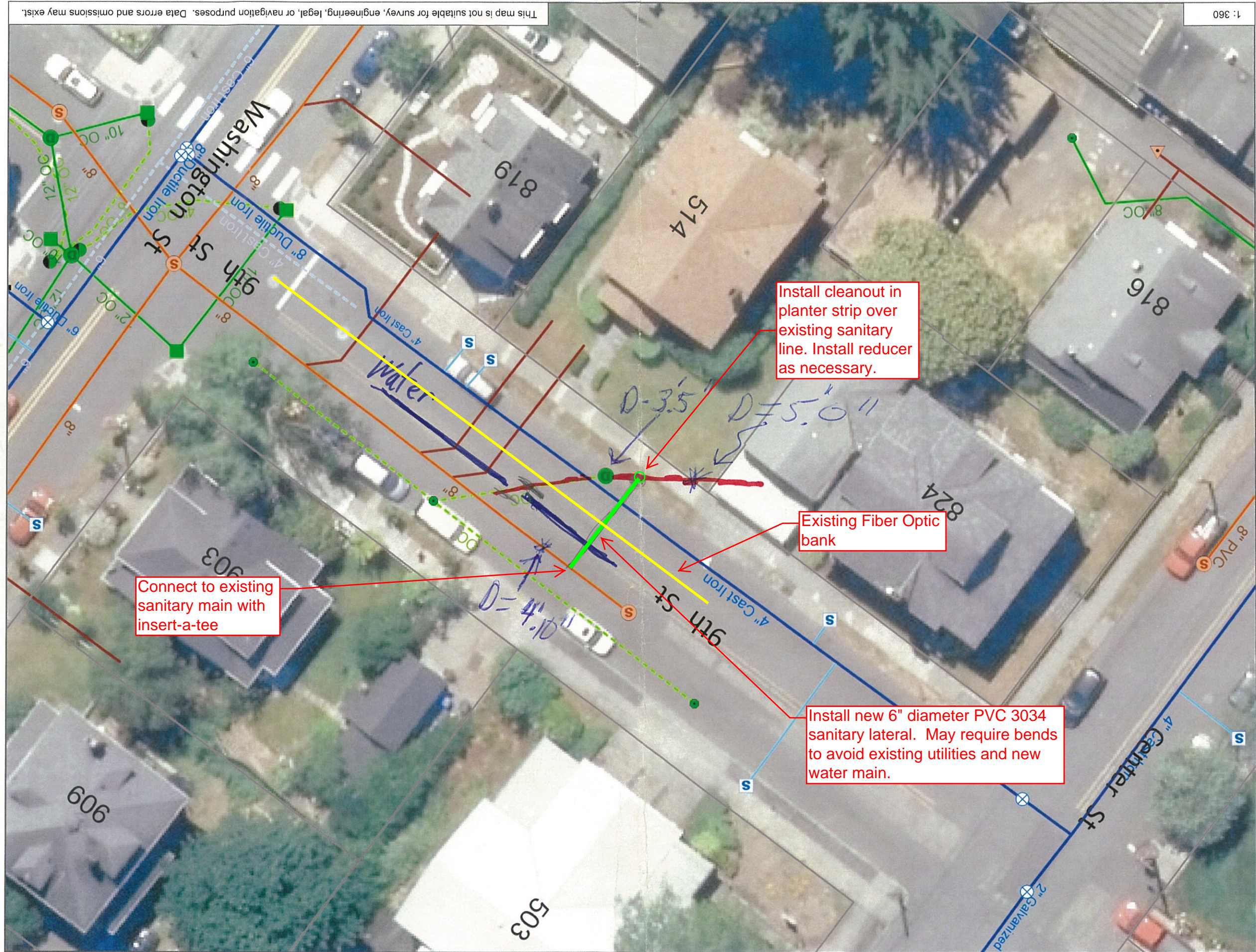

## Wes Wegner

---

**From:** Derek Bennett <trenchlinederek@gmail.com>  
**Sent:** Friday, February 08, 2019 11:28 AM  
**To:** Wes Wegner  
**Subject:** Pricings

Add 4" Valve to Fire Line = \$2,144

Sanitary Lateral T&M (7 hours crew, material, & Equip) = \$5,924

Traffic control Reduction on Molalla = \$250

Paving options:

3" = 35.60/SY

4" = 47.90/SY

Modification of bid items as proposed makes sense, we'll measure everything prior to billing.

The methodology for covering the rock/production slowdown works for me. It still adds up to 300CY additional.

Anything else?

**Derek Bennett**  
**Trench Line Excavation, Inc.**

*Estimator / Project Manager*

Ph: 541-752-0481

Fax: 541-752-5523

**Cell: 541-609-6111**

[trenchlinederek@gmail.com](mailto:trenchlinederek@gmail.com)

## Wes Wegner

---

**From:** Derek Bennett <trenchlinederek@gmail.com>  
**Sent:** Tuesday, January 29, 2019 1:09 PM  
**To:** Wes Wegner  
**Cc:** jburrell@orcity.org; "Chris (Pipe Ninja) Stoddard"  
**Subject:** RE: Broken Sewer Lateral

Wes,  
Yes, Chris and I just spoke about this lateral. I agree that it'd be easiest to do this on a T&M basis, given the amount of unknown details.

Also, we spoke about sheet C13, detail 4 – remove the existing tee and valves and replace with sleeves and a short spool of pipe. This would remove the valves permanently, and given the new cluster we're installing there'll be adequate isolation points, with two potential failure points removed.

We could do that work, all inclusive (labor, equip, materials) for \$1,050. Please let us know if the city would like us to do that while we're there.

Thank you,  
-Derek

---

**From:** Wes Wegner [<mailto:wes.wegner@walliseng.net>]  
**Sent:** Tuesday, January 29, 2019 12:49 PM  
**To:** Derek Bennett ([trenchlinederek@gmail.com](mailto:trenchlinederek@gmail.com)) <[trenchlinederek@gmail.com](mailto:trenchlinederek@gmail.com)>  
**Cc:** [jburrell@orcity.org](mailto:jburrell@orcity.org); 'Chris (Pipe Ninja) Stoddard' ([trenchlinechris@gmail.com](mailto:trenchlinechris@gmail.com)) <[trenchlinechris@gmail.com](mailto:trenchlinechris@gmail.com)>  
**Subject:** Broken Sewer Lateral

Derek,

Chris may have already brought you up to speed on this, but there is a broken sanitary lateral on 9<sup>th</sup> that needs to be reconstructed. The existing sanitary lateral was broken and capped when we trenched through for the waterline. At the time, the City believed this line was an old abandoned storm line. With the information we know now, this isn't the case and we need to reconnect this service lateral.

Chris thought this would be something Trenchline could help the City out with considering your crews are already out there. I've attached a rough sketch of the proposed sanitary lateral. We will need to install a cleanout with bend and reducer in the planter strip on the old service lateral, construct the new lateral to the existing main and tie in. City crews were able to identify approximate depths of the existing lines, but we will likely need to pothole each crossing to identify with certainty how to fit the new lateral in. At this point, I don't know if the sanitary lateral will go above or below the new waterline or the fiber optic. The potholing should give us this information.

Is this something you are comfortable giving a price for or would Force Account (T&M) be more appropriate given the unknowns? Let us know your thoughts.

**Wes Wegner**  
Senior Engineer  
Direct: 360-852-9160  
Office: 360-695-7041