

**DESIGN ADVICE - February 27<sup>th</sup>, 2018**

**Location: 4<sup>th</sup> Avenue and Hedges St (Canemah)**



### **Proposal**

Single Family home with attached garage. Bungalow design. See attached drawings.

### **Previous Approvals**

HR 05-04 Approval of driveway locations on Hedges St right of way

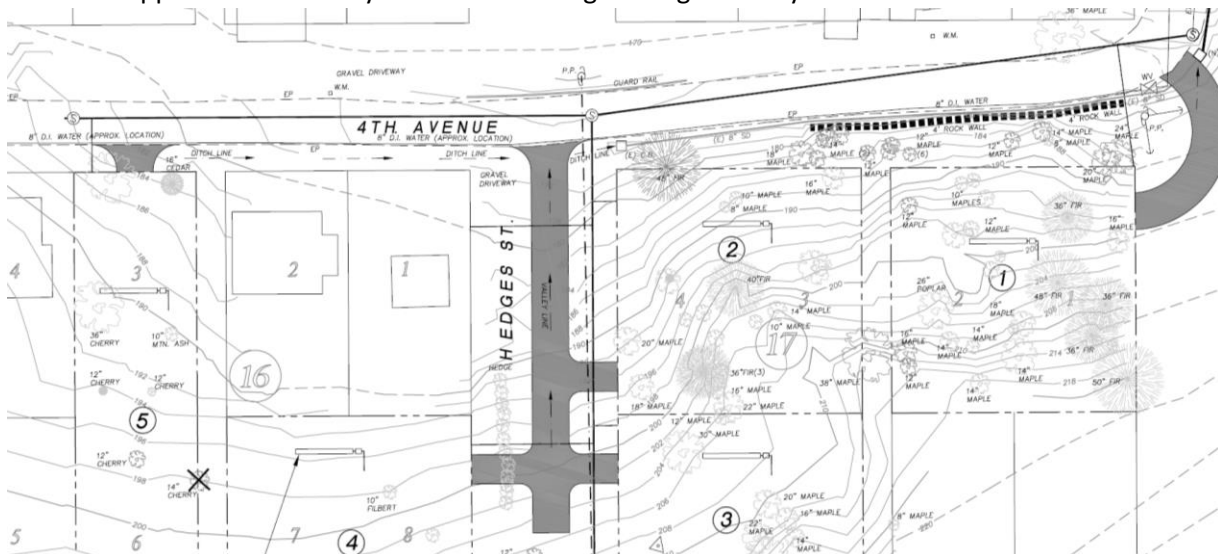

**Questions from Applicant**

1. In general, are we accomplishing the "Bungalow" style
2. Does the entry door on North porch qualify as is for entry?
3. Do we need some sort of connection to the porch with entry door to grade with steps?
4. Can we use concrete retaining wall along the driveway at South property line as space will be limited?
5. IS it possible to get 5' variance on West setback along Hedges to help with grading challenges?